

STATE OF CALIFORNIA

Caltrans

DEPARTMENT OF TRANSPORTATION

CONSULTANT FUNCTIONAL SUPERVISOR

DESIGNED BY

CHECKED BY

REVISOR

DATE

REVISOR

DATE

REVISOR

DATE

NOTES:

1. BASIS OF BEARINGS AND COORDINATES:  
HORIZONTAL CONTROL DATUM  
THE HORIZONTAL CONTROL DATUM FOR THIS SURVEY IS BASED ON THE CALIFORNIA COORDINATE SYSTEM OF 1983 (CCS83), ZONE VI, NAD83 (1991.35 EPOCH) AS DETERMINED LOCALLY BY A LINE BETWEEN ORANGE COUNTY SURVEYOR HORIZONTAL CONTROL STATIONS "1468" AND "4541" BEING NORTH 80°30'40" EAST AS DERIVED FROM COORDINATES AVAILABLE FROM THE ORANGE COUNTY SURVEYOR'S OFFICE.  
1468 2159895.50 6145103.44  
FD BOAT SPIKE WITH ALUM WASHER 'LS 5557'  
  
4541 2161462.82 6154480.52  
FD 2" IP WITH NAIL AND TAG 'LS 4965', DN 0.2'
2. BASIS OF ELEVATIONS:  
VERTICAL DATUM AND BENCHMARKS  
ELEVATIONS SHOWN ARE BASED ON THE ORANGE COUNTY VERTICAL CONTROL DATUM (OCS 1995 ADJUSTMENT) WHICH WAS DETERMINED AT BENCHMARK NO. 3EE-28-99, HAVING AN ELEVATION OF 727.406 FEET, BEING A 3 3/4" OCS ALUMINUM BENCHMARK DISK STAMPED "3EE-28-99" SET IN THE TOP OF A 6" BY 6" CONCRETE POST ALONG THE NORTHERLY SIDE OF OSO PARKWAY AND ON THE EASTERLY SIDE OF STATE HIGHWAY 241, 15' WESTERLY OF A RURAL ACCESS ROAD, 80' NORTHERLY OF THE CENTERLINE OF OSO PARKWAY AND 225' EASTERLY OF THE NORTHBOUND ON-RAMP TO STATE HIGHWAY 241.
3. CONTROL VALUES  
HORIZONTAL AND VERTICAL CONTROL VALUES SHOWN ARE IN US SURVEY FEET.  
  
SUBSEQUENT GPS AND CONVENTIONAL SURVEYS ESTABLISHED THE CONTROL STATIONS SHOWN HEREON.

LEGEND:

△  
XXXX CONTROL STATION

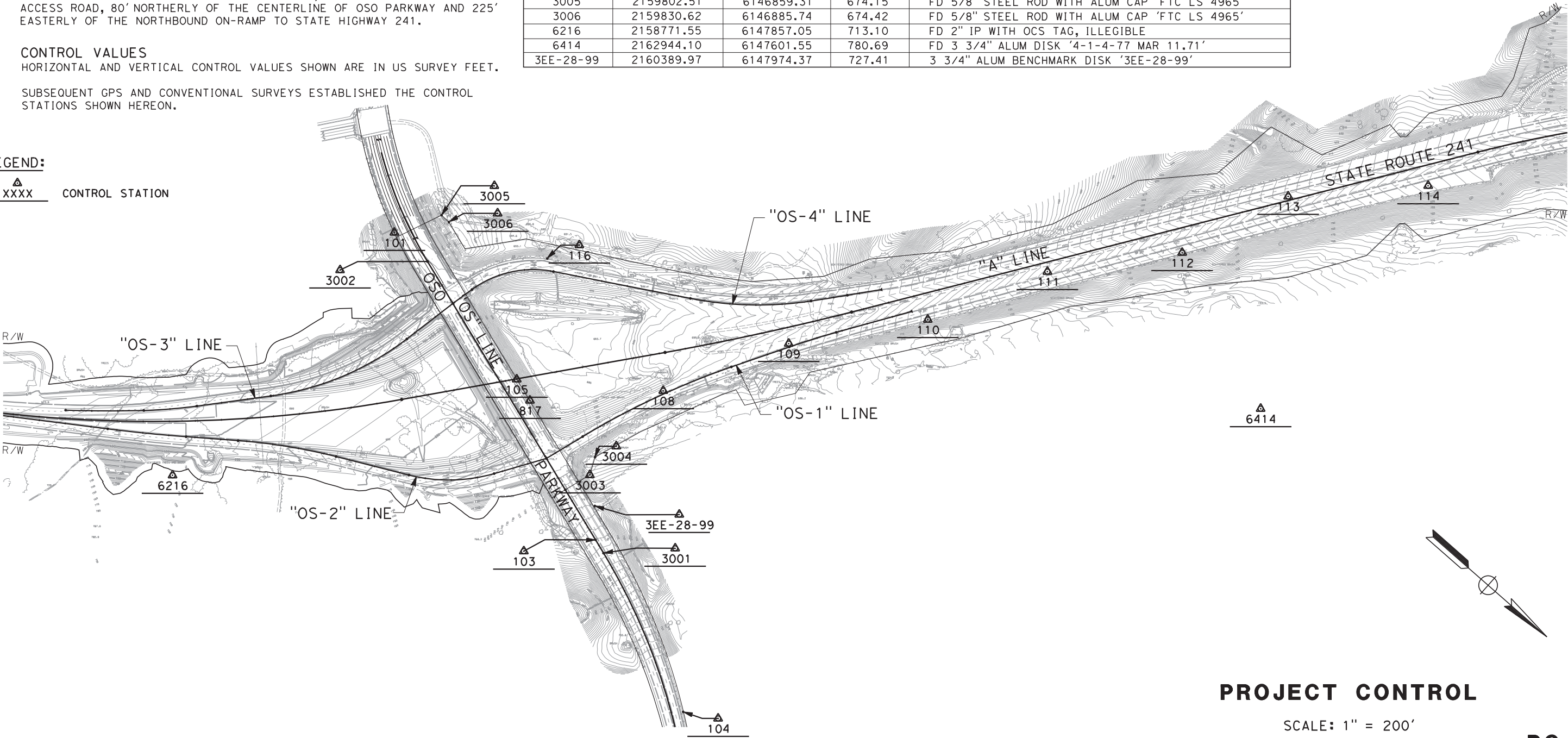

PROJECT CONTROL

SCALE: 1" = 200'

PC-1

CONTROL FOR DESIGN AND CONSTRUCTION

POINT ID	NORTHING	EASTING	ELEVATION	DESCRIPTION
101	2159621.36	6146925.95	711.15	SET 1" IP WITH MAG NAIL AND WASHER 'TOWILL CONTROL'
103	2160393.29	6148104.58	732.44	SET GEAR SPIKE WITH WASHER 'TOWILL CONTROL'
104	2160729.06	6148764.27	780.67	SET 1" IP WITH MAG NAIL AND WASHER 'TOWILL CONTROL'
105	2160090.78	6147488.97	713.79	SET MAG NAIL IN EXP JOINT, FLUSH
108	2160652.71	6147532.72	705.21	SET 1" IP WITH PLUG 'TOWILL CONTROL'
109	2161134.05	6147351.77	712.79	SET MAG NAIL AND WASHER 'TOWILL CONTROL'
110	2161667.49	6147259.76	734.94	SET MAG NAIL AND WASHER 'TOWILL CONTROL'
111	2162126.27	6147076.00	754.82	SET 1" IP WITH PLUG 'TOWILL CONTROL'
112	2162643.07	6147003.10	777.52	SET MAG NAIL AND WASHER 'TOWILL CONTROL'
113	2163049.91	6146787.38	798.00	SET 1" IP WITH PLUG 'TOWILL CONTROL'
114	2163586.75	6146746.78	817.67	SET MAG NAIL AND WASHER 'TOWILL CONTROL'
116	2160207.77	6147025.81	706.12	SET 1" IP WITH PLUG 'TOWILL CONTROL'
817	2160141.52	6147570.04	713.92	FD 3 1/4" BRASS DISK CAST RBF '817 1996 LS 4965'
3001	2160423.94	6148155.67	734.02	FD 2" BRASS DISK 'LS 4965', DN 1.2'
3002	2159748.56	6147036.95	708.09	FD 2" BRASS DISK 'LS 4965', DN 1.4'
3003	2160371.36	6147855.52	701.94	FD 2" ALUM CAP ON STEEL PIN 'FTC LS 4965'
3004	2160391.55	6147787.36	695.04	FD 2" ALUM CAP ON STEEL PIN 'FTC LS 4965'
3005	2159802.51	6146859.31	674.15	FD 5/8" STEEL ROD WITH ALUM CAP 'FTC LS 4965'
3006	2159830.62	6146885.74	674.42	FD 5/8" STEEL ROD WITH ALUM CAP 'FTC LS 4965'
6216	2158771.55	6147857.05	713.10	FD 2" IP WITH OCS TAG, ILLEGIBLE
6414	2162944.10	6147601.55	780.69	FD 3 3/4" ALUM DISK '4-1-4-77 MAR 11.71'
3EE-28-99	2160389.97	6147974.37	727.41	3 3/4" ALUM BENCHMARK DISK '3EE-28-99'

Dist

COUNTY

ROUTE

POST MILES TOTAL PROJECT

SHEET No.

TOTAL SHEETS

12

Oran

241

\*13.1/16.7

15

295

06/30/17

PROFESSIONAL LAND SURVEYOR DATE

10/02/2017

PLANS APPROVAL DATE

THE STATE OF CALIFORNIA OR ITS OFFICERS OR AGENTS SHALL NOT BE RESPONSIBLE FOR THE ACCURACY OR COMPLETENESS OF SCANNED COPIES OF THIS PLAN SHEET.

TOWILL, INC

888 W. TOWN AND COUNTRY Rd

ORANGE, CA 92868

FOOTHILL/EASTERN TRANSPORTATION CORRIDOR AGENCY

125 PACIFICA, SUITE 100

IRVINE, CA 92618

PROFESSIONAL LAND SURVEYOR

LISA M. HENSTRIDGE

No. 7177

STATE OF CALIFORNIA

Dist	COUNTY	ROUTE	POST MILES TOTAL PROJECT	SHEET TOTAL SHEETS
12	Ora	241	*13.1/16.7	130 295

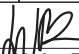

REGISTERED CIVIL ENGINEER

06/30/2017

DATE

10/02/2017

PLANS APPROVAL DATE



*THE STATE OF CALIFORNIA OR ITS OFFICERS  
OR AGENTS SHALL NOT BE RESPONSIBLE FOR  
THE ACCURACY OR COMPLETENESS OF SCANNED  
COPIES OF THIS PLAN SHEET.*



<p>T.Y. LIN INTERNATIONAL 20 PACIFICA, SUITE 350 IRVINE, CA 92618</p>	<p>FOOTHILL/EASTERN TRANSPORTATION CORRIDOR AGENCY 125 PACIFICA, SUITE 100 IRVINE, CA 92618</p>
---	---

NOTE:  
ALL CONFLICTING SIGNING, STRIPING AND PAVEMENT MARKINGS  
SHALL BE REMOVED PRIOR TO BEGINNING WORK ON EACH STAGE.

### STAGE 1A:

- ① CONSTRUCT TEMPORARY WIDENING ON SOUTH SIDE OF OSO PARKWAY
- ② CONSTRUCT PORTION OF SIDEWALK ON SOUTH SIDE OF OSO PARKWAY
- ③ REMOVE INLET ON OSO PARKWAY, SEE DRAINAGE SHEETS

LEGEND:

-  CONSTRUCTION THIS STAGE  
 OVERNIGHT/ WEEKEND CONSTRUCTION THIS STAGE  
 DIRECTION OF TRAFFIC

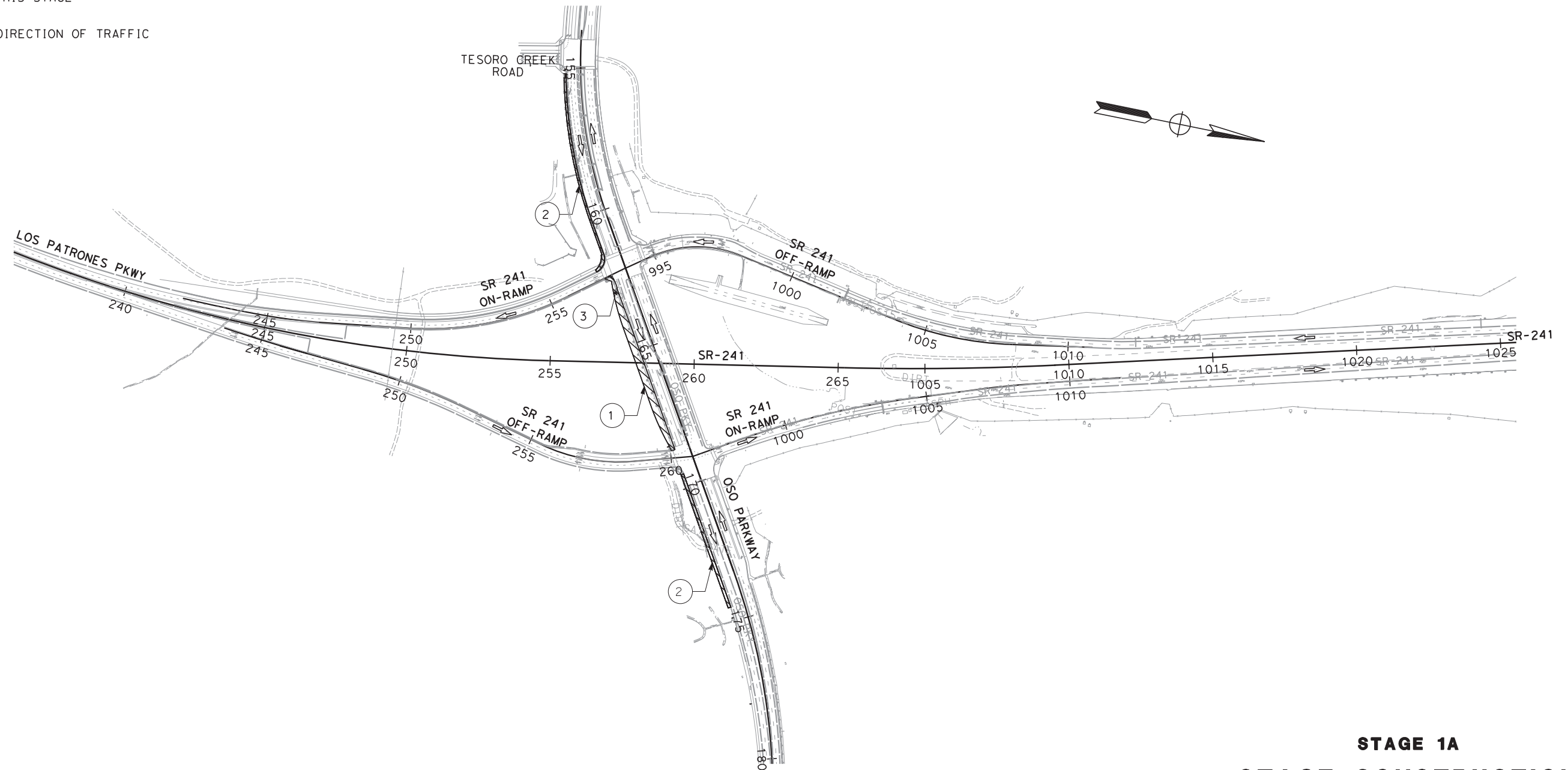

# STAGE 1A



## STAGE CONSTRUCTION

SCALE: 1" = 200'

APPROVED FOR STAGE CONSTRUCTION WORK ONLY

SC-1



Dist	COUNTY	ROUTE	POST MILES TOTAL PROJECT	SHEET No.	TOTAL SHEETS
12	Ora	241	*13.1/16.7	131	295
 REGISTERED CIVIL ENGINEER			06/30/2017		
10/02/2017			DATE		
PLANS APPROVAL DATE					
<i>THE STATE OF CALIFORNIA OR ITS OFFICERS OR AGENTS SHALL NOT BE RESPONSIBLE FOR THE ACCURACY OR COMPLETENESS OF SCANNED COPIES OF THIS PLAN SHEET.</i>					
T.Y. LIN INTERNATIONAL 20 PACIFICA, SUITE 350 IRVINE, CA 92618			FOOTHILL/EASTERN TRANSPORTATION CORRIDOR AGENCY 125 PACIFICA, SUITE 100 IRVINE, CA 92618		

NOTE:

ALL CONFLICTING SIGNING, STRIPING AND PAVEMENT MARKINGS SHALL BE REMOVED PRIOR TO BEGINNING WORK ON EACH STAGE.

STAGE 1B:

- ① SHIFT OSO PARKWAY ONTO TEMPORARY WIDENING
- ② SMWD TO CONSTRUCT TEMPORARY WATER LINE RELOCATIONS, SEE UTILITY SHEETS
- ③ CONSTRUCT NORTH SIDE OF OSO PARKWAY OVERCROSSING
- ④ UTILITES RELOCATED TO OSO PKWY OC BY OTHERS: SMWD, COX, SDGE, AND SCG
- ⑤ CONSTRUCT PORTION OF SR-241/ LOS PATRONES PARKWAY CONNECTION
- ⑥ CONSTRUCT PORTION OF SB SR-241 OFF RAMP
- ⑦ CONSTRUCT NB SR-241 ON RAMP
- ⑧ CONSTRUCT PORTION OF DRAINAGE INLETS ON SR-241, SEE DRAINAGE SHEETS
- ⑨ CONSTRUCT TEMPORARY SIGNAL, SEE ELECTRICAL SHEETS

### TRAFFIC HANDLING STAGE 1B:

- A. MAINTAIN TWO LANES OF TRAFFIC IN EACH DIRECTION ON OSO PARKWAY
- B. MAINTAIN TWO LANES OF TRAFFIC ON SB SR-241 AND ACCESS TO SB OFF RAMP, INCLUDING TURN LANES
- C. MAINTAIN TWO LANES OF TRAFFIC ON NB SR-241 AND ACCESS TO NB ON RAMP
- D. MAINTAIN ACCESS TO NB AND SB LOS PATRONES PARKWAY, INCLUDING TURN LANES
- E. IMPLEMENT PEDESTRIAN DETOUR (SEE TRAFFIC HANDLING SHEETS)

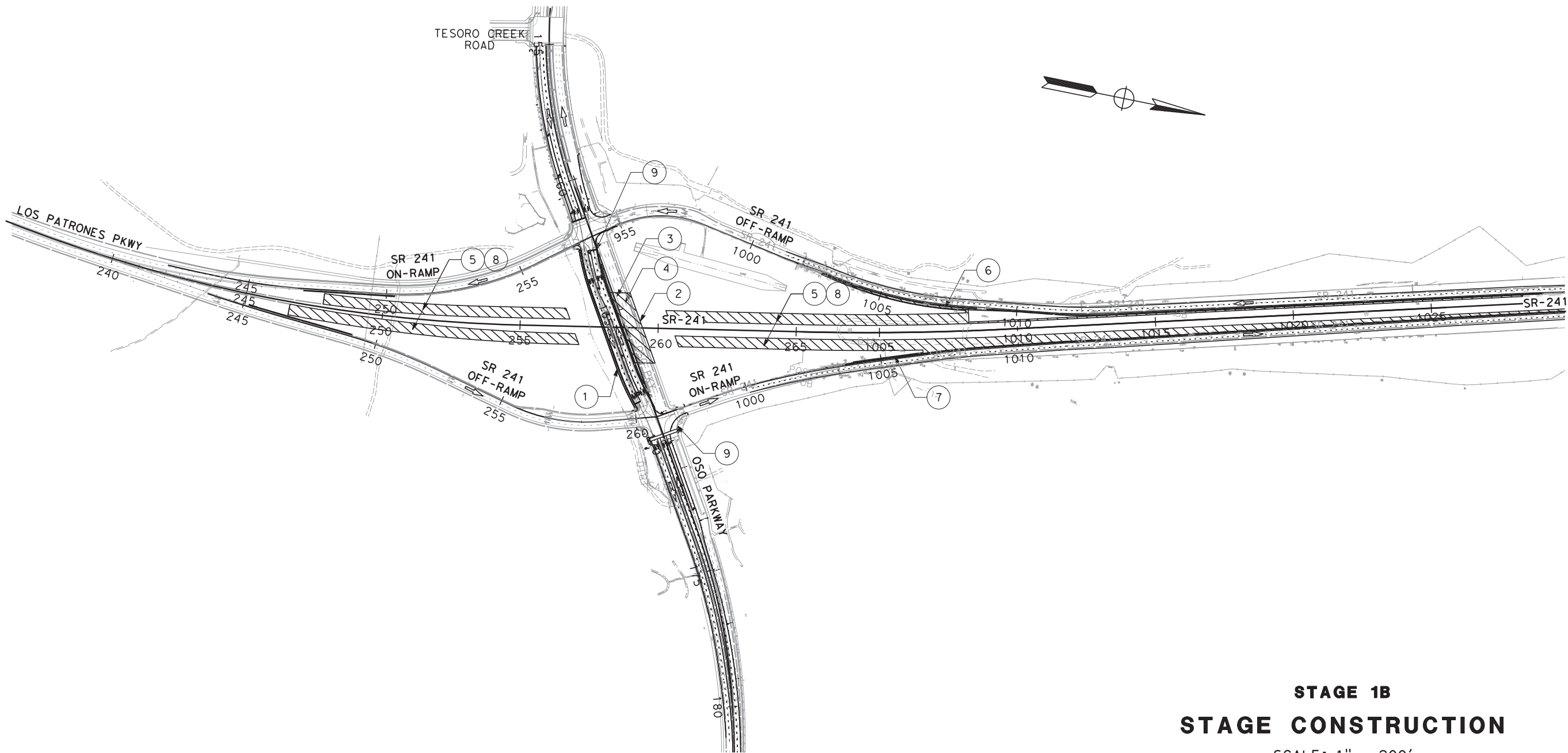



# STAGE 1B

## STAGE CONSTRUCTION

SCALE: 1" = 200'

APPROVED FOR STAGE CONSTRUCTION WORK ONLY

**SC-2**

Dist	COUNTY	ROUTE	POST MILES TOTAL PROJECT	SHEET TOTAL SHEETS
12	Ora	241	*13.1/16.7	132 295
 REGISTERED CIVIL ENGINEER			06/30/2017 DATE	
10/02/2017 PLANS APPROVAL DATE				
<i>THE STATE OF CALIFORNIA OR ITS OFFICERS OR AGENTS SHALL NOT BE RESPONSIBLE FOR THE ACCURACY OR COMPLETENESS OF SCANNED COPIES OF THIS PLAN SHEET.</i>				
T.Y. LIN INTERNATIONAL 20 PACIFICA, SUITE 350 IRVINE, CA 92618			FOOTHILL/EASTERN TRANSPORTATION CORRIDOR AGENCY 125 PACIFICA, SUITE 100 IRVINE, CA 92618	

NOTE:

ALL CONFLICTING SIGNING, STRIPING AND PAVEMENT MARKINGS SHALL BE REMOVED PRIOR TO BEGINNING WORK ON EACH STAGE.

### STAGE 2:

- ① SHIFT OSO PARKWAY ONTO NORTH SIDE OF OVERCROSSING
- ② CONSTRUCT REMAINDER OF SR-241
- ③ CONSTRUCT REMAINDER OF DRAINAGE INLETS ON SR-241, SEE DRAINAGE SHEETS
- ④ INSTALL OVERHEAD SIGN STRUCTURES AND OVERHEAD SIGN PANELS, SEE SIGNING SHEETS
- ⑤ CONSTRUCT TEMPORARY SIGNAL, SEE ELECTRICAL SHEETS

### TRAFFIC HANDLING STAGE 2:

- A. MAINTAIN TWO LANES OF TRAFFIC IN EACH DIRECTION ON OSO PARKWAY
- B. MAINTAIN TWO LANES OF TRAFFIC ON SB SR-241 AND ACCESS TO SB OFF RAMP, INCLUDING TURN LANES
- C. MAINTAIN TWO LANES OF TRAFFIC ON NB SR-241 AND ACCESS TO NB ON RAMP
- D. MAINTAIN ACCESS TO NB AND SB LOS PATRONES PARKWAY, INCLUDING TURN LANES
- E. DETOUR PEDESTRIANS TO NEW BRIDGE
- F. DETOUR MOTOR VEHICLES PER DETOUR PLANS DURING OVERHEAD SIGN INSTALLATION (SEE TRAFFIC HANDLING SHEETS)

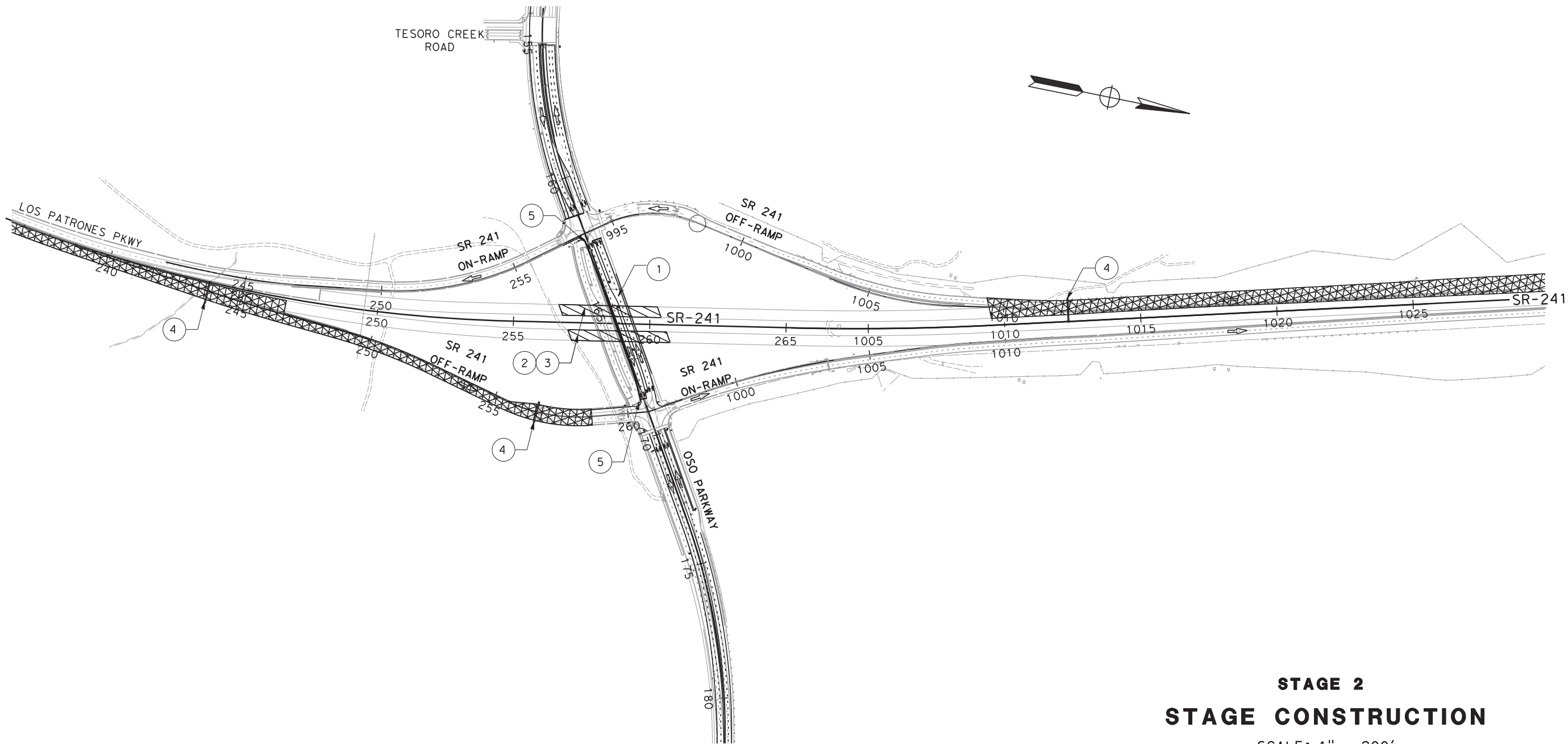

## STAGE 2

### STAGE CONSTRUCTION

SCALE: 1" = 200'

APPROVED FOR STAGE CONSTRUCTION WORK ONLY

**SC-3**





STATE OF CALIFORNIA - DEPARTMENT OF TRANSPORTATION

CONSULTANT FUNCTIONAL SUPERVISOR

KAREN CHAPMAN

CALCULATED-DESIGNED BY

CHECKED BY

ROBERTO RUVALCABA

JEFFREY BURDICK

REVISED BY

DATE REVISED

NOTES:  
1. FOR ACCURATE RIGHT OF WAY DATA, CONTACT  
RIGHT OF WAY ENGINEERING AT THE DISTRICT OFFICE.

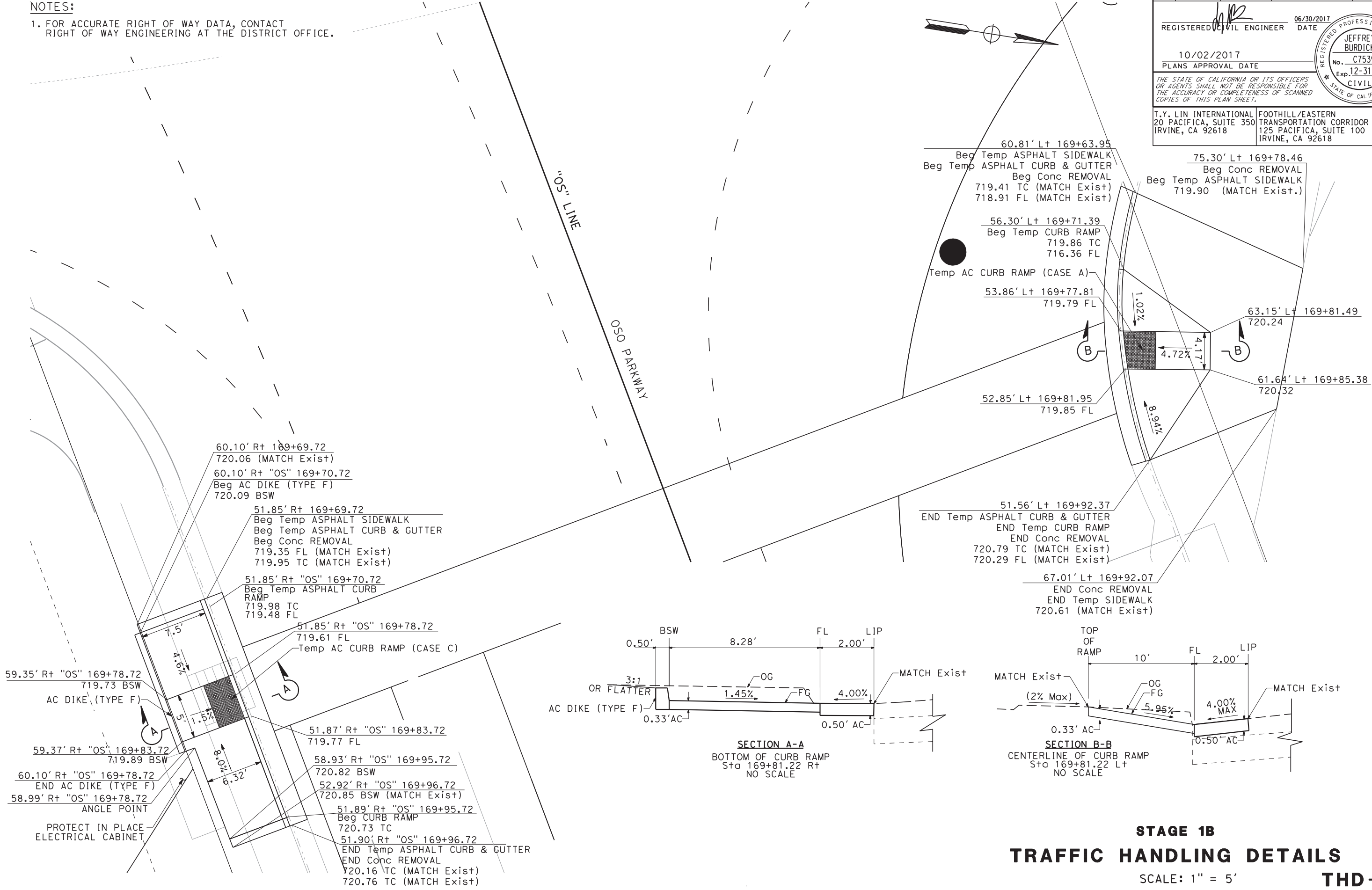

Dist	COUNTY	ROUTE	POST MILES TOTAL PROJECT	SHEET No.	TOTAL SHEETS
12	Oran	241	*13.1/16.7	163	295

REGISTERED CIVIL ENGINEER

DATE 06/30/2017

10/02/2017

PLANS APPROVAL DATE

THE STATE OF CALIFORNIA OR ITS OFFICERS  
OR AGENTS SHALL NOT BE RESPONSIBLE FOR  
THE ACCURACY OR COMPLETENESS OF SCANNED  
COPIES OF THIS PLAN SHEET.

T.Y. LIN INTERNATIONAL  
20 PACIFICA, SUITE 350  
IRVINE, CA 92618

FOOTHILL/EASTERN  
TRANSPORTATION CORRIDOR AGENCY  
125 PACIFICA, SUITE 100  
IRVINE, CA 92618

JEFFREY BURDICK

No. C75396

Exp. 12-31-17

CIVIL

STATE OF CALIFORNIA

STAGE 1B  
TRAFFIC HANDLING DETAILS  
THD-1  
SCALE: 1" = 5'

LAST REVISION DATE PLOTTED => 11/15/2017  
03-31-17 TIME PLOTTED => 9:20:20 AM

STATE OF CALIFORNIA - DEPARTMENT OF TRANSPORTATION

CONSULTANT FUNCTIONAL SUPERVISOR

KAREN CHAPMAN

CALCULATED-DESIGNED BY

CHECKED BY

ROBERTO RUVALCABA

JEFFREY BURDICK

REVISED BY

DATE REVISED

Dist	COUNTY	ROUTE	POST MILES TOTAL PROJECT	SHEET No.	TOTAL SHEETS
12	Oran	241	*13.1/16.7	164	295

REGISTERED CIVIL ENGINEER

DATE 06/30/2017

10/02/2017

PLANS APPROVAL DATE

JEFFREY BURDICK

No. C75396

Exp. 12-31-17

CIVIL

STATE OF CALIFORNIA

THE STATE OF CALIFORNIA OR ITS OFFICERS OR AGENTS SHALL NOT BE RESPONSIBLE FOR THE ACCURACY OR COMPLETENESS OF SCANNED COPIES OF THIS PLAN SHEET.

T.Y. LIN INTERNATIONAL  
20 PACIFICA, SUITE 350  
IRVINE, CA 92618

FOOTHILL/EASTERN TRANSPORTATION CORRIDOR AGENCY  
125 PACIFICA, SUITE 100  
IRVINE, CA 92618

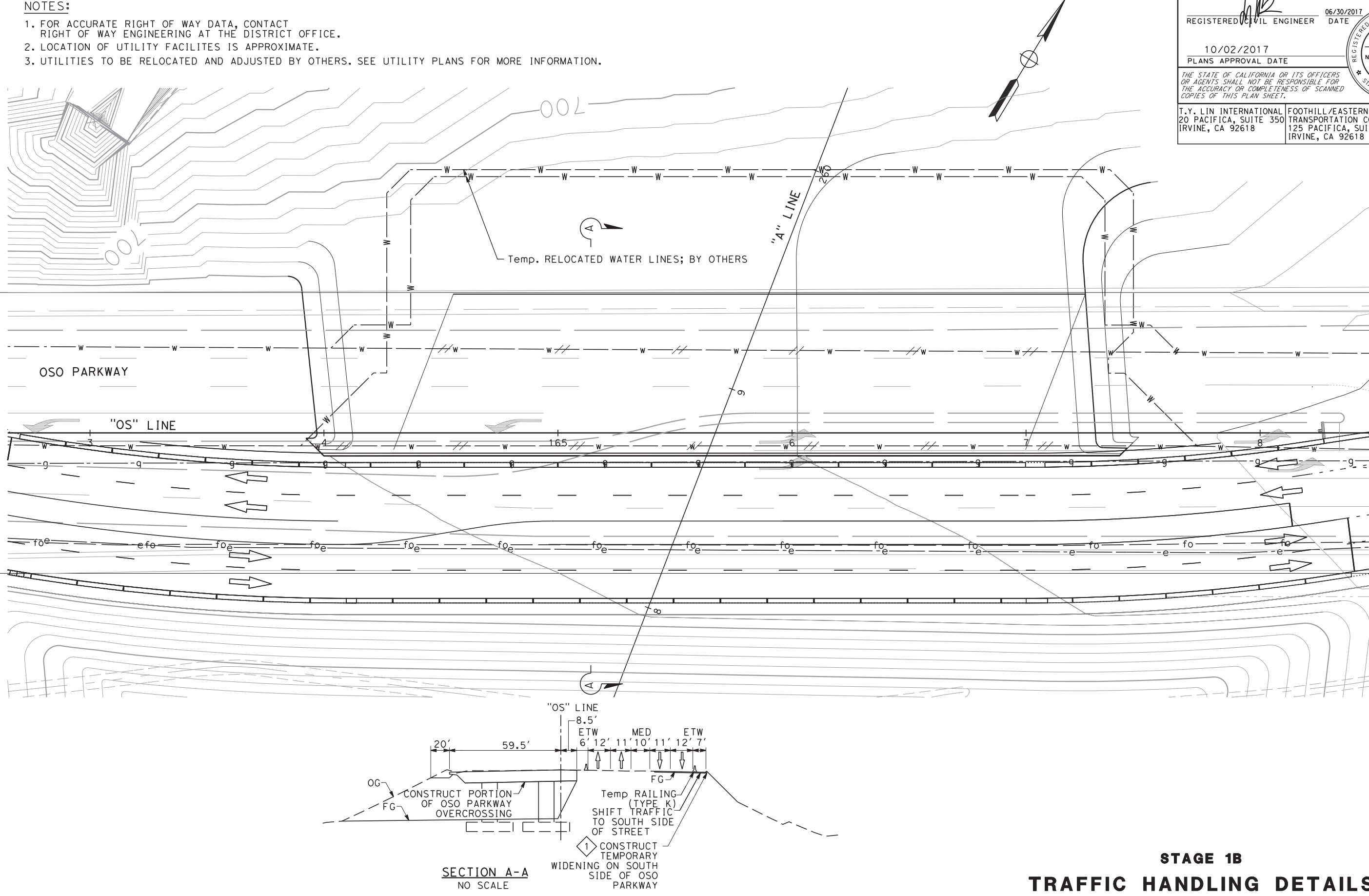

STAGE 1B

TRAFFIC HANDLING DETAILS

THD-2

SCALE: 1" = 20'





Dist	COUNTY	ROUTE	POST MILES TOTAL PROJECT	SHEET TOTAL SHEETS
12	Ora	241	*13.1/16.7	166 295



REGISTERED CIVIL ENGINEER

06/30/2017

DATE

10/02/2017

PLANS APPROVAL DATE



*THE STATE OF CALIFORNIA OR ITS OFFICERS  
OR AGENTS SHALL NOT BE RESPONSIBLE FOR  
THE ACCURACY OR COMPLETENESS OF SCANNED  
COPIES OF THIS PLAN SHEET.*

<p>T.Y. LIN INTERNATIONAL 20 PACIFICA, SUITE 350 IRVINE, CA 92618</p>	<p>FOOTHILL/EASTERN TRANSPORTATION CORRIDOR AGENCY 125 PACIFICA, SUITE 100 IRVINE, CA 92618</p>
---	---

NOTE:

ALL PEDESTRIAN DETOUR SIGNAGE IS SHOWN ON CORRESPONDING TRAFFIC HANDLING STAGE.

LEGEND:

 CONSTRUCTION THIS STAGE

➔ DIRECTION OF PEDESTRIANS

 OVERNIGHT/ WEEKEND CONSTRUCTION  
THIS STAGE

STAGE 1B PEDESTRIAN DIRECTION OF TRAVEL, FOR INFORMATION ONLY.

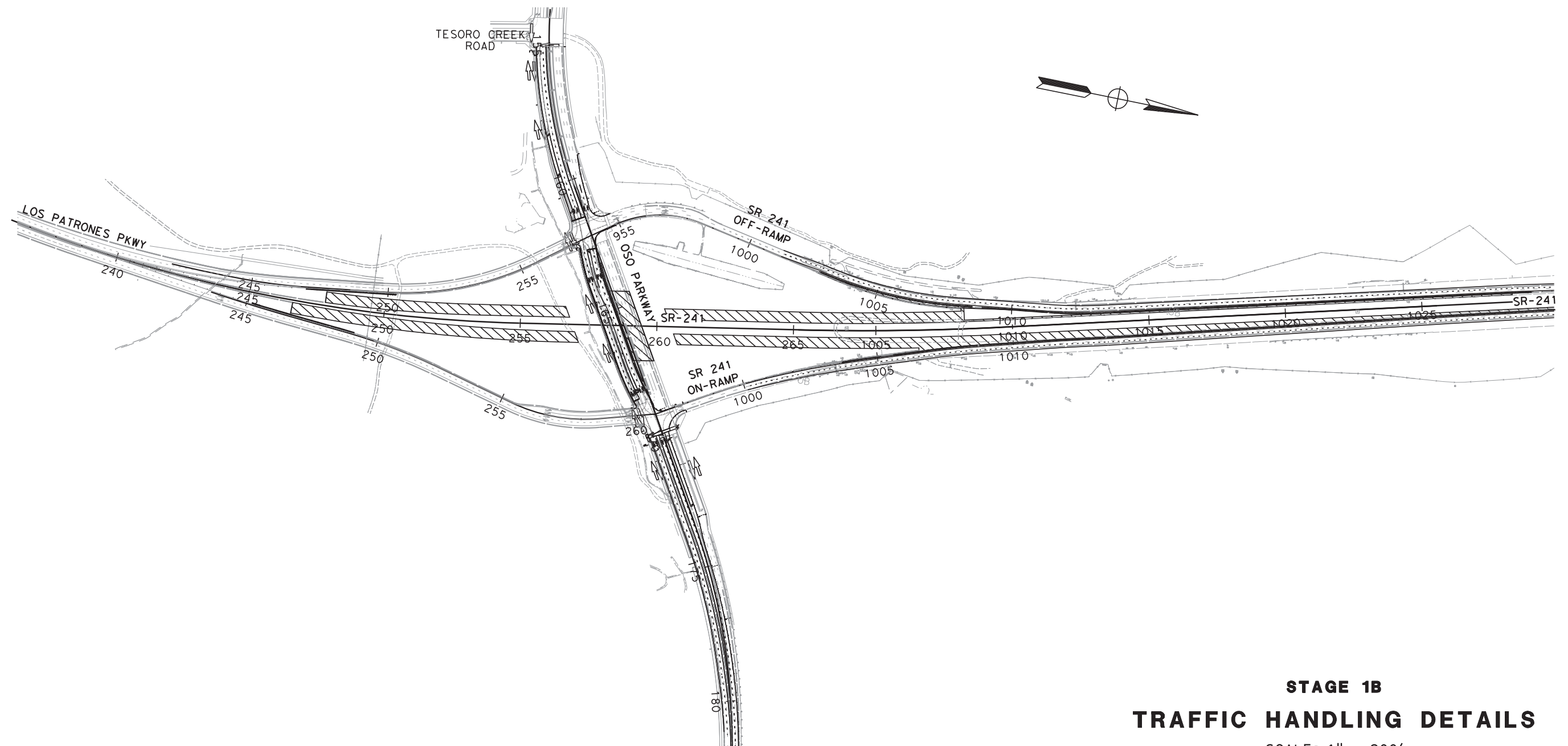

## STAGE 1B

## TRAFFIC HANDLING DETAILS

SCALE: 1" = 200'

**THD-4**

BORDER LAST REVISED 7/2/2010

```

USERNAME => srodriguez2
DGN FILE => 1200000402me004.dgn

```

RELATIVE BORDER SCALE  
IS IN INCHES

A horizontal number line with tick marks at 0, 0.5, 1, 1.5, and 2. The numbers 0, 1, and 2 are labeled above the line.

UNIT 2998

PROJECT NUMBER &amp; PHASE

12160001301

DATE PLOTTED => 10/4/2017  
TIME PLOTTED => 3:08:27 PM

Dist	COUNTY	ROUTE	POST MILES TOTAL PROJECT	SHEET TOTAL SHEETS
12	Ora	241	*13.1/16.7	167 295

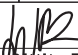

REGISTERED CIVIL ENGINEER

10/02/2017

PLANS APPROVAL DATE

06/30/2017

DATE

*THE STATE OF CALIFORNIA OR ITS OFFICERS  
OR AGENTS SHALL NOT BE RESPONSIBLE FOR  
THE ACCURACY OR COMPLETENESS OF SCANNED  
COPIES OF THIS PLAN SHEET.*



T.Y. LIN INTERNATIONAL 20 PACIFICA, SUITE 350 IRVINE, CA 92618	FOOTHILL/EASTERN TRANSPORTATION CORRIDOR AGENCY 125 PACIFICA, SUITE 100 IRVINE, CA 92618
--	---

NOTE:

ALL PEDESTRIAN DETOUR SIGNAGE IS SHOWN ON CORRESPONDING TRAFFIC HANDLING STAGE.

LEGEND:

 CONSTRUCTION THIS STAGE

⇒ DIRECTION OF PEDESTRIANS

 OVERNIGHT/ WEEKEND CONSTRUCTION  
THIS STAGE

STAGE 2 PEDESTRIAN DIRECTION OF TRAVEL, FOR INFORMATION ONLY.

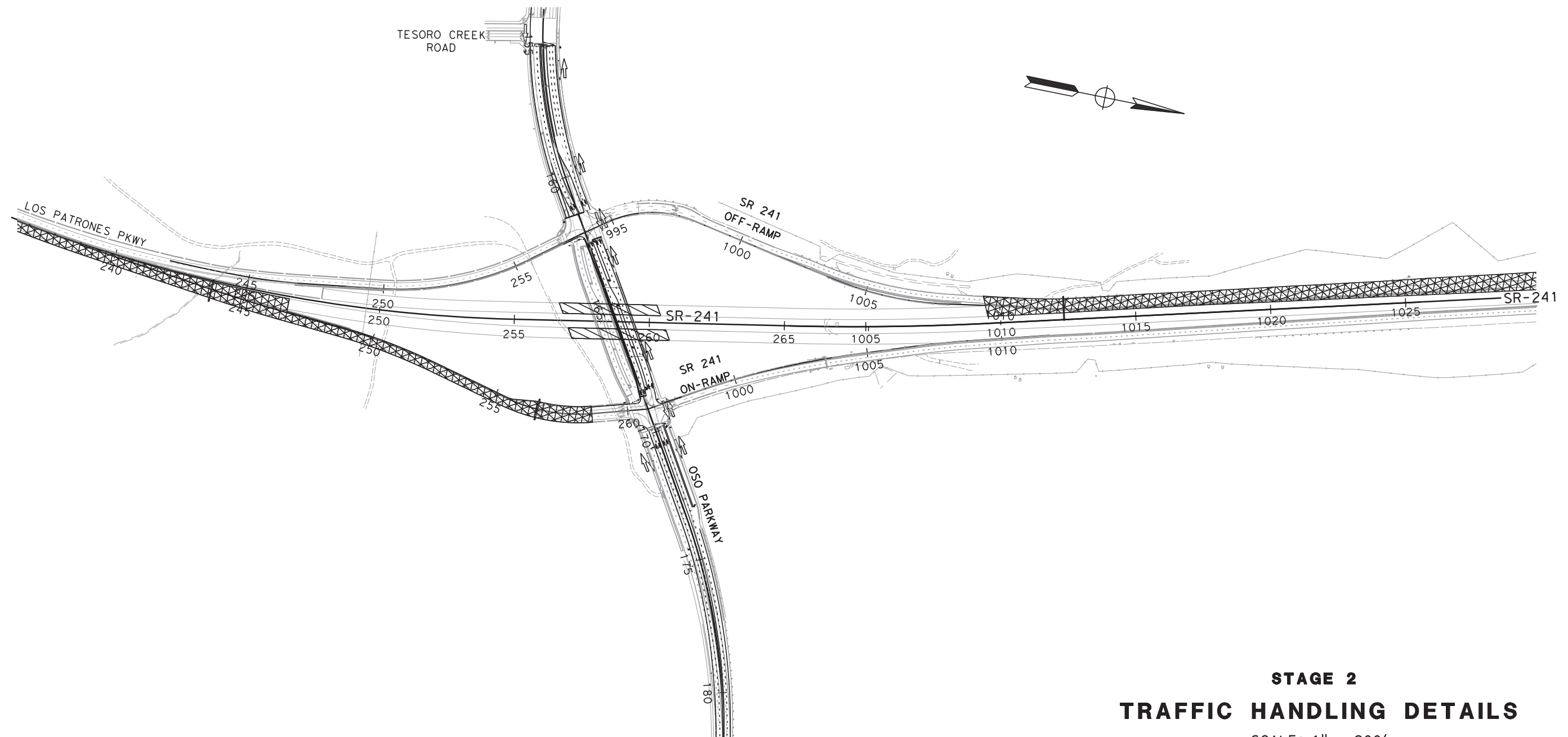

**STAGE 2**

**TRAFFIC HANDLING DETAILS**

SCALE: 1" = 200'

**THD-5**

STATE OF CALIFORNIA - DEPARTMENT OF TRANSPORTATION	CONSULTANT FUNCTIONAL SUPERVISOR	CALCULATED-DESIGNED BY	SHANNON JOHNSON	REVISED BY	
Caltrans®	KAREN CHAPMAN	CHECKED BY	JEFFREY BURDICK	DATE REVISED	

NOTE:  
ALL PEDESTRIAN DETOUR SIGNAGE IS SHOWN ON CORRESPONDING TRAFFIC HANDLING STAGE.

LEGEND:  
[Hatched Box] CONSTRUCTION THIS STAGE  
[Arrow] DIRECTION OF PEDESTRIANS

Dist	COUNTY	ROUTE	POST MILES TOTAL PROJECT	SHEET No.	TOTAL SHEETS
12	Ora	241	*13.1/16.7	168	295

REGISTERED CIVIL ENGINEER  
DATE 10/02/2017  
PLANS APPROVAL DATE

06/30/2017  
DATE

JEFFREY BURDICK  
No. C75396  
Exp. 12-31-17  
CIVIL  
STATE OF CALIFORNIA

THE STATE OF CALIFORNIA OR ITS OFFICERS OR AGENTS SHALL NOT BE RESPONSIBLE FOR THE ACCURACY OR COMPLETENESS OF SCANNED COPIES OF THIS PLAN SHEET.

T.Y. LIN INTERNATIONAL  
20 PACIFICA, SUITE 350  
IRVINE, CA 92618

FOOTHILL/EASTERN TRANSPORTATION CORRIDOR AGENCY  
125 PACIFICA, SUITE 100  
IRVINE, CA 92618

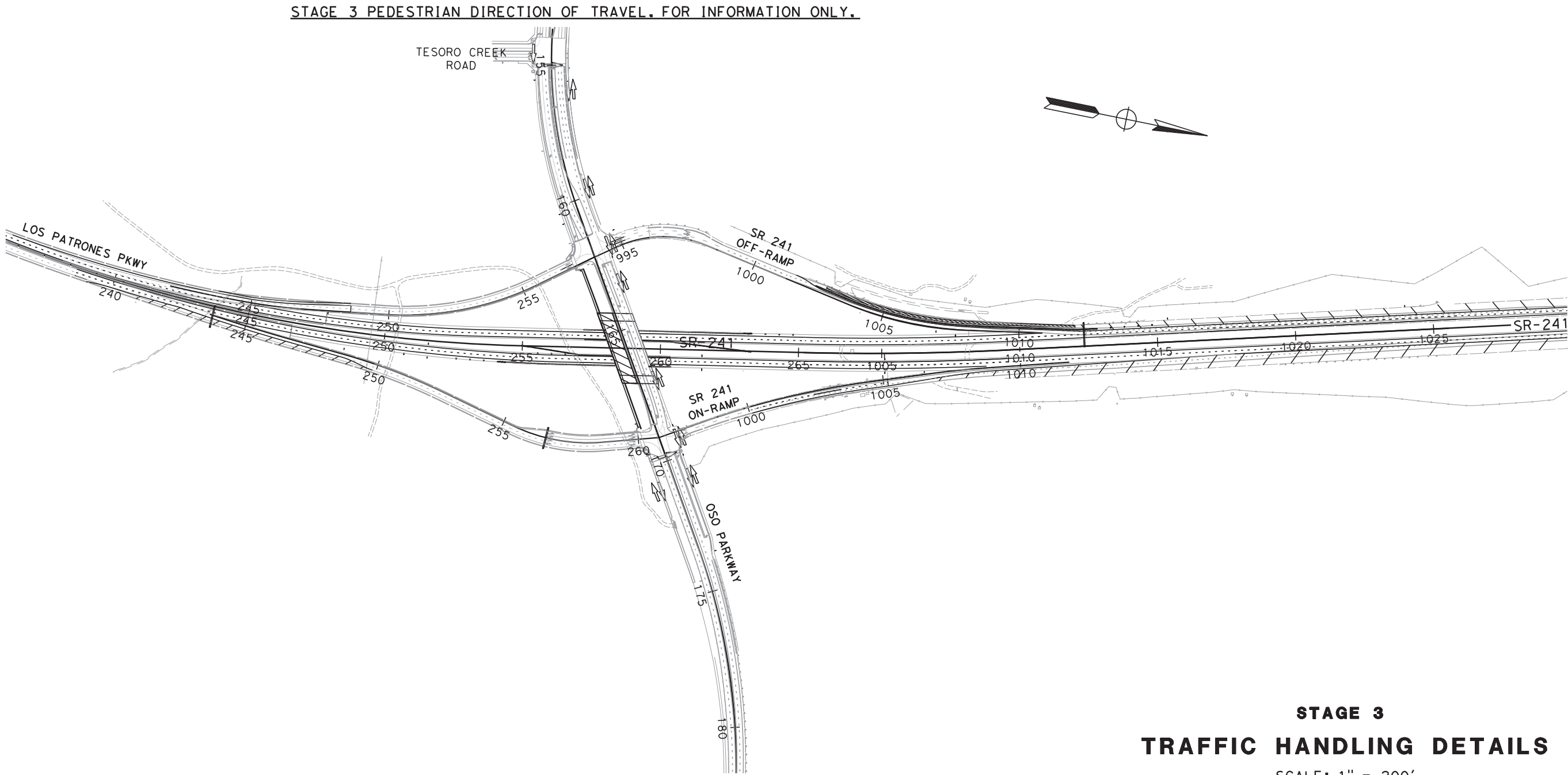

STAGE 3  
TRAFFIC HANDLING DETAILS  
SCALE: 1" = 200'  
THD-6



STATE OF CALIFORNIA - DEPARTMENT OF TRANSPORTATION	CONSULTANT FUNCTIONAL SUPERVISOR	KAREN CHAPMAN	CALCULATED-DESIGNED BY	CHECKED BY	SHANNON JOHNSON	JEFFREY BURDICK	REVISED BY	DATE REVISED



LEGEND:



NIGHT/ WEEKEND CLOSURE



DIRECTION OF TRAFFIC, SIGNED DETOUR ROUTE



PORTABLE MOUNTED SIGN- SINGLE POST



PORTABLE MOUNTED SIGN- DOUBLE POST



PORTABLE CHANGEABLE MESSAGE SIGN

GENERAL NOTES:

1. ENGINEER TO DETERMINE MESSAGE FOR PCMS





2. LOCATIONS OF PORTABLE MOUNTED SIGNS AND PCMS SHOWN ON DETOUR SHEETS ARE APPROXIMATE ONLY. EXACT LOCATIONS WILL BE DETERMINED BY THE ENGINEER.
3. 1000 FT SPACING BETWEEN SIGNS ON MAINLINE, UNLESS NOTED OTHERWISE.
4. REMOVE OR COVER ALL CONFLICTING EXISTING SIGNS AS DIRECTED BY THE ENGINEER.
5. FOR ADDITIONAL TRAFFIC HANDLING SIGNS AND DETAILS, SEE TRAFFIC HANDLING PLANS.

DETOUR PLAN 1:

SB SR-241 TO SB LOS PATRONES PARKWAY

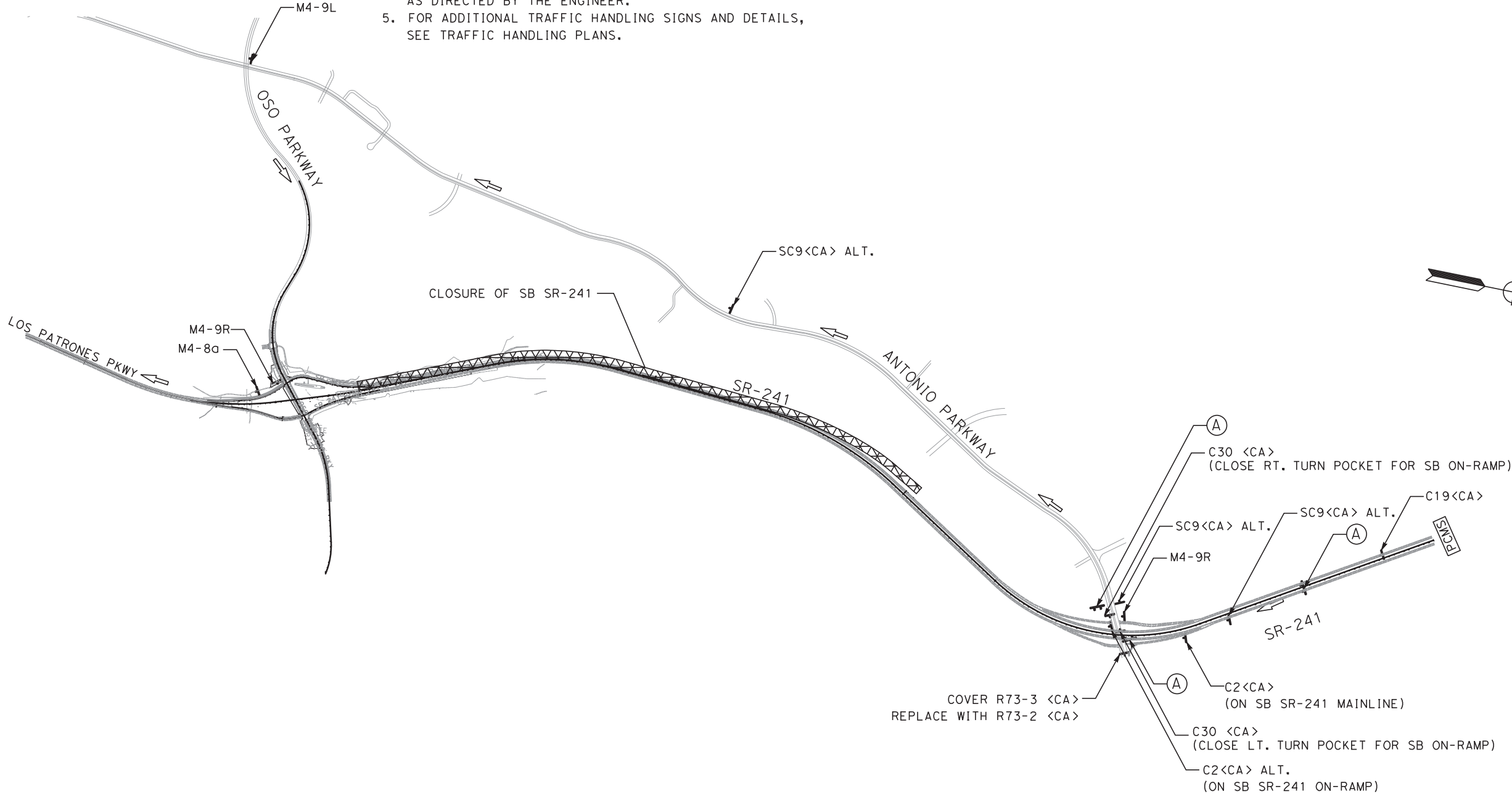
- SOUTH ON SR-241
- EXIT AT ANTONIO PARKWAY
- SOUTH ON ANTONIO PARKWAY
- EAST ON OSO PARKWAY
- SOUTH ON LOS PATRONES PARKWAY



DIST	COUNTY	ROUTE	POST MILES TOTAL PROJECT	SHEET NO.	TOTAL SHEETS
12	Oran	241	*13.1/16.7	169	295
 REGISTERED CIVIL ENGINEER			06/30/2017 DATE		
10/02/2017 PLANS APPROVAL DATE					
THE STATE OF CALIFORNIA OR ITS OFFICERS OR AGENTS SHALL NOT BE RESPONSIBLE FOR THE ACCURACY OR COMPLETENESS OF SCANNED COPIES OF THIS PLAN SHEET.					
T.Y. LIN INTERNATIONAL 20 PACIFICA, SUITE 350 IRVINE, CA 92618			FOOTHILL/EASTERN TRANSPORTATION CORRIDOR AGENCY 125 PACIFICA, SUITE 100 IRVINE, CA 92618		

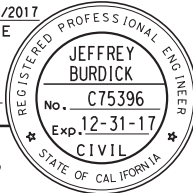

STAGE 2  
TRAFFIC HANDLING DETAILS

NO SCALE

THD-7

APPROVED FOR TRAFFIC HANDLING WORK ONLY

STATE OF CALIFORNIA - DEPARTMENT OF TRANSPORTATION	CONSULTANT FUNCTIONAL SUPERVISOR	KAREN CHAPMAN	CALCULATED-DESIGNED BY	CHECKED BY	SHANNON JOHNSON	JEFFREY BURDICK	REVISED BY	DATE	DATE	DATE

NOTES:

1. ENGINEER TO DETERMINE MESSAGE FOR PCMS

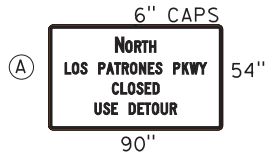



2. LOCATIONS OF PORTABLE MOUNTED SIGNS AND PCMS SHOWN ON DETOUR SHEETS ARE APPROXIMATE ONLY. EXACT LOCATIONS WILL BE DETERMINED BY THE ENGINEER.
3. 1000 FT SPACING BETWEEN SIGNS ON MAINLINE, UNLESS NOTED OTHERWISE.
4. REMOVE OR COVER ALL CONFLICTING EXISTING SIGNS AS DIRECTED BY THE ENGINEER.
5. FOR ADDITIONAL TRAFFIC HANDLING SIGNS AND DETAILS, SEE TRAFFIC HANDLING PLANS.

DETOUR PLAN 2:

NB LOS PATRONES PARKWAY TO NB SR-241

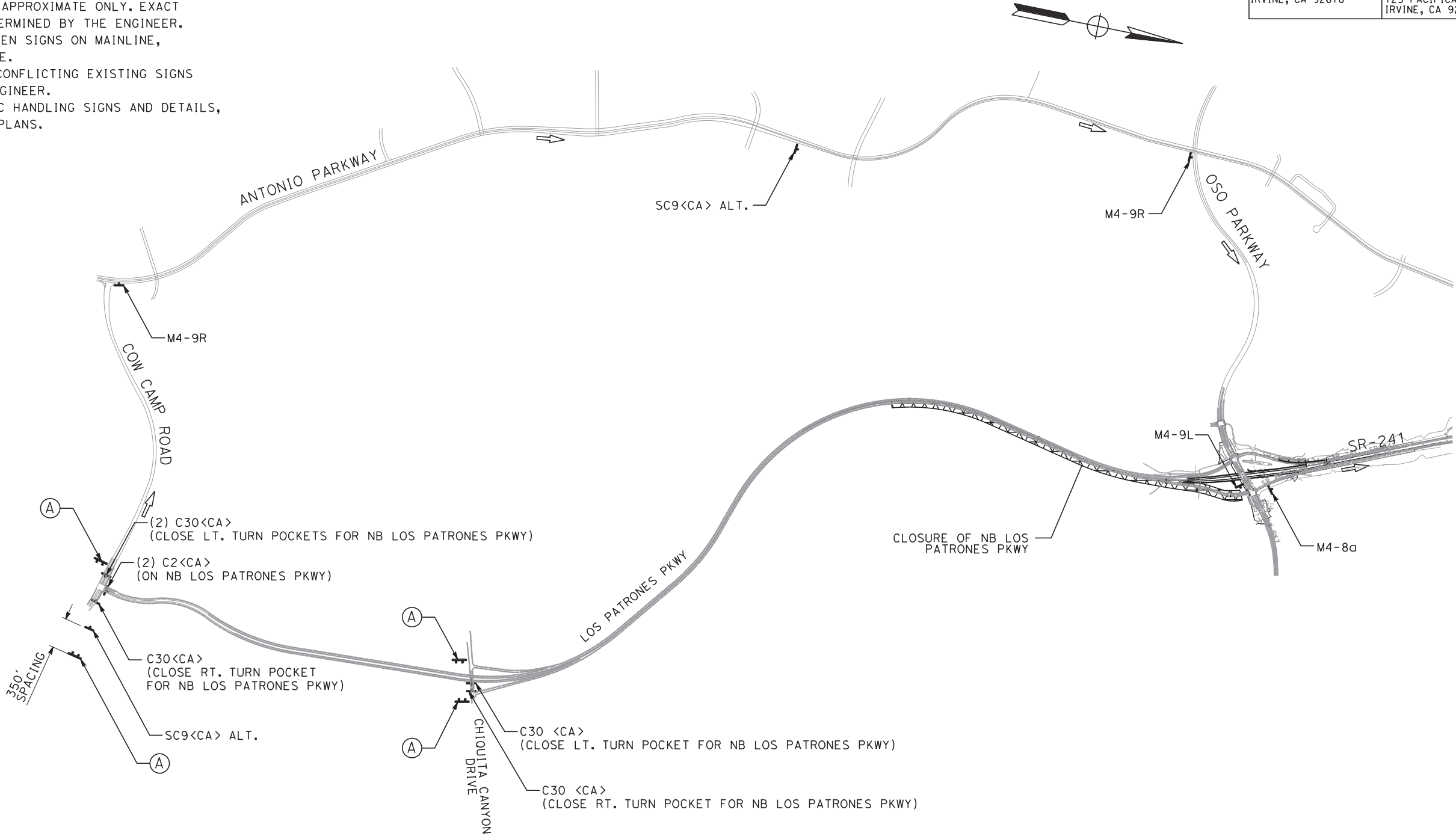
- WEST ON COW CAMP ROAD
- NORTH ON ANTONIO PARKWAY
- EAST ON OSO PARKWAY
- NORTH ON NB SR-241

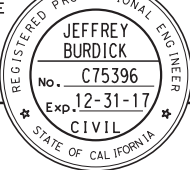

DIST	COUNTY	ROUTE	POST MILES TOTAL PROJECT	SHEET No.	TOTAL SHEETS
12	Orca	241	*13.1/16.7	170	295
 REGISTERED CIVIL ENGINEER			06/30/2017 DATE		
10/02/2017 PLANS APPROVAL DATE					
THE STATE OF CALIFORNIA OR ITS OFFICERS OR AGENTS SHALL NOT BE RESPONSIBLE FOR THE ACCURACY OR COMPLETENESS OF SCANNED COPIES OF THIS PLAN SHEET.					
T.Y. LIN INTERNATIONAL 20 PACIFICA, SUITE 350 IRVINE, CA 92618			FOOTHILL/EASTERN TRANSPORTATION CORRIDOR AGENCY 125 PACIFICA, SUITE 100 IRVINE, CA 92618		

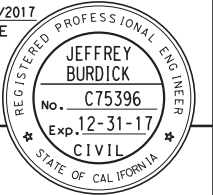

STAGE 2  
TRAFFIC HANDLING DETAILS

NO SCALE

THD-8

APPROVED FOR TRAFFIC HANDLING WORK ONLY



DIST	COUNTY	ROUTE	POST MILES TOTAL PROJECT	SHEET No	TOTAL SHEETS
12	Ora	241	13.1/16.7	260	295

06/30/17  
REGISTERED CIVIL ENGINEER DATE

04/11/17  
PLANS APPROVAL DATE

T. A. KIRILOV  
No. C67708  
Exp. 06/30/19  
CIVIL  
STATE OF CALIFORNIA

The State of California or its officers or agents shall not be responsible for the accuracy or completeness of scanned copies of this plan sheet.

FOOTHILL/EASTERN TRANSPORTATION CORRIDOR AGENCY  
125 PACIFICA, SUITE 100  
IRVINE, CA 92618

T.Y. LIN INTERNATIONAL  
20 PACIFICA, SUITE 350  
IRVINE, CA 92618

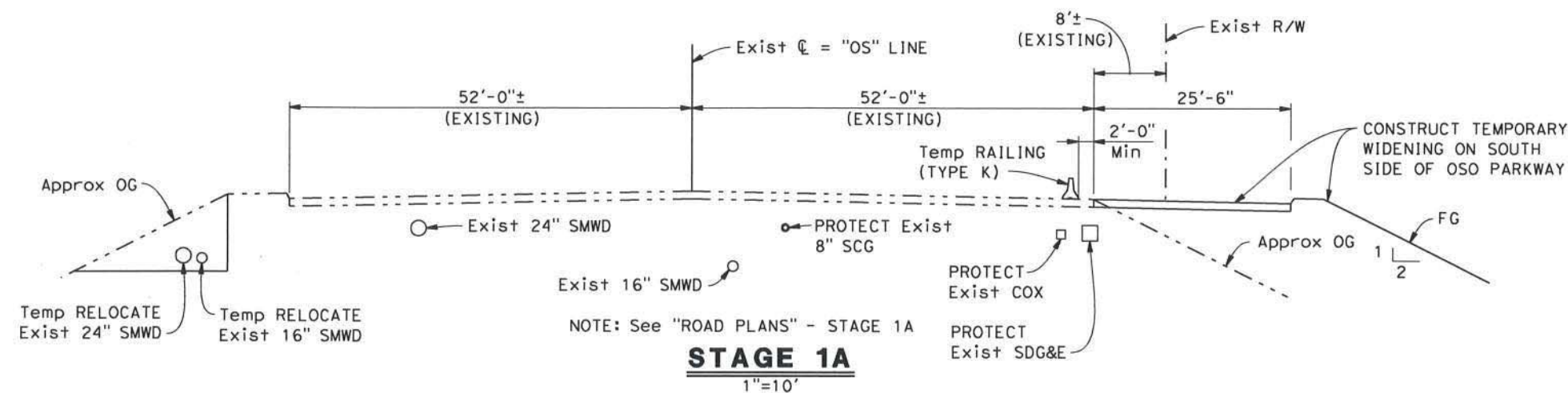

#### UTILITY LEGEND:

- (F) Future Utility Opening
- (W1) SMWD - 16" Domestic Water
- (G) SCG - 8" Gas Line in 12" Casing
- (E) SDG&E - 6-5" Dia Electrical Conduits
- (W2) SMWD - 24" Domestic Water
- (C) COX - 2-4" Dia Communication Conduits
- (F2) 2-4" Dia Conduits for Future Utilities
- (L) 1-2" Dia Conduit for Traffic Loops (see "ELECTRICAL PLANS")
- (S) 1-2" Dia Conduit for Signal Interconnect (see "ELECTRICAL PLANS")
- (D) 8" Dia Deck Drain

#### LEGEND:

- Existing Condition
- New Construction

#### NOTES:

- For deck drain locations and piping layout, see "TYPICAL SECTION" and "GIRDER LAYOUT" sheets.

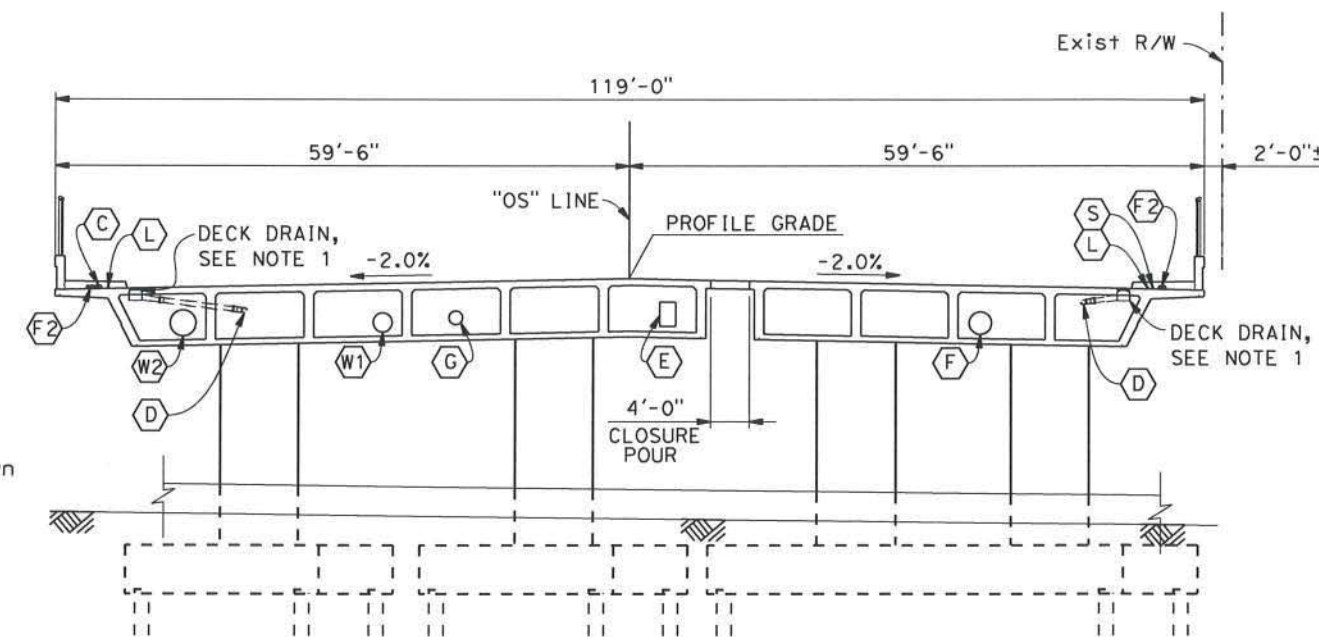
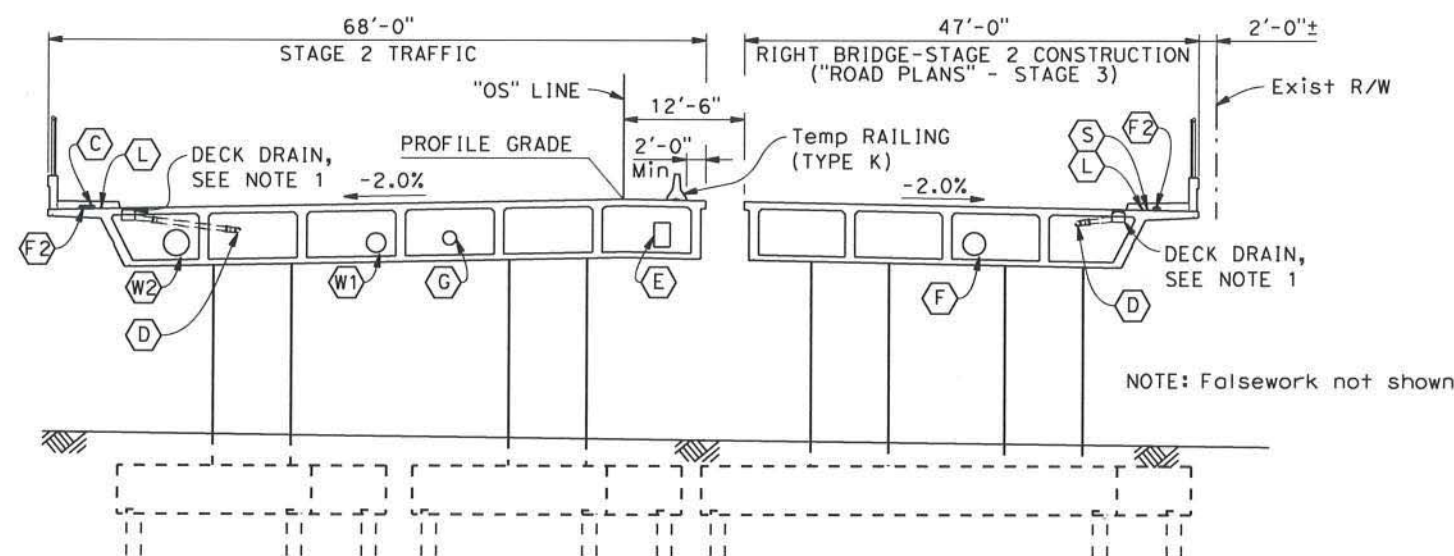
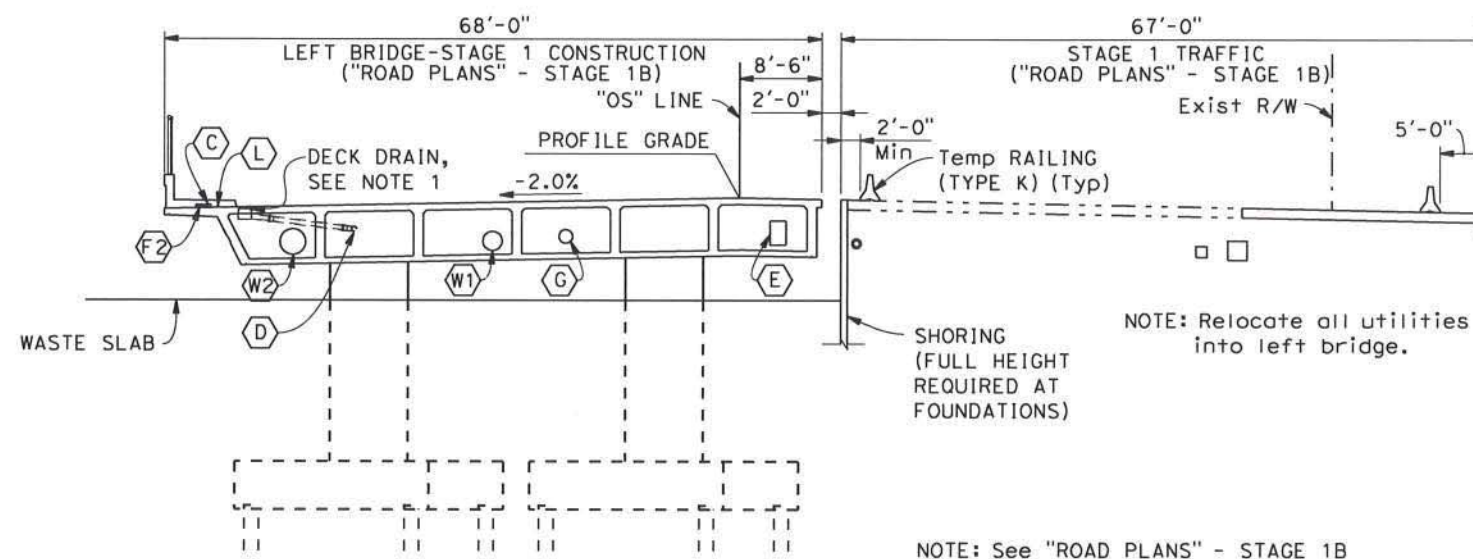

DESIGN OVERSIGHT  
SIGN OFF DATE 7/2/17

DESIGN	BY	CHECKED
DESIGN	Tihomir Kirilov	Bobby Sokolowski
DETAILS	Andy Toledo	Bobby Sokolowski
QUANTITIES	Emir Modarres	Bradley Wilton

PREPARED FOR THE  
STATE OF CALIFORNIA  
DEPARTMENT OF TRANSPORTATION

BRIDGE NO.	POST MILES
55-1112	14.4

**OSO PARKWAY OVERCROSSING  
STAGE CONSTRUCTION**

DESIGN DETAIL SHEET (ENGLISH) (REV. 03/14/12)

ORIGINAL SCALE IN INCHES  
FOR REDUCED PLANS

UNIT: 2998  
PROJECT NUMBER & PHASE: 12160001301 CONTRACT NO.: 12-003401

DISREGARD PRINTS BEARING  
EARLIER REVISION DATES

REVISION DATES	SHEET	OF
3/14/16 1/26/17	3	38

FILE => T:\Irvine\Projects\701250.01\600\_CADD\05\_Official\02\_Structures\DGN\125001-a-sp01.dgn

USERNAME => TKT110V DATE PLOTTED => 7/6/2017 TIME PLOTTED => 11:09:30 AM