

NOTE:

COORDINATES SHOWN ARE BASED ON THE CALIFORNIA COORDINATE SYSTEM (CCS27) ZONE VI, 1927 NORTH AMERICAN DATUM, (OCS 1988.00 EPOCH) AS DESCRIBED IN THE FINAL SURVEY REPORT. ELEVATIONS ARE BASED ON THE NATIONAL GEODETIC VERTICAL DATUM 1929 (NGVD29), OCS 1976 ADJUSTMENT AS DESCRIBED IN THE FINAL SURVEY REPORT.
ALL UNITS ARE U. S. SURVEY FEET.

ORANGE COUNTY

OC PUBLIC WORKS

OC SURVEY



THIS MAP HAS BEEN PRODUCED BY ME
OR UNDER MY DIRECTION IN
CONFORMANCE WITH THE REQUIREMENTS
OF THE PROFESSIONAL LAND SURVEYORS
ACT AT THE REQUEST OF THE ORANGE
COUNTY SURVEYOR ON 05-26-2015.

DENNIS H. DILLMAN LIC # PLS 5424
EXPIRATION DATE (09-30-2016)

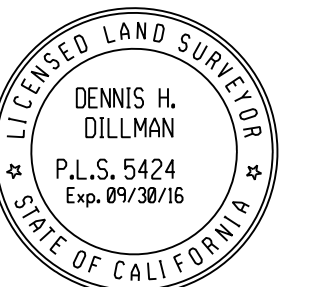

PHOTO SCALE: 1"=750' (1:9000) 5cm=2" PR
HT. ABOVE TERRAIN: 2500'
PHOTO DATE: 05-26-20135
CAMERA: Z/1 -DMC-IIe-230
(DIGITAL MAPPING CAMERA)
FOCAL LENGTH: 92 mm
CONTRACTOR:
DIGITAL MAPPING, INC.
PHOTOGRAPHY:
DIGITAL MAPPING, INC.
SCANNING:
DIGITAL MAPPING, INC.
AERIAL TRIANGULATION:
DIGITAL MAPPING, INC.
GROUND CONTROL: COUNTY OF ORANGE

PRADO BASIN PROJ.
TOPOGRAPHIC MAPPING

SHEET 326 OF 988 SHEETS

MAP SCALE : 1" = 40' & 1' CI