

Designation: ORCHARD

Date Destroyed:

Date Revised: 7/12/2007

GPS #:

OCS Index Map: Q13-01

Page/Grid: 831/B-4

City / Location: Unin., Orange Co.

Line #/SSN: 301/0090

Established By: OCS 2001

Monument Type: Orange County Surveyor's 3 3/4"
Aluminum Disk

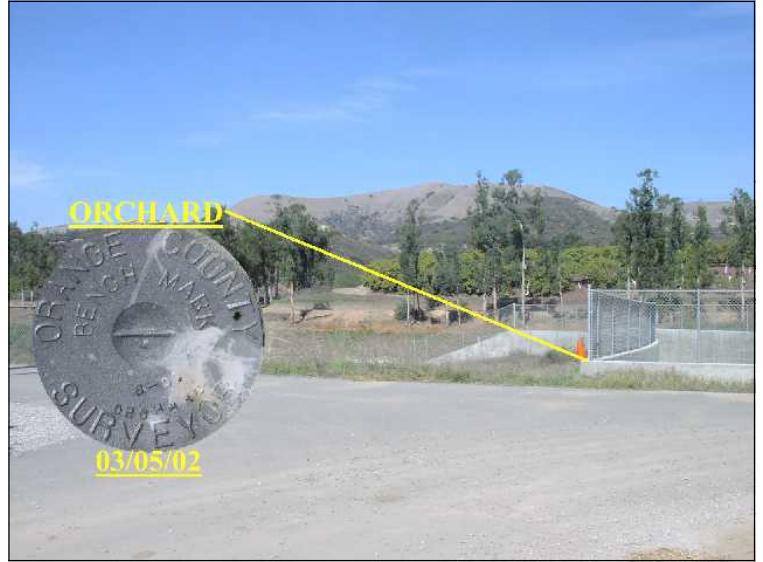

NAVD88 (ft)	NGVD29 (ft)	Year Leveled
409.813	407.404	2002

For Reconnaissance Only!	
Latitude (30' +/-)	Longitude (30' +/-)
33 44 12.99	117 44 40.23

Description:

DESCRIBED BY OCS 2007 - FOUND 3 3/4" OCS ALUMINUM BENCHMARK DISK STAMPED "8-01 ORCHARD", SET IN THE TOP OF A 32 FT. WIDE BY 18 FT. TALL CONCRETE SPILLWAY. MONUMENT IS LOCATED IN THE EASTERLY CORNER OF THE ORCHARD ESTATES RETARDING BASIN, FROM PORTOLA PARKWAY AND CULVER DRIVE PROCEED 0.7 MILES NORTHEASTERLY ALONG CULVER DRIVE TO A "T" INTERSECTION WITH ANOTHER DIRT ROAD, CONTINUE SOUTHEASTERLY 0.4 MILES ALONG DIRT ROAD TO ITS INTERSECTION WITH THE LEVEE ROAD FOR THE ORCHARD ESTATES RETARDING BASIN, 15 FT. NORTHEASTERLY OF THE CENTERLINE OF THE ASPHALT LEVEE ROAD. MONUMENT IS SET LEVEL WITH THE TOP OF THE WALL.

