

**Designation: 3E-118-91**

Date Destroyed:

Date Revised:

GPS #:

OCS Index Map: Q12-03

Page/Grid: 830/D-3

City / Location: Tustin

Line #/SSN: 355/0330

Established By: OCS 1991

Monument Type: Orange County Surveyor's 3 3/4"  
Aluminum Disk

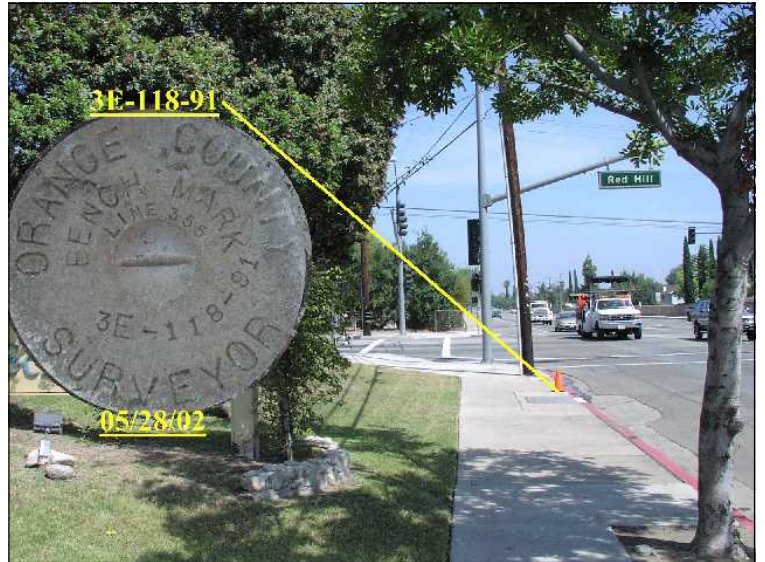

NAVD88 (ft)	NGVD29 (ft)	Year Leveled
117.393	114.966	2003
117.393	114.966	1991

For Reconnaissance Only!	
Latitude (30' +/-)	Longitude (30' +/-)
33 44 41.75	117 48 15.81

**Description:**

DESCRIBED BY OCS 2002 - FOUND 3 3/4" OCS ALUMINUM BENCHMARK DISK STAMPED "3E-118-91", SET IN THE SOUTHEASTERLY CORNER OF A 4 FT. BY 10 FT. CONCRETE CATCH BASIN. MONUMENT IS LOCATED IN THE NORTHWESTERLY CORNER OF THE INTERSECTION OF REDHILL AVENUE AND IRVINE BOULEVARD, 45 FT. NORTHERLY OF THE CENTERLINE OF IRVINE AND 75 FT. WESTERLY OF THE CENTERLINE OF REDHILL. MONUMENT IS SET LEVEL WITH THE SIDEWALK.

