

Designation: 1L-59-82

Date Destroyed:

Date Revised:

GPS #: 1607

OCS Index Map: Q07-05

Page/Grid: 769/F-5

City / Location: Orange

Line #/SSN: 161/0320

Established By: OCS 1982

Monument Type: Orange County Surveyor's 3 3/4"
Aluminum Disk

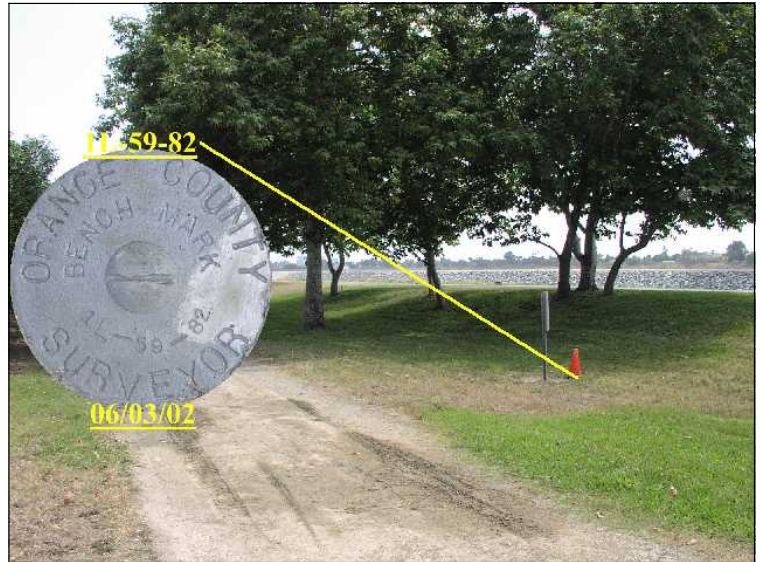

NAVD88 (ft)	NGVD29 (ft)	Year Leveled
196.042	193.628	2006
196.042	193.628	1990

For Reconnaissance Only!	
Latitude (30' +/-)	Longitude (30' +/-)
33 49 43.46201	117 51 53.26392

Description:

DESCRIBED BY OCS 2002 - FOUND 3 3/4" OCS ALUMINUM BENCHMARK DISK STAMPED "1L-59-82", SET IN THE TOP OF A 6 IN. BY 6 IN. CONCRETE POST. MONUMENT IS LOCATED ALONG THE SANTA ANA RIVER SOUTHEASTERLY LEVEE, 0.9 MILES NORTHEASTERLY OF THE CENTERLINE OF BALL ROAD, 19.0 FT. WESTERLY OF THE CENTERLINE OF THE DIRT HORSE TRAIL ALONG SOUTHEASTERLY LEVEE AND 2 FT. WESTERLY OF AN OCS WITNESS POST. MONUMENT IS SET UP 0.1 FT. ABOVE THE GROUND.

