

CORNER RECORD

City of UNINCORPORATED

Document Number 2001-1580

County of ORANGE, California

Brief Legal Description TIES FOR TRACT 14955

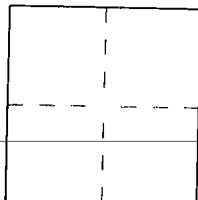

CORNER TYPE

Government Corner ☐ Control ☐
Meander ☐ Property ☒
Rancho ☐ Other ☐

Date of Survey AUGUST 22, 2001

COORDINATES (Optional)

N. _____
E. _____
Zone _____ NAD27 ☐ NAD83 ☐
NAD83 Epoch _____
Elev. _____
Vert. Datum: NGVD29 ☐ NAVD88 ☐
Meas. Units: Metric ☐ Imperial ☐
U.S. Survey foot ☐

Corner Left as found ☐ Found and tagged ☐ Established ☒ Reestablished ☐ Rebuilt ☐

Identification and type of corner found; Evidence used to identify or procedure used to establish or reestablish the corner:

FOUND SPIKE AND WASHER, R.C.E. 23956 OR SET SPIKE AND WASHER, L.S. 6654

AT THE CENTERLINE OF THE STREETS IN THIS TRACT ON OSO PARKWAY,

BRIDLE PATH, GINGHAM STREET, PROSPECTOR COURT, WRANGLER COURT,

AND CALICO COURT, PER TRACT NO. 14955, MM 728/42-48, AS CORRECTED

BY CERTIFICATE OF CORRECTION, INST. NO. 20010079973, O.R.

A description of the physical condition of the monument as found and as set or reset: _____

SURVEYOR'S STATEMENT

This Corner Record was prepared by me or under my direction in conformance with
the Land Surveyor's Act on SEPTEMBER 18, 2001

Signed Rory S. Williams L.S. or R.C.E. No. 6654

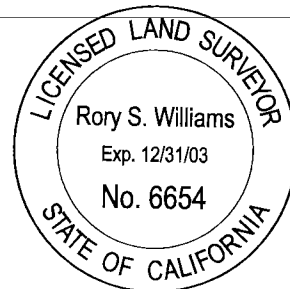

COUNTY SURVEYOR'S STATEMENT

This Corner Record was received JAN 3, 2002

and examined and filed FEB 08 2002

Signed Robert Jelinek L.S. or R.C.E. No. 6803

Title DEPUTY COUNTY SURVEYOR

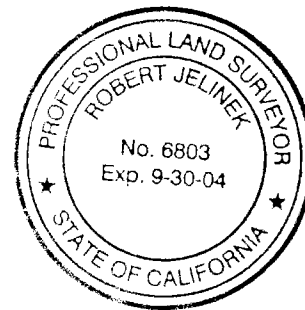

County Surveyor's Comment _____

HUNSAKER & ASSOCIATES, INC.

SEPTEMBER 18, 2001

LAND SURVEYOR: RORY WILLIAMS L.S. 6654

NOTE

● TIE POINTS ARE L & T
TAGGED R.C.E. 23956 SET
IN TOP OF CURB UNLESS
OTHERWISE NOTED.

■ TIE POINTS ARE L & T
TAGGED L.S. 6654 SET
IN TOP OF CURB UNLESS
OTHERWISE NOTED.

LEGEND

○ INDICATES FOUND 8" SPIKE &
WASHER STAMPED R.C.E. 23956
UNLESS OTHERWISE NOTED.

□ INDICATES FOUND 8" SPIKE &
WASHER STAMPED L.S. 6654 UNLESS
OTHERWISE NOTED, PER CERTIFICATE
OF CORRECTION, INST. NO.
20010079973, O.R.

