

CITY OF SANTA ANA  
TIE

SALTA STREET & HALL AVENUE

BK / PG 3 / 179

DATE 8/26/97

CREW RR BH

COUNTY DOC. \_\_\_\_\_

HISTORY

- o FD PK NAIL & TIN 5/70.
- RECOV'D SAME 5/88, 4/94, 7/96, 6/9/97 & 8/26/97.

CSATB 3 / 86



NTS

CSATB 3 / 171

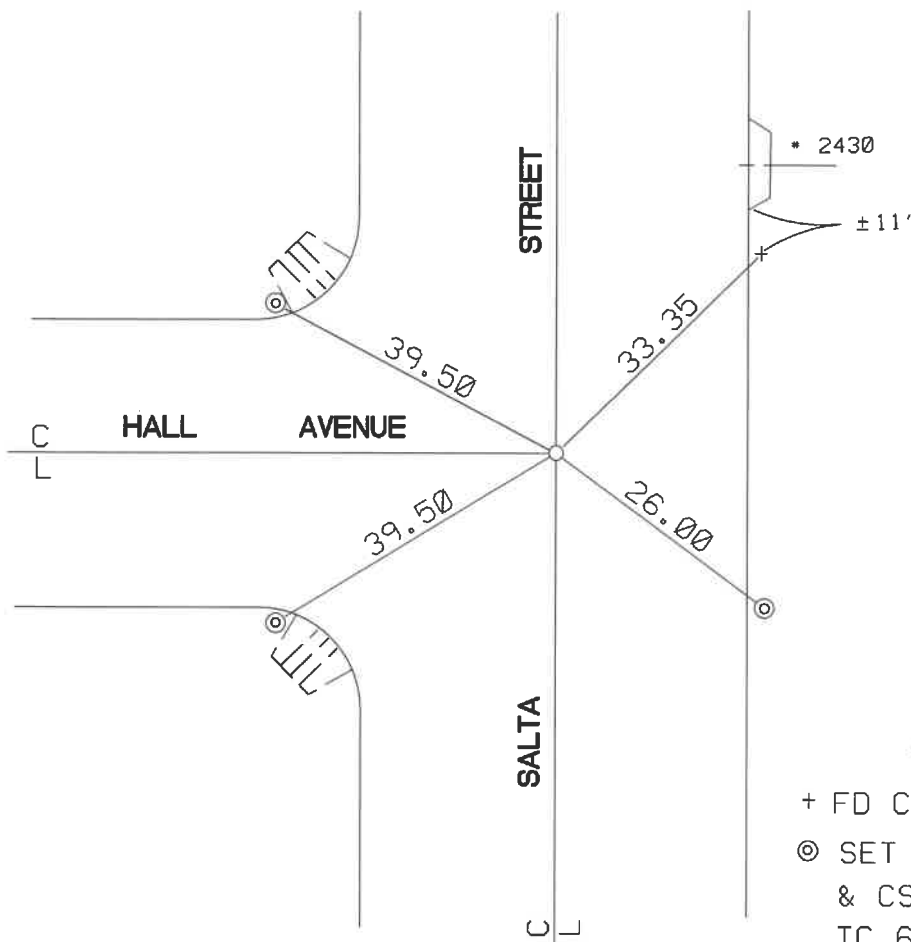

LEGEND

- + FD CHISL'D IN TC
- ⊙ SET LEAD, TACK & CSA TAG IN TC 6/9/97

CSATB 1 / 22

NOTE: THESE TIES ARE FOR THE PURPOSE OF PERPETUATING THE FOUND MONUMENTATION. NO CLAIM IS MADE AS TO THE RELATIONSHIP OF THE POINTS OR LINES SHOWN HEREON TO THE TRUE BOUNDARY LOCATIONS.

BH