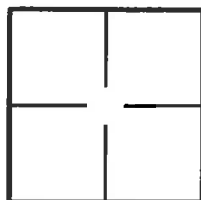

# CORNER RECORD

Document Number 2015-0909BCity of TUSTIN County of ORANGE, CaliforniaBrief Legal Description CASTLEGATE LANE (ALGIE LANE) & GLENMERE DRIVE (MABEL LANE)

## CORNER TYPE

Government Corner ☐ Control ☒  
Meander ☐ Property ☐  
Rancho ☐ Other ☐

Date of Survey 9/15/2014

## COORDINATES (Optional)

N. \_\_\_\_\_  
E. \_\_\_\_\_  
Zone \_\_\_\_\_ NAD27 ☐ NAD83 ☐  
NAD83 Epoch \_\_\_\_\_  
Elevation \_\_\_\_\_  
Vertical Datum: NGVD29 ☐ NAVD88 ☐  
Units: Metric ☐ Imperial ☐ U.S. Survey ☒

Corner — Left as found ☐ Found and tagged ☐ Established ☐ Reestablished ☒ Rebuilt ☐

Identification and type of corner found; Evidence used to identify or procedure used to establish or reestablish corner:  
Found as described on the reverse of this sheet.

A description of the physical condition of the monument as found and as set or reset: \_\_\_\_\_  
See Page 2

## SURVEYOR'S STATEMENT

This Corner Record was prepared by me or under my direction in conformance with  
the Professional Land Surveyors' Act on 3/2/2015

Signed [Signature] P.L.S. or R.C.E. No. L.S. 5411

## COUNTY SURVEYOR'S STATEMENT

This Corner Record was received MAR 19 2015examined and filed MAY 11 2015Signed [Signature] P.L.S. or R.C.E. No. 1131Title Chief Deputy Surveyor

County Surveyor's Comment \_\_\_\_\_

R-1 = COUNTY OF ORANGE CORNER RECORD 2014-2744 A  
 [ ] = RECORD & MEASURED DISTANCE PER R-1

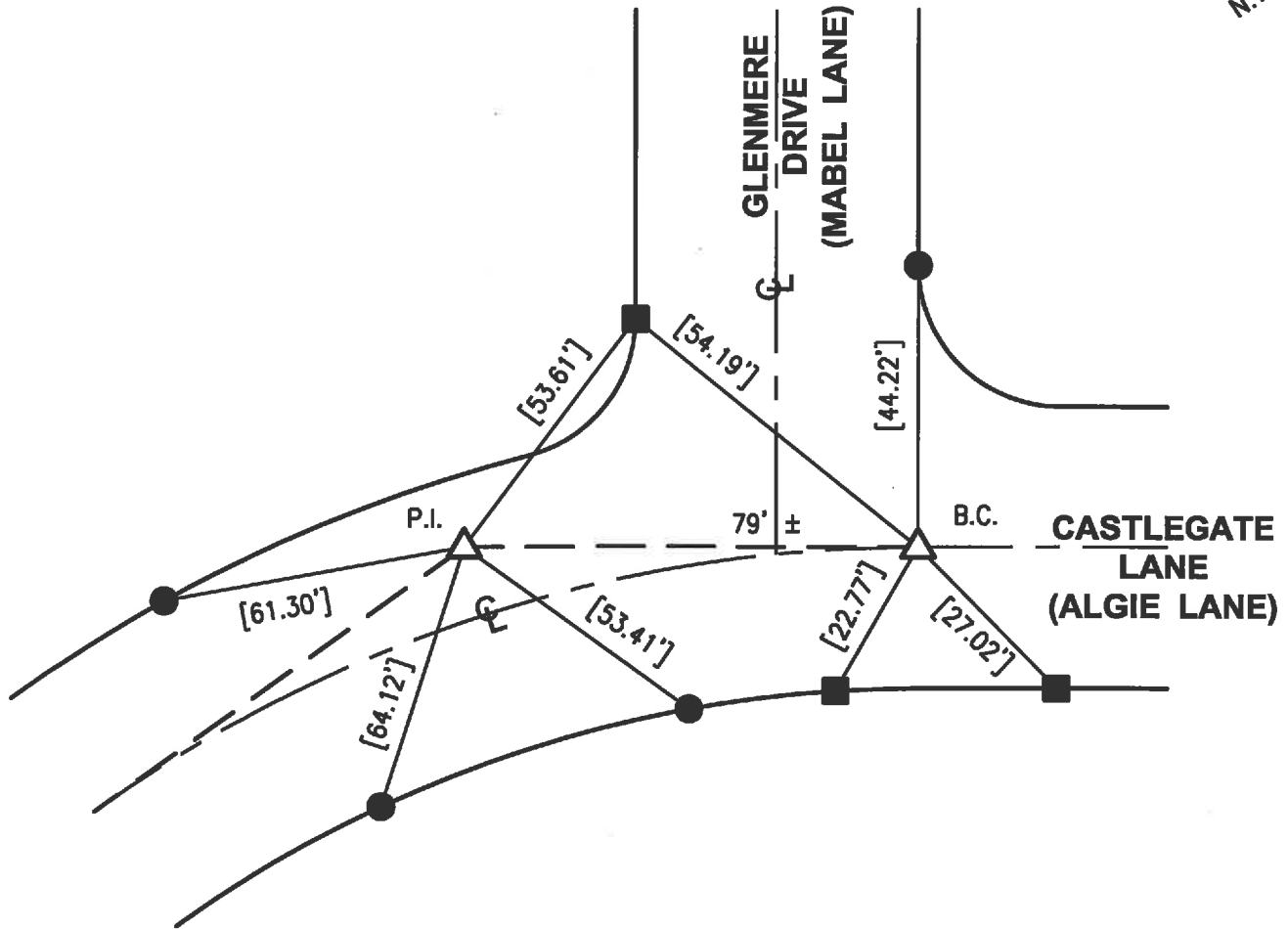
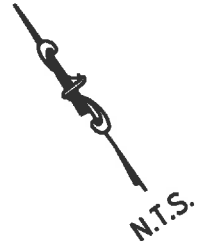

△ FD NOTHING, SET GEAR SPK & W, STAMPED "LS 5411" PER TIES ON R-1, FLUSH, AFTER CONSTRUCTION.

● FD L & T IN T.C. PER R-1.

■ FD L, T & T "O.C.S." IN T.C. PER R-1.

THE PURPOSE OF THIS RECORD IS TO DOCUMENT THE PERPETUATION OF FOUND MONUMENT(S) PURSUANT TO THE PLS ACT SECTION 8771. NO CLAIM IS MADE REGARDING THE CORRECTNESS OF THE POSITION(S) OF SAID MONUMENT(S), NOR THE DIMENSIONAL RELATIONSHIP TO STREET CENTERLINES OR PROPERTY BOUNDARIES.

14-RJN-521