

CORNER RECORD

Document Number 2007-2631B

City of ORANGE County of ORANGE, California

Brief Legal Description Q INT LARKSTONE DE WHEELER PL

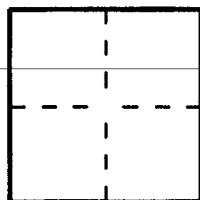

CORNER TYPE

Government Corner ☐ Control ☒
 Meander ☐ Property ☐
 Rancho ☐ Other ☐

Date of Survey 9-25-07

COORDINATES (Optional)

N. _____
 E. _____
 Zone _____ NAD27 ☐ NAD83 ☐
 NAD83 Epoch _____
 Elevation _____
 Vertical Datum: NGVD29 ☐ NAVD83 ☐
 Units: Metric ☐ Imperial ☐ U.S. Survey ☒

Corner — Left as found ☒ Found and tagged ☐ Established ☐ Reestablished ☐ Rebuilt ☒

Identification and type of corner found; Evidence used to identify or procedure used to establish or reestablish the corner:

RD XSTG TIES PER CR 2007-1952A

A description of the physical condition of the monument as found and as set or reset: _____

SET S.W. LS 7707 PER RECORD TIES

SURVEYOR'S STATEMENT

This Corner Record was prepared by me or under my direction in conformance with the Professional Land Surveyors' Act on 10-19-07

Signed Walter F. Lundin P.L.S. or R.C.E. No. 7707

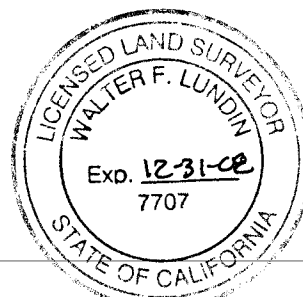

COUNTY SURVEYOR'S STATEMENT

This Corner Record was received OCT 22 2007

examined and filed DEC 07 2007

Signed [Signature] P.L.S. or R.C.E. No. 7212

Title DEPUTY COUNTY SURVEYOR



County Surveyor's Comment _____

▲ SET S&W LS 7707 PER CR 2007-1952A
 ○ FD L&TK IN T.C. PER CR 2007-1952A



NTS

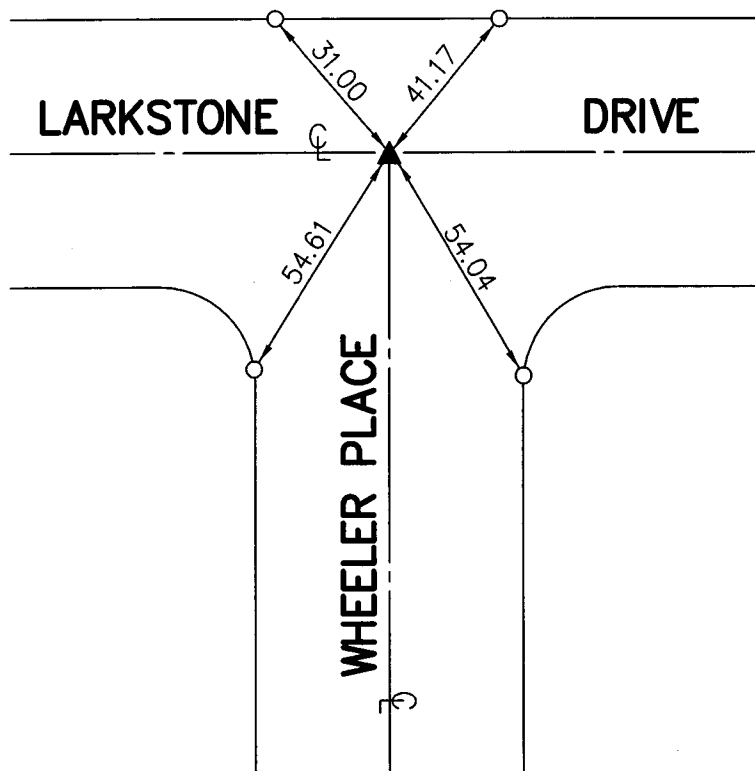

NOTE: THESE TIES ARE FOR THE PURPOSES OF PERPETUATING THE FOUND MONUMENTATION. NO CLAIM IS MADE TO THE RELATIONSHIP OF THE POINTS OR LINES SHOWN HEREON TO THE TRUE BOUNDARY LOCATIONS.