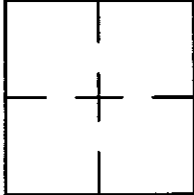

CORNER RECORD

Agency Index

Document Number

2019-0913City of UNINCORPORATEDCounty of ORANGE, CaliforniaBrief Legal Description FOOTHILL BOULEVARD & ORANGE KNOLL DRIVE**CORNER TYPE****COORDINATES (Optional)**

Government Corner	<input type="checkbox"/>	Control	<input checked="" type="checkbox"/>
Meander	<input type="checkbox"/>	Property	<input type="checkbox"/>
Rancho	<input type="checkbox"/>	Other	<input type="checkbox"/>

Date of Survey 3/05/2019

N. _____ E. _____

Elevation _____

Units Metric ☐ U.S. Survey Foot ☒

Horizontal Datum _____

Zone _____ Epoch Date _____

Vertical Datum _____

☐ Complies with Public Resources Code §§8801-8819☐ Complies with Public Resources Code §§8890-8902PLS Act Ref: ☐ 8765 (d) ☒ 8771 ☐ 8773 ☐ Other:

Corner/	<input checked="" type="checkbox"/> Left as found	<input type="checkbox"/> Established	<input type="checkbox"/> Rebuilt	<input type="checkbox"/> Pre-Construction
Monument:	<input type="checkbox"/> Found and tagged	<input checked="" type="checkbox"/> Reestablished	<input type="checkbox"/> Referenced	<input checked="" type="checkbox"/> Post-Construction

Narrative of corner identified and monument as found, set, reset, replaced, or removed:

☒ See sheet #2 for description(s) :**SURVEYOR'S STATEMENT**

This Corner Record was prepared by me or under my direction in conformance with

the Professional Land Surveyors' Act on MARCH 26, 2019.Signed  P.L.S. or R.C.E. No. L.S. 8231**COUNTY SURVEYOR'S STATEMENT**This Corner Record was received MAR 29, 2019and examined and filed JUL 22 2019.Signed  P.L.S. or R.C.E. No. 6617Title COUNTY SURVEYOR

County Surveyor's Comment



MONUMENT NOTES:

- △ FD NOTHING, SET GEAR, SPK & W, STAMPED "LS 8231", PER TIES ON R1, FLUSH, AFTER CONSTRUCTION.
- ▲ FD 2" BRASS DISK PUNCHED IN O.C.S. WELL MON. PER R3, DOWN 1.0', AFTER CONSTRUCTION.
- FD LEAD, TACK & TAG "RCE 8793" IN T.C. PER R1.
- ⊙ FD NAIL & TAG "LS 8294" IN T.C. PER R1.
- FD LEAD, TACK & TAG "LS 8231" IN T.C. PER R1.
- SET LEAD, TACK & TAG "LS 8231" IN T.C.

REFERENCES:

R1 = COUNTY OF ORANGE CORNER RECORD 2017-2000 A
 [] = RECORD & MEASURED DISTANCE PER R1

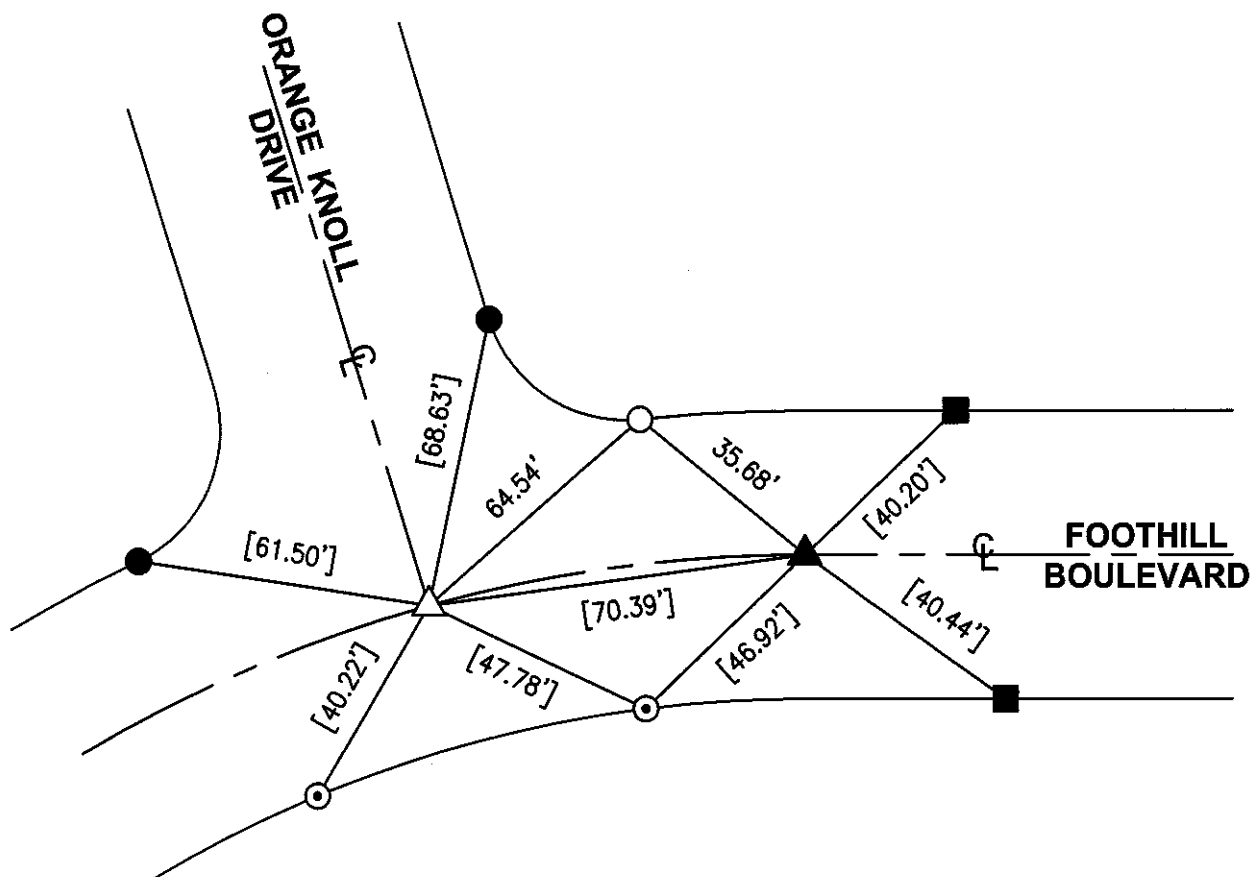

THE PURPOSE OF THIS RECORD IS TO DOCUMENT THE PERPETUATION OF FOUND MONUMENT(S) PURSUANT TO THE PLS ACT SECTION 8771.