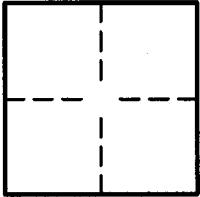

CORNER RECORD

Document Number 2014-1435 BCity of NEWPORT BEACH County of ORANGE, CaliforniaBrief Legal Description MESA DRIVE & BAYVIEW AVENUE

CORNER TYPE

Government Corner ☐ Control ☒
Meander ☐ Property ☐
Rancho ☐ Other ☐

Date of Survey 5/01/14

COORDINATES (Optional)

N. _____
E. _____
Zone _____ NAD27 ☐ NAD83 ☐
NAD83 Epoch _____
Elevation _____
Vertical Datum: NGVD29 ☐ NAVD88 ☐
Units: Metric ☐ Imperial ☐ U.S. Survey ☒

Corner — Left as found ☒ Found and tagged ☐ Established ☐ Reestablished ☒ Rebuilt ☐

Identification and type of corner found; Evidence used to identify or procedure used to establish or reestablish corner:
FOUND AS DESCRIBED ON THE REVERSE OF THIS SHEET.

A description of the physical condition of the monument as found and as set or reset: _____
SEE PAGE 2.

SURVEYOR'S STATEMENT

This Corner Record was prepared by me or under my direction in conformance with
the Professional Land Surveyors' Act on 5/05/2014

Signed [Signature] P.L.S. or R.C.E. No. L.S. 5411

COUNTY SURVEYOR'S STATEMENT

This Corner Record was received MAY 08 2014
examined and filed JUL 30 2014

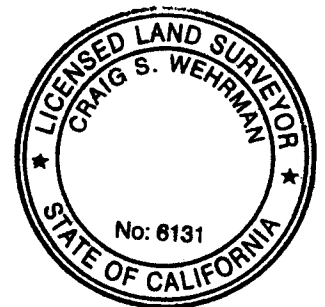
Signed [Signature] P.L.S. or R.C.E. No. 6131Title Chief Deputy Surveyor

County Surveyor's Comment _____

R-1 = COUNTY OF ORANGE CORNER RECORD 2013-1828 A

[] = RECORD & MEASURED DISTANCE PER R-1

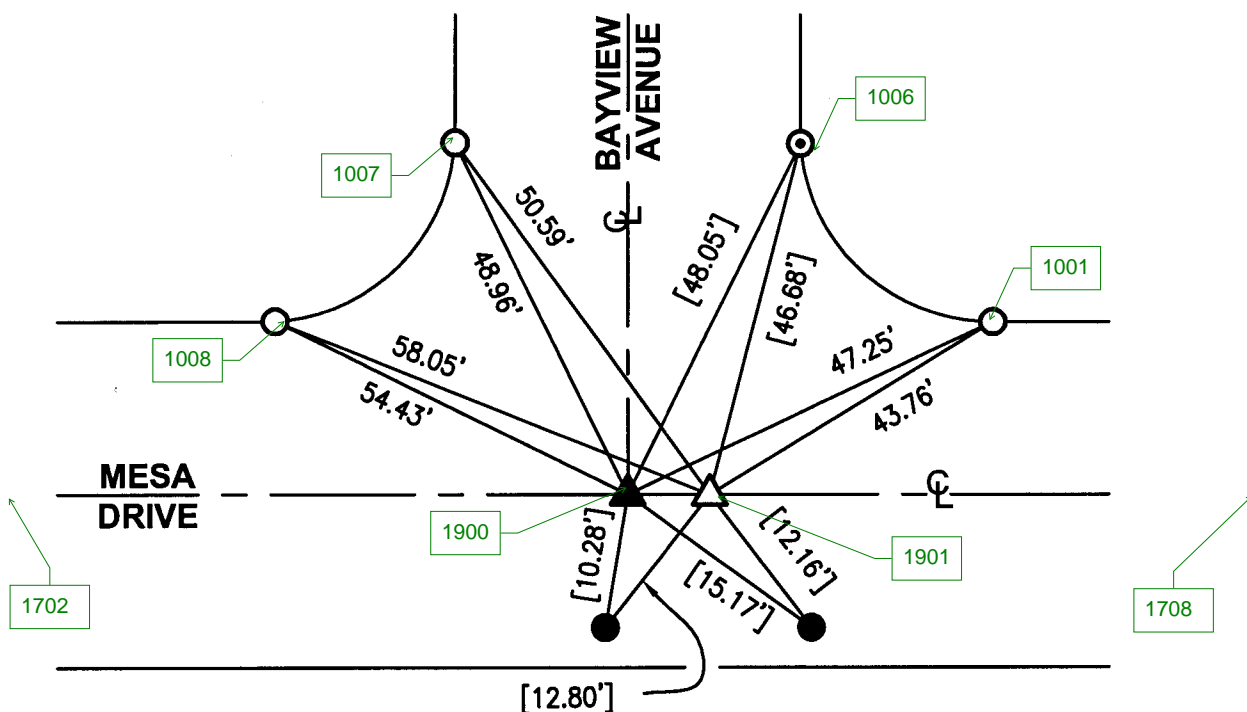
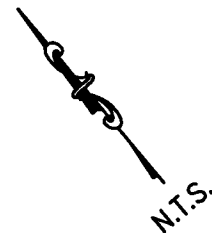

△ FD. NOTHING, SET GEAR SPK & W, STAMPED "LS 5411" PER TIES ON R-1, FLUSH, AFTER CONSTRUCTION.

▲ FD. MANHOLE WITH 4 P.M.'S PER R-1 AFTER CONSTRUCTION.

⊙ FD. L, T & T "OCS TIE" IN T.C. PER R-1.

● FD. PK NAIL & W, STAMPED "ORANGE COUNTY SURVEYOR" FLUSH IN A.C. PER R-1.

○ SET L, T & T "LS 5411" IN T.C.

THE PURPOSE OF THIS RECORD IS TO DOCUMENT THE PERPETUATION OF FOUND MONUMENT(S) PURSUANT TO THE PLS ACT SECTION 8771. NO CLAIM IS MADE REGARDING THE CORRECTNESS OF THE POSITION(S) OF SAID MONUMENT(S), NOR THE DIMENSIONAL RELATIONSHIP TO STREET CENTERLINES OR PROPERTY BOUNDARIES.

13-ALL-291