



Issuing Policies of Fidelity National Title Insurance Company

Order No.: 989-30117638-BAM

Main Office Line: (951) 710-5944

TO:

Orange County Tax Collector
400 W. Civic Center Drive, 5th Floor
Santa Ana, CA 92701

Title Officer: Andrew Margo (BS-RIV)

Title Officer Phone: (951) 710-5944

Title Officer Fax: (951) 710-5955

Title Officer Email: theATeam@fnf.com

ATTN: **Nilda Silva**

YOUR REFERENCE:

PROPERTY ADDRESS: 1015 - 1055 North Main Street, Santa Ana, CA

PRELIMINARY REPORT

*In response to the application for a policy of title insurance referenced herein, **Fidelity National Title Company** hereby reports that it is prepared to issue, or cause to be issued, as of the date hereof, a policy or policies of title insurance describing the land and the estate or interest therein hereinafter set forth, insuring against loss which may be sustained by reason of any defect, lien or encumbrance not shown or referred to as an exception herein or not excluded from coverage pursuant to the printed Schedules, Conditions and Stipulations or Conditions of said policy forms.*

The printed Exceptions and Exclusions from the coverage and Limitations on Covered Risks of said policy or policies are set forth in Attachment One. The policy to be issued may contain an arbitration clause. When the Amount of Insurance is less than that set forth in the arbitration clause, all arbitrable matters shall be arbitrated at the option of either the Company or the Insured as the exclusive remedy of the parties. Limitations on Covered Risks applicable to the CLTA and ALTA Homeowner's Policies of Title Insurance which establish a Deductible Amount and a Maximum Dollar Limit of Liability for certain coverages are also set forth in Attachment One. Copies of the policy forms should be read. They are available from the office which issued this report.

This report (and any supplements or amendments hereto) is issued solely for the purpose of facilitating the issuance of a policy of title insurance and no liability is assumed hereby. If it is desired that liability be assumed prior to the issuance of a policy of title insurance, a Binder or Commitment should be requested.

The policy(s) of title insurance to be issued hereunder will be policy(s) of Fidelity National Title Insurance Company, a Florida Corporation.

Please read the exceptions shown or referred to herein and the exceptions and exclusions set forth in Attachment One of this report carefully. The exceptions and exclusions are meant to provide you with notice of matters which are not covered under the terms of the title insurance policy and should be carefully considered.

It is important to note that this preliminary report is not a written representation as to the condition of title and may not list all liens, defects and encumbrances affecting title to the land.

Countersigned by:

Authorized Signature



PRELIMINARY REPORT

EFFECTIVE DATE: May 14, 2024 at 7:30 a.m.

ORDER NO.: 989-30117638-BAM

The form of policy or policies of title insurance contemplated by this report is:

ALTA Standard Owners Policy (6-17-06)

1. THE ESTATE OR INTEREST IN THE LAND HEREINAFTER DESCRIBED OR REFERRED TO COVERED BY THIS REPORT IS:

A FEE

2. TITLE TO SAID ESTATE OR INTEREST AT THE DATE HEREOF IS [VESTED IN:](#)

SIC/LEED 1015 SANTA ANA, LLC, a Delaware limited liability company

3. THE LAND REFERRED TO IN THIS REPORT IS DESCRIBED AS FOLLOWS:

See Exhibit A attached hereto and made a part hereof.

EXHIBIT A

LEGAL DESCRIPTION

THE LAND REFERRED TO HEREIN BELOW IS SITUATED IN THE CITY OF SANTA ANA, COUNTY OF ORANGE, STATE OF CALIFORNIA, AND IS DESCRIBED AS FOLLOWS:

PARCEL A:

LOTS 16, 18, 20, 22, 24 AND 26 OF SMITH AND BISHOP, ADDITION TO SANTA ANA, IN THE CITY OF SANTA ANA, COUNTY OF ORANGE, STATE OF CALIFORNIA, AS PER MAP RECORDED IN [BOOK 13, PAGE 63](#) OF MISCELLANEOUS RECORDS, IN THE OFFICE OF THE COUNTY RECORDER OF LOS ANGELES COUNTY, CALIFORNIA, TOGETHER WITH THAT PORTION OF THE NORTH HALF OF THE ALLEY ADJOINING SAID LOTS ON THE SOUTH, BOUNDED EASTERLY BY THE SOUTHERLY PROLONGATION OF THE EAST LINE OF SAID LOT 16 AND BOUNDED WESTERLY BY A LINE PARALLEL WITH AND EAST 45.00 FEET FROM THE CENTERLINE OF MAIN STREET, AS ABANDONED BY RESOLUTION TO THE CITY COUNCIL OF THE CITY OF SANTA ANA, A COPY OF WHICH WAS RECORDED MARCH 6, 1963 IN [BOOK 6456, PAGE 140](#) OF OFFICIAL RECORDS.

PARCEL B:

LOT(S) 1, 3, 5, 7, 9 AND 11 OF WITMER AND VAN ALSTYNE'S ADDITION TO SANTA ANA, IN THE CITY OF SANTA ANA, COUNTY OF ORANGE, STATE OF CALIFORNIA, AS PER MAP RECORDED IN [BOOK 13, PAGE 15](#) OF MISCELLANEOUS RECORDS, IN THE OFFICE OF THE COUNTY RECORDER OF LOS ANGELES COUNTY, CALIFORNIA, TOGETHER WITH THAT PORTION OF THE SOUTH HALF OF THE ALLEY ADJOINING SAID LOTS ON THE NORTH, BOUNDED EASTERLY BY THE NORTHERLY PROLONGATION OF THE EAST LINE OF SAID LOT 11 AND BOUNDED WESTERLY BY A LINE PARALLEL WITH AND EAST 45.00 FEET FROM THE CENTERLINE OF MAIN STREET, AS ABANDONED BY RESOLUTION TO THE CITY COUNCIL OF THE CITY OF SANTA ANA, A COPY OF WHICH WAS RECORDED MARCH 6, 1963 IN [BOOK 6456, PAGE 140](#) OF OFFICIAL RECORDS.

EXCEPT THAT PORTION OF SAID LOT 1 LYING WESTERLY OF A LINE PARALLEL WITH AND EAST 45.00 FEET MEASURED ALONG THE EASTERLY PROLONGATION OF THE NORTH LINE OF SAID LOT FROM THE CENTERLINE OF MAIN STREET.

PARCEL C:

LOT(S) 10 AND 12 IN SMITH AND BISHOP ADDITION TO SANTA ANA, IN THE CITY OF SANTA ANA, COUNTY OF ORANGE, STATE OF CALIFORNIA, AS PER MAP RECORDED IN [BOOK 1, PAGE 100](#) OF MISCELLANEOUS MAPS, IN THE OFFICE OF THE COUNTY RECORDER OF SAID COUNTY, TOGETHER WITH THAT PORTION OF THE ALLEY ADJOINING SAID LOTS ON THE SOUTH AS VACATED BY RESOLUTION TO THE CITY COUNCIL, RECORDED AUGUST 27, 1951 IN [BOOK 2221, PAGE 470](#) OF OFFICIAL RECORDS OF SAID COUNTY, WHICH WOULD PASS BY OPERATION OF LAW WITH A CONVEYANCE OF SAID LOTS.

PARCEL D:

LOT 15 OF WITMER AND VAN ALSTYNE'S ADDITION TO SANTA ANA, IN THE CITY OF SANTA ANA, COUNTY OF ORANGE, STATE OF CALIFORNIA, AS PER MAP RECORDED IN [BOOK 13, PAGE 15](#) OF MISCELLANEOUS RECORDS, IN THE OFFICE OF THE COUNTY RECORDER OF LOS ANGELES COUNTY, CALIFORNIA, TOGETHER WITH THAT PORTION OF THE ALLEY ADJOINING SAID LOT 15 OF THE NORTH AND ON THE EAST AS VACATED BY RESOLUTION TO THE CITY COUNCIL, RECORDED AUGUST 27, 1951 IN [BOOK 2221, PAGE 470](#) OF OFFICIAL RECORDS, RIGHT OF WHICH WOULD PASS BY OPERATION OF LAW WITH A CONVEYANCE OF SAID LOTS.

PARCEL E:

EXHIBIT A
(Continued)

LOT(S) 4, 5 AND THE EAST 40 FEET OF LOT 3 OF HENRY CARPENTER'S ADDITION TO SANTA ANA, IN THE CITY OF SANTA ANA, COUNTY OF ORANGE, STATE OF CALIFORNIA, AS PER MAP RECORDED IN [BOOK 1, PAGE 72](#) OF MISCELLANEOUS MAPS, OF SAID ORANGE COUNTY, TOGETHER WITH THAT PORTION OF THE ALLEY ADJOINING SAID LOT 5 ON THE WEST AS VACATED BY RESOLUTION TO THE CITY COUNCIL, RECORDED AUGUST 27, 1951 IN [BOOK 2221, PAGE 470](#) OF OFFICIAL RECORDS, WHICH WOULD PASS BY OPERATION OF LAW WITH A CONVEYANCE OF SAID LOTS.

PARCEL F:

LOT(S) 6, 8 AND THE WEST 11.4 FEET OF LOT 4 OF SMITH AND BISHOP'S ADDITION TO SANTA ANA, IN THE CITY OF SANTA ANA, COUNTY OF ORANGE, STATE OF CALIFORNIA, AS PER MAP RECORDED IN [BOOK 13, PAGE 63](#) OF MISCELLANEOUS RECORDS OF LOS ANGELES COUNTY, CALIFORNIA, AND ON A CORRECTED MAP RECORDED IN [BOOK 1, PAGE 100](#) OF MISCELLANEOUS MAPS OF SAID ORANGE COUNTY.

PARCEL G:

THAT PARCEL OF THE ALLEY 6.00 FEET IN WIDTH ADJOINING THE SOUTHERLY LINE OF LOT(S) 4, 6 AND 8 OF SMITH AND BISHOP'S ADDITION TO SANTA ANA, IN THE CITY OF SANTA ANA, COUNTY OF ORANGE, STATE OF CALIFORNIA, AS PER MAP RECORDED IN [BOOK 13, PAGE 63](#) OF MISCELLANEOUS RECORDS OF LOS ANGELES COUNTY, CALIFORNIA, AND ON A CORRECTED MAP RECORDED IN [BOOK 1, PAGE 100](#) OF MISCELLANEOUS MAPS OF SAID ORANGE COUNTY, CALIFORNIA, AS SAID ALLEY WAS ABANDONED BY RESOLUTION OF THE CITY COUNCIL, OF SANTA ANA, RECORDED AUGUST 27, 1951 IN [BOOK 2221, PAGE 470](#) OF OFFICIAL RECORDS, BEING THAT PORTION OF SAID ALLEY LYING EASTERLY OF THE SOUTHERLY PROLONGATION OF THE WESTERLY LINE OF SAID LOT 8 AND WESTERLY OF THE SOUTHERLY PROLONGATION OF THE EASTERLY LINE OF THE WESTERLY 11.40 FEET OF SAID LOT 4.

PARCEL H:

LOT(S) 7 AND 5 AND THE WEST 11.4 FEET OF LOT 3 OF SMITH & BISHOP'S TO SANTA ANA, CHURCHILL SERVICE CORPORATION, A CALIFORNIA CORPORATION, AS PER MAP RECORDED IN [BOOK 13, PAGE 63](#) OF MISCELLANEOUS RECORDS OF COUNTY OF LOS ANGELES, CALIFORNIA, AND ON A CORRECTED MAP RECORDED IN [BOOK 1, PAGE 100](#) OF MISCELLANEOUS MAPS OF SAID ORANGE COUNTY.

EXCEPT THEREFROM THE NORTH 50 FEET THEREOF.

[APN: 398-023-01](#); [APN: 398-024-01](#), 02 04, 05, 06; [APN: 398-025-07](#)

EXCEPTIONS

AT THE DATE HEREOF, ITEMS TO BE CONSIDERED AND EXCEPTIONS TO COVERAGE IN ADDITION TO THE PRINTED EXCEPTIONS AND EXCLUSIONS IN SAID POLICY FORM WOULD BE AS FOLLOWS:

- A. Property taxes, which are a lien not yet due and payable, including any assessments collected with taxes to be levied for the fiscal year 2024-2025.
- B. The lien of supplemental or escaped assessments of property taxes, if any, made pursuant to the provisions of Chapter 3.5 (commencing with Section 75) or Part 2, Chapter 3, Articles 3 and 4, respectively, of the Revenue and Taxation Code of the State of California as a result of the transfer of title to the vestee named in Schedule A or as a result of changes in ownership or new construction occurring prior to Date of Policy.
1. Water rights, claims or title to water, whether or not disclosed by the public records.
2. Easement(s) for the purpose(s) shown below and rights incidental thereto, as granted in a document:
- Granted to: City of Santa Ana
Purpose: street
Recording Date: September 19, 1963
Recording No: in [Book 6724, Page 52](#) of Official Records
Affects: a portion of Parcel H
3. Easement(s) for the purpose(s) shown below and rights incidental thereto, as granted in a document:
- Granted to: City of Santa Ana
Purpose: street
Recording Date: July 10, 1964
Recording No: in [Book 7127, Page 792](#) of Official Records
Affects: a portion of Parcels F and G
4. Easement(s) for the purpose(s) shown below and rights incidental thereto, as granted in a document:
- Granted to: Southern California Edison Company, a Corporation
Purpose: underground electrical supply systems and communication systems
Recording Date: October 31, 1968
Recording No: in [Book 8773, Page 957](#) of Official Records
Affects: portions of Parcels A and B
5. Easement(s) for the purpose(s) shown below and rights incidental thereto, as granted in a document:
- Granted to: Southern California Edison Company, a Corporation
Purpose: overhead and underground electrical supply and communication systems
Recording Date: May 21, 1969
Recording No: in [Book 8963, Page 123](#) of Official Records
Affects: a portion of Parcel A

EXCEPTIONS
(Continued)

6. An unrecorded lease with certain terms, covenants, conditions and provisions set forth therein as disclosed by the document

Entitled: Memorandum of Lease Agreement
Lessor: Santa Ana Arts, LLC, a Limited Liability Company
Lessee: County of Orange
Recording Date: April 8, 2004
Recording No: as [Instrument No. 2004000296921 of Official Records](#)

Assignment of the Lessor's interest under said lease,

Assignor: Santa Ana Arts, LLC, a California Limited Liability Company
Assignee: SIC/Leed 1015 Santa Ana, LLC, a Delaware Limited Liability Company
Recording Date: November 10, 2005
Recording No: as [Instrument No. 2005000907327 of Official Records](#)

The present ownership of the leasehold created by said lease and other matters affecting the interest of the lessee are not shown herein.

7. The Land described herein is included within a project area of the Redevelopment Agency shown below, and that proceedings for the redevelopment of said project have been instituted under the Redevelopment Law (such redevelopment to proceed only after the adoption of the Redevelopment Plan) as disclosed by a document.

Redevelopment Agency: Community Redevelopment Agency of the City of Santa Ana
Recording Date: October 20, 2004
Recording No: as [Instrument No. 2004000948360 of Official Records](#)

and Recording Date: December 20, 2007
and Recording No: as [Instrument No. 2007000744244 of Official Records](#)

8. Matters contained in that certain document

Entitled: Parking Easement Agreement
Dated: September 17, 2004
Executed by: Santa Ana Arts, LLC, a California Limited Liability Company and 801 North Main, LLC, a California Limited Liability Company
Recording Date: June 16, 2005
Recording No: as [Instrument No. 2005000463955 of Official Records](#)

Reference is hereby made to said document for full particulars.

EXCEPTIONS
(Continued)

9. A Deed of Trust to secure an indebtedness in the amount shown below,

Amount: \$19,524,000.00
Dated: November 10, 2005
Trustor/Grantor: SIC/Leed 1015 Santa Ana, LLC, a Delaware Limited Liability Company
Trustee: Ticor Title Company
Beneficiary: JPMorgan Chase Bank, N.A., a National Banking Association chartered under the laws of the United States of America
Loan No.: V-52748
Recording Date: November 10, 2005
Recording No: as [Instrument No. 2005000907324 of Official Records](#)

An agreement to modify the terms and provisions of said deed of trust as therein provided

Recording Date: May 26, 2010
Recording No: as [Instrument No. 2010000247728 of Official Records](#)

An agreement to modify the terms and provisions of said deed of trust as therein provided

Recording Date: June 10, 2015
Recording No: as [Instrument No. 2015000301402 of Official Records](#)

Matters contained in that certain document

Entitled: Financing Statement Continuation
Recording Date: July 14, 2020
Recording No: as [Instrument No. 2020000334227 of Official Records](#)

Reference is hereby made to said document for full particulars.

By various assignments, the beneficial interest thereunder is now held of record in:

Assignee: SUTHERLAND ASSET I, LLC, a Delaware limited liability company
Recording Date: June 21, 2021
Recording No: as [Instrument No. 2021000406007 of Official Records](#)

This Company will require that the original note, the original deed of trust and a properly executed request for full reconveyance together with appropriate documentation (i.e., copy of trust, partnership agreement or corporate resolution) be in this office prior to the close of this transaction if the above-mentioned item is to be paid through this transaction or deleted from a policy of title insurance.

Any demands submitted to us for payoff must be signed by all beneficiaries as shown on said deed of trust, and/or any assignments thereto. In the event said demand is submitted by an agent of the beneficiary(s), we will require the written approval of the demand by the beneficiary(s). Servicing agreements do not constitute approval for the purposes of this requirement.

If no amounts remain due under the obligation a zero balance demand will be required along with the reconveyance documents.

In addition, we require the written approval of said demand by the trustor(s) on said deed of trust or the current owners if applicable.

EXCEPTIONS
(Continued)

10. An assignment of all the moneys due, or to become due as rental, as additional security for the obligations secured by deed of trust shown as item no. 9

Assigned to: JPMorgan Chase Bank, N.A., a National Banking Association
Recording Date: November 10, 2005
Recording No: as [Instrument No. 2005000907325 of Official Records](#)

By various assignments, the beneficial interest thereunder is now held of record in:

Assignee: SUTHERLAND ASSET I, LLC, a Delaware limited liability company
Recording Date: June 21, 2021
Recording No: as [Instrument No. 2021000406008 of Official Records](#)

11. An unrecorded lease with certain terms, covenants, conditions and provisions set forth therein as disclosed by the document

Entitled: Assignment of Leases
Lessor: Santa Ana Arts, LLC, a California Limited Liability Company
Lessee: MCI Worldcom; Roberts Enterprises; Verizon Wireless and MPower Communications
Recording Date: November 10, 2005
Recording No: as [Instrument No. 2005000907327 of Official Records](#)

The present ownership of the leasehold created by said lease and other matters affecting the interest of the lessee are not shown herein.

12. An option to purchase said Land with certain terms, covenants, conditions and provisions as set forth therein.

Optionor: SIC/Leed 1015 Santa Ana, LLC, a Delaware Limited Liability Company
Optionee: Michael F. Harrah, an individual
Disclosed by: Option Agreement
Recording Date: November 10, 2005
Recording No: as [Instrument No. 2005000907328 of Official Records](#)

An agreement recorded November 10, 2005 as [Instrument No. 2005000907329 of Official Records](#) which states that this instrument was subordinated to the document or interest described in the instrument

Recording Date: November 10, 2005
Recording No.: as [Instrument No. 2005000907324 of Official Records](#)

13. Any rights of the parties in possession of a portion of, or all of, said Land, which rights are not disclosed by the public records.

The Company will require, for review, a full and complete copy of any unrecorded agreement, contract, license and/or lease, together with all supplements, assignments and amendments thereto, before issuing any policy of title insurance without excepting this item from coverage.

The Company reserves the right to except additional items and/or make additional requirements after reviewing said documents.

14. Discrepancies, conflicts in boundary lines, shortage in area, encroachments, or any other matters which a correct survey would disclose and which are not shown by the public records.

**EXCEPTIONS
(Continued)**

15. Any easements not disclosed by the public records as to matters affecting title to real property, whether or not said easements are visible and apparent.
16. Matters which may be disclosed by an inspection and/or by a correct ALTA/NSPS Land Title Survey of said Land that is satisfactory to the Company, and/or by inquiry of the parties in possession thereof.
17. Easement(s) for the purpose(s) shown below and rights incidental thereto, as granted in a document:

Granted to:	City of Santa Ana
Purpose:	Street Access
Recording Date:	December 23, 1949
Recording No:	in Book 1952, Page 143 of Official Records
Affects:	a portion of Parcel B

PLEASE REFER TO THE "INFORMATIONAL NOTES" AND "REQUIREMENTS" SECTIONS WHICH FOLLOW FOR INFORMATION NECESSARY TO COMPLETE THIS TRANSACTION.

END OF EXCEPTIONS

REQUIREMENTS SECTION

1. Prior to the close of escrow, the Company requires a Statement of Information to be completed by the following party(s),

Party(s): All Parties

The Company reserves the right to add additional items or make further requirements after review of the requested Statement of Information.

2. The Company will require the following documents for review prior to the issuance of any title insurance predicated upon a conveyance or encumbrance from the entity named below:

Limited Liability Company: SIC/LEED 1015 SANTA ANA, LLC

- a) A copy of its operating agreement, if any, and all amendments, supplements and/or modifications thereto, certified by the appropriate manager or member.
- b) If a domestic Limited Liability Company, a copy of its Articles of Organization and all amendments thereto with the appropriate filing stamps.
- c) If the Limited Liability Company is member-managed, a full and complete current list of members certified by the appropriate manager or member.
- d) A current dated certificate of good standing from the proper governmental authority of the state in which the entity is currently domiciled.
- e) If less than all members, or managers, as appropriate, will be executing the closing documents, furnish evidence of the authority of those signing.
- f) If Limited Liability Company is a Single Member Entity, a Statement of Information for the Single Member will be required.
- g) Each member and manager of the LLC without an Operating Agreement must execute in the presence of a notary public the Certificate of California LLC (Without an Operating Agreement) Status and Authority form.

3. Unrecorded matters which may be disclosed by an Owner's Affidavit or Declaration. A form of the Owner's Affidavit/Declaration is attached to this Preliminary Report/Commitment. This Affidavit/Declaration is to be completed by the record owner of the land and submitted for review prior to the closing of this transaction. Your prompt attention to this requirement will help avoid delays in the closing of this transaction. Thank you.

The Company reserves the right to add additional items or make further requirements after review of the requested Affidavit/Declaration.

4. This transaction requires high liability approval prior to close of escrow together with an inspection of the subject property.

Please advise title department with an estimated date that your transaction will close so we can schedule the necessary approvals and inspections.

5. Prior to the close of escrow and the issuance of an ALTA Coverage Policy, an inspection of the property will be required.

REQUIREMENTS
(Continued)

END OF REQUIREMENTS

INFORMATIONAL NOTES SECTION

1. Note: Property taxes, including any personal property taxes and any assessments collected with taxes, are paid. For proration purposes the amounts were:

Tax Identification No.: 398-023-01
Fiscal Year: 2023-2024
1st Installment: \$177,819.71
2nd Installment: \$177,819.71
Exemption: \$0.00
Code Area: 11-005

Affects: Parcels A and B

2. Note: Property taxes, including any personal property taxes and any assessments collected with taxes, are paid. For proration purposes the amounts were:

Tax Identification No.: 398-024-01
Fiscal Year: 2023-2024
1st Installment: \$1,199.66
2nd Installment: \$1,199.66
Exemption: \$0.00
Code Area: 11-003

Affects: Portion of Parcel C

3. Note: Property taxes, including any personal property taxes and any assessments collected with taxes, are paid. For proration purposes the amounts were:

Tax Identification No.: 398-024-02
Fiscal Year: 2023-2024
1st Installment: \$2,625.90
2nd Installment: \$2,625.90
Exemption: \$0.00
Code Area: 11-003

Affects: Portion of Parcel C

4. Note: Property taxes, including any personal property taxes and any assessments collected with taxes, are paid. For proration purposes the amounts were:

Tax Identification No.: 398-024-04
Fiscal Year: 2023-2024
1st Installment: \$2,116.53
2nd Installment: \$2,116.53
Exemption: \$0.00
Code Area: 11-003

Affects: Parcel D

INFORMATIONAL NOTES
(Continued)

5. Note: Property taxes, including any personal property taxes and any assessments collected with taxes, are paid. For proration purposes the amounts were:
- Tax Identification No.: 398-024-05
Fiscal Year: 2023-2024
1st Installment: \$4,183.13
2nd Installment: \$4,183.13
Exemption: \$0.00
Code Area: 11-003
- Affects: Parcel E
6. Note: Property taxes, including any personal property taxes and any assessments collected with taxes, are paid. For proration purposes the amounts were:
- Tax Identification No.: 398-024-06
Fiscal Year: 2023-2024
1st Installment: \$4,197.68
2nd Installment: \$4,197.68
Exemption: \$0.00
Code Area: 11-003
- Affects: Parcels F and G
7. Note: Property taxes, including any personal property taxes and any assessments collected with taxes, are paid. For proration purposes the amounts were:
- Tax Identification No.: 398-025-07
Fiscal Year: 2023-2024
1st Installment: \$2,429.44
2nd Installment: \$2,429.44
Exemption: \$0.00
Code Area: 11-003
- Affects: Parcel H
8. None of the items shown in this report will cause the Company to decline to attach CLTA Endorsement Form 100 to an Extended Coverage Loan Policy, when issued.
9. The Company is not aware of any matters which would cause it to decline to attach CLTA Endorsement Form 116 indicating that there is located on said Land Commercial properties, known as 1015 - 1055 North Main Street, located within the city of Santa Ana, California, , to an Extended Coverage Loan Policy.
10. Note: The policy of title insurance will include an arbitration provision. The Company or the insured may demand arbitration. Arbitrable matters may include, but are not limited to, any controversy or claim between the Company and the insured arising out of or relating to this policy, any service of the Company in connection with its issuance or the breach of a policy provision or other obligation. Please ask your escrow or title officer for a sample copy of the policy to be issued if you wish to review the arbitration provisions and any other provisions pertaining to your Title Insurance coverage.
11. Notice: Please be aware that due to the conflict between federal and state laws concerning the cultivation, distribution, manufacture or sale of marijuana, the Company is not able to close or insure any transaction involving Land that is associated with these activities.

INFORMATIONAL NOTES (Continued)

12. Pursuant to Government Code Section 27388.1, as amended and effective as of 1-1-2018, a Documentary Transfer Tax (DTT) Affidavit may be required to be completed and submitted with each document when DTT is being paid or when an exemption is being claimed from paying the tax. If a governmental agency is a party to the document, the form will not be required. DTT Affidavits may be available at a Tax Assessor-County Clerk-Recorder.
13. The following Exclusion(s) are added to preliminary reports, commitments and will be included as an endorsement in the following policies:
 - A. 2006 ALTA Owner's Policy (06-17-06).
 6. Defects, liens, encumbrances, adverse claims, notices, or other matters not appearing in the Public Records but that would be disclosed by an examination of any records maintained by or on behalf of a Tribe or on behalf of its members.
 - B. 2006 ALTA Loan Policy (06-17-06).
 8. Defects, liens, encumbrances, adverse claims, notices, or other matters not appearing in the Public Records but that would be disclosed by an examination of any records maintained by or on behalf of a Tribe or on behalf of its members.
 9. Any claim of invalidity, unenforceability, or lack of priority of the lien of the Insured Mortgage based on the application of a Tribe's law resulting from the failure of the Insured Mortgage to specify State law as the governing law with respect to the lien of the Insured Mortgage.
 - C. ALTA Homeowner's Policy of Title Insurance (12-02-13) and CLTA Homeowner's Policy of Title Insurance (12-02-13).
 10. Defects, liens, encumbrances, adverse claims, notices, or other matters not appearing in the Public Records but that would be disclosed by an examination of any records maintained by or on behalf of a Tribe or on behalf of its members.
 - D. ALTA Expanded Coverage Residential Loan Policy - Assessments Priority (04-02-15).
 12. Defects, liens, encumbrances, adverse claims, notices, or other matters not appearing in the Public Records but that would be disclosed by an examination of any records maintained by or on behalf of a Tribe or on behalf of its members.
 13. Any claim of invalidity, unenforceability, or lack of priority of the lien of the Insured Mortgage based on the application of a Tribe's law resulting from the failure of the Insured Mortgage to specify State law as the governing law with respect to the lien of the Insured Mortgage.
 - E. CLTA Standard Coverage Policy 1990 (11-09-18).
 7. Defects, liens, encumbrances, adverse claims, notices, or other matters not appearing in the public records but that would be disclosed by an examination of any records maintained by or on behalf of a tribe or on behalf of its members.
 8. Any claim of invalidity, unenforceability, or lack of priority of the lien of the insured mortgage based on the application of a tribe's law resulting from the failure of the insured mortgage to specify state law as the governing law with respect to the lien of the insured mortgage.
14. Note: There are NO conveyances affecting said Land recorded within 24 months of the date of this report.

INFORMATIONAL NOTES
(Continued)

END OF INFORMATIONAL NOTES

Andrew Margo (BS-RIV)/rpi

Wire Fraud Alert

This Notice is not intended to provide legal or professional advice. If you have any questions, please consult with a lawyer.

All parties to a real estate transaction are targets for wire fraud and many have lost hundreds of thousands of dollars because they simply relied on the wire instructions received via email, without further verification. **If funds are to be wired in conjunction with this real estate transaction, we strongly recommend verbal verification of wire instructions through a known, trusted phone number prior to sending funds.**

In addition, the following non-exclusive self-protection strategies are recommended to minimize exposure to possible wire fraud.

- **NEVER RELY** on emails purporting to change wire instructions. Parties to a transaction rarely change wire instructions in the course of a transaction.
- **ALWAYS VERIFY** wire instructions, specifically the ABA routing number and account number, by calling the party who sent the instructions to you. **DO NOT** use the phone number provided in the email containing the instructions, use phone numbers you have called before or can otherwise verify. **Obtain the phone number of relevant parties to the transaction as soon as an escrow account is opened.** **DO NOT** send an email to verify as the email address may be incorrect or the email may be intercepted by the fraudster.
- **USE COMPLEX EMAIL PASSWORDS** that employ a combination of mixed case, numbers, and symbols. Make your passwords greater than eight (8) characters. Also, change your password often and do **NOT** reuse the same password for other online accounts.
- **USE MULTI-FACTOR AUTHENTICATION** for email accounts. Your email provider or IT staff may have specific instructions on how to implement this feature.

For more information on wire-fraud scams or to report an incident, please refer to the following links:

Federal Bureau of Investigation:
<http://www.fbi.gov>

Internet Crime Complaint Center:
<http://www.ic3.gov>



Notice of Available Discounts

Pursuant to Section 2355.3 in Title 10 of the California Code of Regulations Fidelity National Financial, Inc. and its subsidiaries ("FNF") must deliver a notice of each discount available under our current rate filing along with the delivery of escrow instructions, a preliminary report or commitment. Please be aware that the provision of this notice does not constitute a waiver of the consumer's right to be charged the filed rate. As such, your transaction may not qualify for the below discounts.

You are encouraged to discuss the applicability of one or more of the below discounts with a Company representative. These discounts are generally described below; consult the rate manual for a full description of the terms, conditions and requirements for such discount. These discounts only apply to transactions involving services rendered by the FNF Family of Companies. This notice only applies to transactions involving property improved with a one-to-four family residential dwelling.

Not all discounts are offered by every FNF Company. The discount will only be applicable to the FNF Company as indicated by the named discount.

FNF Underwritten Title Company

CTC – Chicago Title company
CLTC – Commonwealth Land Title Company
FNTC – Fidelity National Title Company of California
FNTCCA - Fidelity National Title Company of California
TICOR – Ticor Title Company of California
LTC – Lawyer's Title Company
SLTC – ServiceLink Title Company

Underwritten by FNF Underwriters

CTIC – Chicago Title Insurance Company
CLTIC - Commonwealth Land Title Insurance Company
FNTIC – Fidelity National Title Insurance Company
CTIC – Chicago Title Insurance Company

Available Discounts

DISASTER LOANS (CTIC, CLTIC, FNTIC)

The charge for a Lender's Policy (Standard or Extended coverage) covering the financing or refinancing by an owner of record, within twenty-four (24) months of the date of a declaration of a disaster area by the government of the United States or the State of California on any land located in said area, which was partially or totally destroyed in the disaster, will be fifty percent (50%) of the appropriate title insurance rate.

CHURCHES OR CHARITABLE NON-PROFIT ORGANIZATIONS (CTIC, FNTIC)

On properties used as a church or for charitable purposes within the scope of the normal activities of such entities, provided said charge is normally the church's obligation the charge for an owner's policy shall be fifty percent (50%) to seventy percent (70%) of the appropriate title insurance rate, depending on the type of coverage selected. The charge for a lender's policy shall be forty (40%) to fifty percent (50%) of the appropriate title insurance rate, depending on the type of coverage selected.

MILITARY DISCOUNT RATE

Upon the Company being advised in writing and prior to the closing of the transaction that an active duty, honorably separated, or retired member of the United States Military or Military Reserves or National Guard is acquiring or selling an owner occupied one-to-four family property, the selling owner or acquiring buyer, as applicable, will be entitled to a discount equal to 15% of the otherwise applicable rates such party would be charged for title insurance policies.

Minimum charge: \$425.00

The Company may require appropriate proof of eligibility from the parties to the transaction verifying they are entitled to the discount as described. No other discounts or special rates, or combination of discounts or special rates, shall be applicable.

ATTACHMENT ONE

CALIFORNIA LAND TITLE ASSOCIATION STANDARD COVERAGE POLICY – 1990 (11-09-18)

EXCLUSIONS FROM COVERAGE

The following matters are expressly excluded from the coverage of this policy and the Company will not pay loss or damage, costs, attorneys' fees or expenses which arise by reason of:

1. (a) Any law, ordinance or governmental regulation (including but not limited to building or zoning laws, ordinances, or regulations) restricting, regulating, prohibiting or relating (i) the occupancy, use, or enjoyment of the land; (ii) the character, dimensions or location of any improvement now or hereafter erected on the land; (iii) a separation in ownership or a change in the dimensions or area of the land or any parcel of which the land is or was a part; or (iv) environmental protection, or the effect of any violation of these laws, ordinances or governmental regulations, except to the extent that a notice of the enforcement thereof or a notice of a defect, lien, or encumbrance resulting from a violation or alleged violation affecting the land has been recorded in the public records at Date of Policy.
- (b) Any governmental police power not excluded by (a) above, except to the extent that a notice of the exercise thereof or notice of a defect, lien or encumbrance resulting from a violation or alleged violation affecting the land has been recorded in the public records at Date of Policy.
2. Rights of eminent domain unless notice of the exercise thereof has been recorded in the public records at Date of Policy, but not excluding from coverage any taking which has occurred prior to Date of Policy which would be binding on the rights of a purchaser for value without knowledge.
3. Defects, liens, encumbrances, adverse claims or other matters:
 - (a) whether or not recorded in the public records at Date of Policy, but created, suffered, assumed or agreed to by the insured claimant;
 - (b) not known to the Company, not recorded in the public records at Date of Policy, but known to the insured claimant and not disclosed in writing to the Company by the insured claimant prior to the date the insured claimant became an insured under this policy;
 - (c) resulting in no loss or damage to the insured claimant;
 - (d) attaching or created subsequent to Date of Policy; or
 - (e) resulting in loss or damage which would not have been sustained if the insured claimant had paid value for the insured mortgage or for the estate or interest insured by this policy.
4. Unenforceability of the lien of the insured mortgage because of the inability or failure of the insured at Date of Policy, or the inability or failure of any subsequent owner of the indebtedness, to comply with the applicable doing business laws of the state in which the land is situated.
5. Invalidity or unenforceability of the lien of the insured mortgage, or claim thereof, which arises out of the transaction evidenced by the insured mortgage and is based upon usury or any consumer credit protection or truth in lending law.
6. Any claim, which arises out of the transaction vesting in the insured the estate of interest insured by this policy or the transaction creating the interest of the insured lender, by reason of the operation of federal bankruptcy, state insolvency or similar creditors' rights laws.

EXCEPTIONS FROM COVERAGE - SCHEDULE B, PART I

This policy does not insure against loss or damage (and the Company will not pay costs, attorneys' fees or expenses) which arise by reason of:

1. Taxes or assessments which are not shown as existing liens by the records of any taxing authority that levies taxes or assessments on real property or by the public records.
Proceedings by a public agency which may result in taxes or assessments, or notices of such proceedings, whether or not shown by the records of such agency or by the public records.
2. Any facts, rights, interests, or claims which are not shown by the public records but which could be ascertained by an inspection of the land or which may be asserted by persons in possession thereof.
3. Easements, liens or encumbrances, or claims thereof, not shown by the public records.
4. Discrepancies, conflicts in boundary lines, shortage in area, encroachments, or any other facts which a correct survey would disclose, and which are not shown by the public records.
5. (a) Unpatented mining claims; (b) reservations or exceptions in patents or in Acts authorizing the issuance thereof; (c) water rights, claims or title to water, whether or not the matters excepted under (a), (b) or (c) are shown by the public records.
6. Any lien or right to a lien for services, labor or material unless such lien is shown by the public records at Date of Policy.

EXCEPTIONS FROM COVERAGE - SCHEDULE B, PART II

(Variable exceptions such as taxes, easements, CC&R's, etc., are inserted here)

CALIFORNIA LAND TITLE ASSOCIATION STANDARD COVERAGE OWNER'S POLICY (02-04-22)

EXCLUSIONS FROM COVERAGE

The following matters are excluded from the coverage of this policy, and the Company will not pay loss or damage, costs, attorneys' fees, or expenses that arise by reason of:

1. a. any law, ordinance, permit, or governmental regulation (including those relating to building and zoning) that restricts, regulates, prohibits, or relates to:
 - i. the occupancy, use, or enjoyment of the Land;
 - ii. the character, dimensions, or location of any improvement on the Land;
 - iii. the subdivision of land; or
 - iv. environmental remediation or protection.
- b. any governmental forfeiture, police, regulatory, or national security power.
- c. the effect of a violation or enforcement of any matter excluded under Exclusion 1.a. or 1.b. Exclusion 1 does not modify or limit the coverage provided under Covered Risk 5 or 6.
2. Any power of eminent domain. Exclusion 2 does not modify or limit the coverage provided under Covered Risk 7.
3. Any defect, lien, encumbrance, adverse claim, or other matter:

- a. created, suffered, assumed, or agreed to by the Insured Claimant;
 - b. not Known to the Company, not recorded in the Public Records at the Date of Policy, but Known to the Insured Claimant and not disclosed in writing to the Company by the Insured Claimant prior to the date the Insured Claimant became an Insured under this policy;
 - c. resulting in no loss or damage to the Insured Claimant;
 - d. attaching or created subsequent to the Date of Policy (Exclusion 3.d. does not modify or limit the coverage provided under Covered Risk 9 or 10); or
 - e. resulting in loss or damage that would not have been sustained if consideration sufficient to qualify the Insured named in Schedule A as a bona fide purchaser had been given for the Title at the Date of Policy.
4. Any claim, by reason of the operation of federal bankruptcy, state insolvency, or similar creditors' rights law, that the transaction vesting the Title as shown in Schedule A is a:
 - a. fraudulent conveyance or fraudulent transfer;
 - b. voidable transfer under the Uniform Voidable Transactions Act; or
 - c. preferential transfer:
 - i. to the extent the instrument of transfer vesting the Title as shown in Schedule A is not a transfer made as a contemporaneous exchange for new value; or
 - ii. for any other reason not stated in Covered Risk 9.b.
 5. Any claim of a PACA-PSA Trust. Exclusion 5 does not modify or limit the coverage provided under Covered Risk 8.
 6. Any lien on the Title for real estate taxes or assessments imposed or collected by a governmental authority that becomes due and payable after the Date of Policy. Exclusion 6 does not modify or limit the coverage provided under Covered Risk 2.b.
 7. Any discrepancy in the quantity of the area, square footage, or acreage of the Land or of any improvement to the Land.

EXCEPTIONS FROM COVERAGE

Some historical land records contain Discriminatory Covenants that are illegal and unenforceable by law. This policy treats any Discriminatory Covenant in a document referenced in Schedule B as if each Discriminatory Covenant is redacted, repudiated, removed, and not republished or recirculated. Only the remaining provisions of the document are excepted from coverage.

This policy does not insure against loss or damage and the Company will not pay costs, attorneys' fees, or expenses resulting from the terms and conditions of any lease or easement identified in Schedule A, and the following matters:

PART I

1. (a) Taxes or assessments that are not shown as existing liens by the records of any taxing authority that levies taxes or assessments on real property or by the Public Records; (b) proceedings by a public agency that may result in taxes or assessments, or notices of such proceedings, whether or not shown by the records of such agency or by the Public Records.
2. Any facts, rights, interests, or claims that are not shown by the Public Records at Date of Policy but that could be (a) ascertained by an inspection of the Land, or (b) asserted by persons or parties in possession of the Land.
3. Easements, liens or encumbrances, or claims thereof, not shown by the Public Records at Date of Policy.
4. Any encroachment, encumbrance, violation, variation, easement, or adverse circumstance affecting the Title that would be disclosed by an accurate and complete land survey of the Land and not shown by the Public Records at Date of Policy.
5. (a) Unpatented mining claims; (b) reservations or exceptions in patents or in Acts authorizing the issuance thereof; (c) water rights, claims or title to water, whether or not the matters excepted under (a), (b), or (c) are shown by the Public Records.
6. Any lien or right to a lien for services, labor, material or equipment unless such lien is shown by the Public Records at Date of Policy.
7. Any claim to (a) ownership of or rights to minerals and similar substances, including but not limited to ores, metals, coal, lignite, oil, gas, uranium, clay, rock, sand, and gravel located in, on, or under the Land or produced from the Land, whether such ownership or rights arise by lease, grant, exception, conveyance, reservation, or otherwise; and (b) any rights, privileges, immunities, rights of way, and easements associated therewith or appurtenant thereto, whether or not the interests or rights excepted in (a) or (b) appear in the Public Records or are shown in Schedule B.

PART II

(Variable exceptions such as taxes, easements, CC&R's, etc., are inserted here)

CLTA/ALTA HOMEOWNER'S POLICY OF TITLE INSURANCE (07-01-2021)

EXCLUSIONS FROM COVERAGE

The following matters are excluded from the coverage of this policy and We will not pay loss or damage, costs, attorneys' fees, or expenses that arise by reason of:

1. a. any law, ordinance, permit, or governmental regulation (including those relating to building and zoning) that restricts, regulates, prohibits, or relates to:
 - i. the occupancy, use, or enjoyment of the Land;
 - ii. the character, dimensions, or location of any improvement on the Land;
 - iii. the subdivision of land; or
 - iv. environmental remediation or protection.
- b. any governmental forfeiture, police, or regulatory, or national security power.
- c. the effect of a violation or enforcement of any matter excluded under Exclusion 1.a. or 1.b. Exclusion 1 does not modify or limit the coverage provided under Covered Risk 8.a., 14, 15, 16, 18, 19, 20, 23, or 27.
2. Any power to take the Land by condemnation. Exclusion 2 does not modify or limit the coverage provided under Covered Risk 17.
3. Any defect, lien, encumbrance, adverse claim, or other matter:
 - a. created, suffered, assumed, or agreed to by You;
 - b. not Known to Us, not recorded in the Public Records at the Date of Policy, but Known to You and not disclosed in writing to Us by You prior to the date You became an Insured under this policy;
 - c. resulting in no loss or damage to You;

- d. attaching or created subsequent to the Date of Policy (Exclusion 3.d. does not modify or limit the coverage provided under Covered Risk 5, 8.f., 25, 26, 27, 28, or 32); or
 - e. resulting in loss or damage that would not have been sustained if You paid consideration sufficient to qualify You as a bona fide purchaser of the Title at the Date of Policy.
4. Lack of a right:
- a. to any land outside the area specifically described and referred to in Item 3 of Schedule A; and
 - b. in any street, road, avenue, alley, lane, right-of-way, body of water, or waterway that abut the Land.
- Exclusion 4 does not modify or limit the coverage provided under Covered Risk 11 or 21.
5. The failure of Your existing structures, or any portion of Your existing structures, to have been constructed before, on, or after the Date of Policy in accordance with applicable building codes. Exclusion 5 does not modify or limit the coverage provided under Covered Risk 14 or 15.
6. Any claim, by reason of the operation of federal bankruptcy, state insolvency, or similar creditors' rights law, that the transfer of the Title to You is a:
- a. fraudulent conveyance or fraudulent transfer;
 - b. voidable transfer under the Uniform Voidable Transactions Act; or
 - c. preferential transfer:
 - i. to the extent the instrument of transfer vesting the Title as shown in Schedule A is not a transfer made as a contemporaneous exchange for new value; or
 - ii. for any other reason not stated in Covered Risk 30.
7. Contamination, explosion, fire, flooding, vibration, fracturing, earthquake, or subsidence.
8. Negligence by a person or an entity exercising a right to extract or develop oil, gas, minerals, groundwater, or any other subsurface substance.
9. Any lien on Your Title for real estate taxes or assessments imposed or collected by a governmental authority that becomes due and payable after the Date of Policy. Exclusion 9 does not modify or limit the coverage provided under Covered Risk 8.a. or 27.
10. Any discrepancy in the quantity of the area, square footage, or acreage of the Land or of any improvement to the Land.

LIMITATIONS ON COVERED RISKS

Your insurance for the following Covered Risks is limited on the Owner's Coverage Statement as follows:

- For Covered Risk 16, 18, 19, and 21 Your Deductible Amount and Our Maximum Dollar Limit of Liability shown in Schedule A.

The deductible amounts and maximum dollar limits shown on Schedule A are as follows:

	<u>Your Deductible Amount</u>	<u>Our Maximum Dollar Limit of Liability</u>
Covered Risk 16:	1.00% of Policy Amount Shown in Schedule A or \$2,500.00 (whichever is less)	\$10,000.00
Covered Risk 18:	1.00% of Policy Amount Shown in Schedule A or \$5,000.00 (whichever is less)	\$25,000.00
Covered Risk 19:	1.00% of Policy Amount Shown in Schedule A or \$5,000.00 (whichever is less)	\$25,000.00
Covered Risk 21:	1.00% of Policy Amount Shown in Schedule A or \$2,500.00 (whichever is less)	\$5,000.00

CLTA/ALTA HOMEOWNER'S POLICY OF TITLE INSURANCE (12-02-13)

EXCLUSIONS

In addition to the Exceptions in Schedule B, You are not insured against loss, costs, attorneys' fees, and expenses resulting from:

1. Governmental police power, and the existence or violation of those portions of any law or government regulation concerning:
 - a. building;
 - b. zoning;
 - c. land use;
 - d. improvements on the Land;
 - e. land division; and
 - f. environmental protection.

This Exclusion does not limit the coverage described in Covered Risk 8.a., 14, 15, 16, 18, 19, 20, 23 or 27.
2. The failure of Your existing structures, or any part of them, to be constructed in accordance with applicable building codes. This Exclusion does not limit the coverage described in Covered Risk 14 or 15.
3. The right to take the Land by condemning it. This Exclusion does not limit the coverage described in Covered Risk 17.
4. Risks:
 - a. that are created, allowed, or agreed to by You, whether or not they are recorded in the Public Records;
 - b. that are Known to You at the Policy Date, but not to Us, unless they are recorded in the Public Records at the Policy Date;
 - c. that result in no loss to You; or
 - d. that first occur after the Policy Date - this does not limit the coverage described in Covered Risk 7, 8.e., 25, 26, 27 or 28.
5. Failure to pay value for Your Title.
6. Lack of a right:
 - a. to any land outside the area specifically described and referred to in paragraph 3 of Schedule A; and
 - b. in streets, alleys, or waterways that touch the Land.

This Exclusion does not limit the coverage described in Covered Risk 11 or 21.
7. The transfer of the Title to You is invalid as a preferential transfer or as a fraudulent transfer or conveyance under federal bankruptcy, state insolvency, or similar creditors' rights laws.
8. Contamination, explosion, fire, flooding, vibration, fracturing, earthquake, or subsidence.
9. Negligence by a person or an Entity exercising a right to extract or develop minerals, water, or any other substances.

LIMITATIONS ON COVERED RISKS

Your insurance for the following Covered Risks is limited on the Owner's Coverage Statement as follows:

- For Covered Risk 16, 18, 19, and 21 Your Deductible Amount and Our Maximum Dollar Limit of Liability shown in Schedule A.

The deductible amounts and maximum dollar limits shown on Schedule A are as follows:

Our Maximum Dollar

	<u>Your Deductible Amount</u>	<u>Limit of Liability</u>
Covered Risk 16:	1.00% of Policy Amount Shown in Schedule A or \$2,500.00 (whichever is less)	\$10,000.00
Covered Risk 18:	1.00% of Policy Amount Shown in Schedule A or \$5,000.00 (whichever is less)	\$25,000.00
Covered Risk 19:	1.00% of Policy Amount Shown in Schedule A or \$5,000.00 (whichever is less)	\$25,000.00
Covered Risk 21:	1.00% of Policy Amount Shown in Schedule A or \$2,500.00 (whichever is less)	\$5,000.00

ALTA OWNER'S POLICY (07-01-2021)

EXCLUSIONS FROM COVERAGE

The following matters are excluded from the coverage of this policy, and the Company will not pay loss or damage, costs, attorneys' fees, or expenses that arise by reason of:

1. a. any law, ordinance, permit, or governmental regulation (including those relating to building and zoning) that restricts, regulates, prohibits, or relates to:
 - i. the occupancy, use, or enjoyment of the Land;
 - ii. the character, dimensions, or location of any improvement on the Land;
 - iii. the subdivision of land; or
 - iv. environmental remediation or protection.
- b. any governmental forfeiture, police, regulatory, or national security power.
- c. the effect of a violation or enforcement of any matter excluded under Exclusion 1.a. or 1.b. Exclusion 1 does not modify or limit the coverage provided under Covered Risk 5 or 6.
2. Any power of eminent domain. Exclusion 2 does not modify or limit the coverage provided under Covered Risk 7.
3. Any defect, lien, encumbrance, adverse claim, or other matter:
 - a. created, suffered, assumed, or agreed to by the Insured Claimant;
 - b. not Known to the Company, not recorded in the Public Records at the Date of Policy, but Known to the Insured Claimant and not disclosed in writing to the Company by the Insured Claimant prior to the date the Insured Claimant became an Insured under this policy;
 - c. resulting in no loss or damage to the Insured Claimant;
 - d. attaching or created subsequent to the Date of Policy (Exclusion 3.d. does not modify or limit the coverage provided under Covered Risk 9 or 10); or
 - e. resulting in loss or damage that would not have been sustained if consideration sufficient to qualify the Insured named in Schedule A as a bona fide purchaser had been given for the Title at the Date of Policy.
4. Any claim, by reason of the operation of federal bankruptcy, state insolvency, or similar creditors' rights law, that the transaction vesting the Title as shown in Schedule A is a:
 - a. fraudulent conveyance or fraudulent transfer;
 - b. voidable transfer under the Uniform Voidable Transactions Act; or
 - c. preferential transfer:
 - i. to the extent the instrument of transfer vesting the Title as shown in Schedule A is not a transfer made as a contemporaneous exchange for new value; or
 - ii. for any other reason not stated in Covered Risk 9.b.
5. Any claim of a PACA-PSA Trust. Exclusion 5 does not modify or limit the coverage provided under Covered Risk 8.
6. Any lien on the Title for real estate taxes or assessments imposed or collected by a governmental authority that becomes due and payable after the Date of Policy. Exclusion 6 does not modify or limit the coverage provided under Covered Risk 2.b.
7. Any discrepancy in the quantity of the area, square footage, or acreage of the Land or of any improvement to the Land.

EXCEPTIONS FROM COVERAGE

Some historical land records contain Discriminatory Covenants that are illegal and unenforceable by law. This policy treats any Discriminatory Covenant in a document referenced in Schedule B as if each Discriminatory Covenant is redacted, repudiated, removed, and not republished or recirculated. Only the remaining provisions of the document are excepted from coverage.

This policy does not insure against loss or damage and the Company will not pay costs, attorneys' fees, or expenses resulting from the terms and conditions of any lease or easement identified in Schedule A, and the following matters:

NOTE: The 2021 ALTA Owner's Policy may be issued to afford either Standard Coverage or Extended Coverage. In addition to variable exceptions such as taxes, easements, CC&R's, etc., the Exceptions from Coverage in a Standard Coverage policy will also include the Western Regional Standard Coverage Exceptions listed as 1 through 7 below:

1. (a) Taxes or assessments that are not shown as existing liens by the records of any taxing authority that levies taxes or assessments on real property or by the Public Records; (b) proceedings by a public agency that may result in taxes or assessments, or notices of such proceedings, whether or not shown by the records of such agency or by the Public Records.
2. Any facts, rights, interests, or claims that are not shown by the Public Records at Date of Policy but that could be (a) ascertained by an inspection of the Land or (b) asserted by persons or parties in possession of the Land.
3. Easements, liens or encumbrances, or claims thereof, not shown by the Public Records at Date of Policy.
4. Any encroachment, encumbrance, violation, variation, easement, or adverse circumstance affecting the Title that would be disclosed by an accurate and complete land survey of the Land and not shown by the Public Records at Date of Policy.
5. (a) Unpatented mining claims; (b) reservations or exceptions in patents or in Acts authorizing the issuance thereof; (c) water rights, claims or title to water, whether or not the matters excepted under (a), (b), or (c) are shown by the Public Records.
6. Any lien or right to a lien for services, labor, material or equipment unless such lien is shown by the Public Records at Date of Policy.
7. Any claim to (a) ownership of or rights to minerals and similar substances, including but not limited to ores, metals, coal, lignite, oil, gas, uranium, clay, rock, sand, and gravel located in, on, or under the Land or produced from the Land, whether such ownership or rights arise by lease, grant, exception, conveyance, reservation, or otherwise; and (b) any rights, privileges, immunities, rights of way, and easements associated therewith or appurtenant thereto, whether or not the interests or rights excepted in (a) or (b) appear in the Public Records or are shown in Schedule B

2006 ALTA OWNER'S POLICY (06-17-06)

EXCLUSIONS FROM COVERAGE

The following matters are expressly excluded from the coverage of this policy, and the Company will not pay loss or damage, costs, attorneys' fees, or expenses that arise by reason of:

1. (a) Any law, ordinance, permit, or governmental regulation (including those relating to building and zoning) restricting, regulating, prohibiting, or relating to
 - (i) the occupancy, use, or enjoyment of the Land;
 - (ii) the character, dimensions, or location of any improvement erected on the Land;
 - (iii) the subdivision of land; or
 - (iv) environmental protection;or the effect of any violation of these laws, ordinances, or governmental regulations. This Exclusion 1(a) does not modify or limit the coverage provided under Covered Risk 5.
- (b) Any governmental police power. This Exclusion 1(b) does not modify or limit the coverage provided under Covered Risk 6.
2. Rights of eminent domain. This Exclusion does not modify or limit the coverage provided under Covered Risk 7 or 8.
3. Defects, liens, encumbrances, adverse claims, or other matters
 - (a) created, suffered, assumed, or agreed to by the Insured Claimant;
 - (b) not Known to the Company, not recorded in the Public Records at Date of Policy, but Known to the Insured Claimant and not disclosed in writing to the Company by the Insured Claimant prior to the date the Insured Claimant became an Insured under this policy;
 - (c) resulting in no loss or damage to the Insured Claimant;
 - (d) attaching or created subsequent to Date of Policy (however, this does not modify or limit the coverage provided under Covered Risk 9 and 10); or
 - (e) resulting in loss or damage that would not have been sustained if the Insured Claimant had paid value for the Title.
4. Any claim, by reason of the operation of federal bankruptcy, state insolvency, or similar creditors' rights laws, that the transaction vesting the Title as shown in Schedule A, is
 - (a) a fraudulent conveyance or fraudulent transfer; or
 - (b) a preferential transfer for any reason not stated in Covered Risk 9 of this policy.
5. Any lien on the Title for real estate taxes or assessments imposed by governmental authority and created or attaching between Date of Policy and the date of recording of the deed or other instrument of transfer in the Public Records that vests Title as shown in Schedule A.

EXCEPTIONS FROM COVERAGE

This policy does not insure against loss or damage, and the Company will not pay costs, attorneys' fees or expenses, that arise by reason of:

NOTE: The 2006 ALTA Owner's Policy may be issued to afford either Standard Coverage or Extended Coverage. In addition to variable exceptions such as taxes, easements, CC&R's, etc., the Exceptions from Coverage in a Standard Coverage policy will also include the Western Regional Standard Coverage Exceptions listed below as 1 through 7 below:

1. (a) Taxes or assessments that are not shown as existing liens by the records of any taxing authority that levies taxes or assessments on real property or by the Public Records; (b) proceedings by a public agency that may result in taxes or assessments, or notices of such proceedings, whether or not shown by the records of such agency or by the Public Records.
2. Any facts, rights, interests, or claims that are not shown by the Public Records at Date of Policy but that could be (a) ascertained by an inspection of the Land, or (b) asserted by persons or parties in possession of the Land.
3. Easements, liens or encumbrances, or claims thereof, not shown by the Public Records at Date of Policy.
4. Any encroachment, encumbrance, violation, variation, easement, or adverse circumstance affecting the Title that would be disclosed by an accurate and complete land survey of the Land and not shown by the Public Records at Date of Policy.
5. (a) Unpatented mining claims; (b) reservations or exceptions in patents or in Acts authorizing the issuance thereof; (c) water rights, claims or title to water, whether or not the matters excepted under (a), (b), or (c) are shown by the Public Records.
6. Any lien or right to a lien for services, labor, material or equipment unless such lien is shown by the Public Records at Date of Policy.
7. Any claim to (a) ownership of or rights to minerals and similar substances, including but not limited to ores, metals, coal, lignite, oil, gas, uranium, clay, rock, sand, and gravel located in, on, or under the Land or produced from the Land, whether such ownership or rights arise by lease, grant, exception, conveyance, reservation, or otherwise; and (b) any rights, privileges, immunities, rights of way, and easements associated therewith or appurtenant thereto, whether or not the interests or rights excepted in (a) or (b) appear in the Public Records or are shown in Schedule B.

POR. NW 1/4, SEC. 7, T 5 S, R 9 W

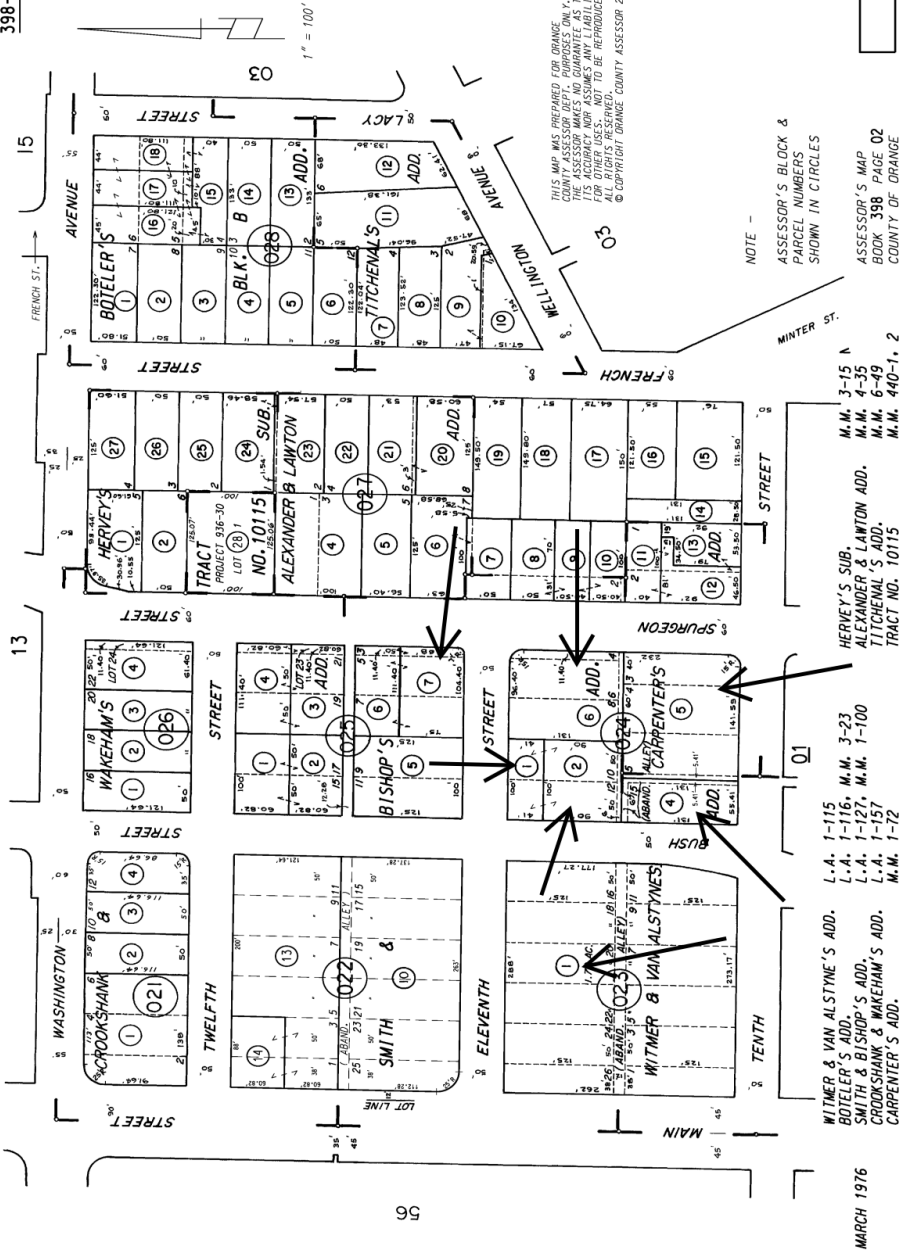

This map/plat is being furnished as an aid in locating the herein described Land in relation to adjoining streets, natural boundaries and other land, and is not a survey of the land depicted. Except to the extent a policy of title insurance is expressly modified by endorsement, if any, the Company does not insure dimensions, distances, location of easements, acreage or other matters shown thereon.

OWNER'S DECLARATION

Escrow No.: 30117638-989-989-BAM
Property Address: 1015 - 1055 North Main Street
Santa Ana, CA

The undersigned hereby declares as follows:

1. (Fill in the applicable paragraph and strike the other)
 - a. Declarant ("Owner") is the owner or lessee, as the case may be, of certain premises located at 1015 - 1055 North Main Street, Santa Ana, CA, further described as follows: See Preliminary Report/Commitment No. for full legal description (the "Land").
 - b. Declarant is the _____ of _____ ("Owner"), which is the owner or lessee, as the case may be, of certain premises located at 1015 - 1055 North Main Street, Santa Ana, CA, further described as follows: See Preliminary Report/Commitment No. for full legal description (the "Land").
2. (Fill in the applicable paragraph and strike the other)
 - a. During the period of six months immediately preceding the date of this declaration no work has been done, no surveys or architectural or engineering plans have been prepared, and no materials have been furnished in connection with the erection, equipment, repair, protection or removal of any building or other structure on the Land or in connection with the improvement of the Land in any manner whatsoever.
 - b. During the period of six months immediately preceding the date of this declaration certain work has been done and materials furnished in connection with _____ upon the Land in the approximate total sum of \$_____, but no work whatever remains to be done and no materials remain to be furnished to complete the construction in full compliance with the plans and specifications, nor are there any unpaid bills incurred for labor and materials used in making such improvements or repairs upon the Land, or for the services of architects, surveyors or engineers, except as follows: _____. Owner, by the undersigned Declarant, agrees to and does hereby indemnify and hold harmless Fidelity National Title Company against any and all claims arising therefrom.
3. Owner has not previously conveyed the Land; is not a debtor in bankruptcy (and if a partnership, the general partner thereof is not a debtor in bankruptcy); and has not received notice of any pending court action affecting the title to the Land.
4. Except as shown in the above-referenced Preliminary Report/Commitment, there are no unpaid or unsatisfied mortgages, deeds of trust, Uniform Commercial Code financing statements, regular assessments, special assessments, periodic assessments or any assessment from any source, claims of lien, special assessments, or taxes that constitute a lien against the Land or that affect the Land but have not been recorded in the public records. There are no violations of the covenants, conditions and restrictions as shown in the above-referenced Preliminary Report/Commitment.
5. The Land is currently in use as _____; _____ occupy/occupies the Land; and the following are all of the leases or other occupancy rights affecting the Land:

6. There are no other persons or entities that assert an ownership interest in the Land, nor are there unrecorded easements, claims of easement, or boundary disputes that affect the Land.
7. There are no outstanding options to purchase or rights of first refusal affecting the Land.
8. Between the most recent Effective Date of the above-referenced Preliminary Report/Commitment and the date of recording of the Insured Instrument(s), Owner has not taken or allowed, and will not take or allow, any action or inaction to encumber or otherwise affect title to the Land.

This declaration is made with the intention that Fidelity National Title Company (the "Company") and its policy issuing agents will rely upon it in issuing their title insurance policies and endorsements. Owner, by the undersigned Declarant, agrees to indemnify the Company against loss or damage (including attorneys fees, expenses, and costs) incurred by the Company as a result of any untrue statement made herein.

I declare under penalty of perjury that the foregoing is true and correct and that this declaration was executed on _____ at _____.

Signature: _____
Owner's Declaration
MISC0220 (DSI Rev. 10/17/17)

Printed: 6/27/2017 2:26 PM by RC2
Page 2

Escrow

