

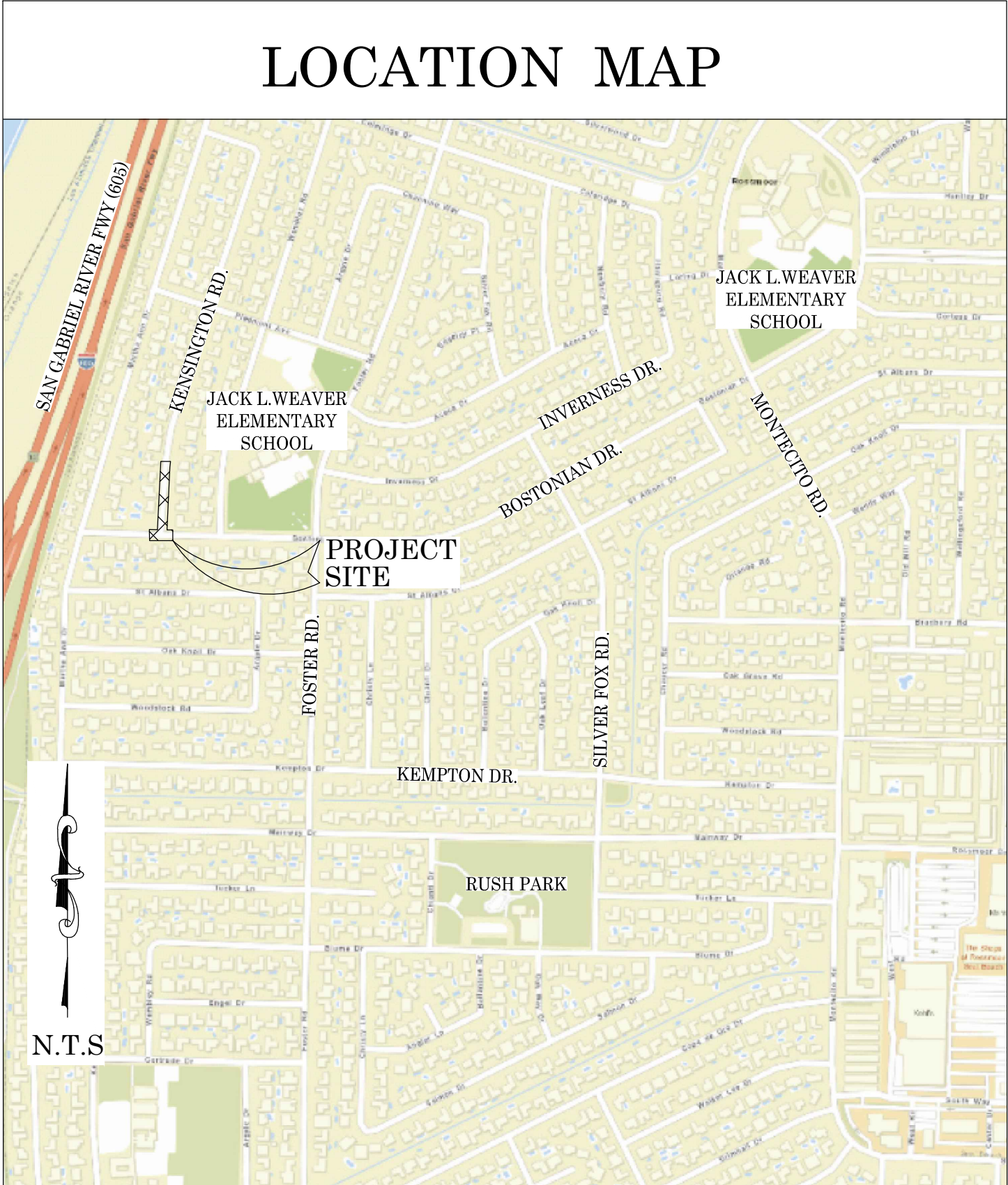

OC PUBLIC WORKS DEPARTMENT
JAMES TREADAWAY, DIRECTOR OF PUBLIC WORKS
KEVIN HILLS, COUNTY SURVEYOR
KENSINGTON RD
ROAD MAINTENANCE



FOUND CGPS "BLSA"
N: 2239164.39'
E: 6021324.82'
THIS IS A CONTINUOUS GPS STATION
(CGPS) AND IS PART OF THE CALIFORNIA
SPATIAL REFERENCE NETWORK (CSRN).
FROM WHICH DATA CAN BE DOWNLOADED
HERE: [HTTP://SOPACCSRC.UCSD.EDU/](http://SOPACCSRC.UCSD.EDU/).

FOUND CGPS "FVPK"
N: 2188769.57'
E: 6048756.25'
THIS IS A CONTINUOUS GPS STATION
(CGPS) AND IS PART OF THE CALIFORNIA
SPATIAL REFERENCE NETWORK (CSRN).
FROM WHICH DATA CAN BE DOWNLOADED
HERE: [HTTP://SOPACCSRC.UCSD.EDU/](http://SOPACCSRC.UCSD.EDU/).

BASIS OF BEARINGS

THE BASIS OF BEARINGS FOR THIS SURVEY IS BASED ON THE CALIFORNIA COORDINATE SYSTEM (CCS83), ZONE VI, NAD 83, OCS (2017.50) EPOCH ADJUSTMENT, AS DETERMINED LOCALLY BY A LINE BETWEEN CONTINUOUS GLOBAL POSITIONING STATIONS CGPS STATIONS (FVPK) AND (BLSA) BEING NORTH 28°33'39" WEST AS DERIVED FROM THE COORDINATES PUBLISHED BY THE CALIFORNIA SPATIAL REFERENCE CENTER (CSRC) ALONG WITH DATA SHEETS ON FILE IN THE OFFICE OF THE ORANGE COUNTY SURVEYOR.

HORIZONTAL DATUM

COORDINATES SHOWN ARE BASED ON THE CALIFORNIA COORDINATE SYSTEM (CCS83), ZONE VI, NAD 83, OCS (2017.50) EPOCH ADJUSTMENT.
ALL DISTANCES SHOWN ARE GRID, UNLESS OTHERWISE NOTED. TO OBTAIN GROUND DISTANCES MULTIPLY GRID BY A COMBINED FACTOR OF 1.00000933.
COMBINATION FACTOR WAS HELD AT: #4751
N: 2235868.88' E: 6003546.50' ELEVATION= 12.64'

VERTICAL DATUM

O.C.S. BM. 1A-144-04 ELEV. = 15.370' YEAR LEVELED: 2005
NAVD 1988 (O.C.S. 1995 ADJUSTMENT)
FOUND 3 3/4" OCS ALUMINUM BENCHMARK DISK STAMPED "1A-144-04", SET IN THE SOUTHWESTERLY CORNER OF A 4.4 FT. BY 4.4 FT. CONCRETE CATCH BASIN. MONUMENT IS LOCATED IN THE NORTHEASTERLY CORNER OF THE INTERSECTION OF SEAL BEACH BOULEVARD AND ST. CLOUD DRIVE, 44 FT. EASTERLY OF THE CENTERLINE OF SEAL BEACH BOULEVARD AND 58 FT. NORTHERLY OF THE CENTERLINE OF ST. CLOUD DR. MONUMENT IS SET LEVEL WITH THE SIDEWALK

NOTES

THE SURVEY INFORMATION SHOWN HEREON IS TO BE USED FOR TOPOGRAPHIC RELATIONSHIPS ONLY AND IS NOT INTENDED FOR LAND ACQUISITION OR BOUNDARY PURPOSES.
PARCELS SHOWN WITHOUT BEARING AND DISTANCES ARE FOR GRAPHICAL PURPOSES.

SHEET INDEX

SHEET	NO.	DESCRIPTION
1	1	TITLE SHEET
2	2	BOUNDARY
3,4	3,4	TOPOGRAPHIC MAP
5	5	PROFILE

PURPOSE OF SURVEY

THE PURPOSE OF THE SURVEY IS TO PROVIDE A TOPOGRAPHIC SURVEY ALONG THIS PORTION OF ROAD TO IDENTIFY LOW AND HIGH GRADE POINTS WITHIN ROAD CURB AND GUTTER FLOW LINE.

SENIOR LAND SURVEYOR'S CERTIFICATE:

THIS MAP CORRECTLY REPRESENTS A SURVEY MADE BY ME OR UNDER MY DIRECTION IN CONFORMANCE WITH REQUIREMENTS OF THE PROFESSIONAL LAND SURVEYOR'S ACT; ON THIS 15TH DAY OF MARCH, 2021.



MICHAEL KUBISTY, PLS. SENIOR LAND SURVEYOR

DEPUTY COUNTY SURVEYOR'S STATEMENT:

THIS MAP HAS BEEN EXAMINED IN ACCORDANCE WITH THE PROFESSIONAL LAND SURVEYOR'S ACT; ON THIS 10TH DAY 15TH DAY OF MARCH, 2021.



WADE WEAVER, PLS. DEPUTY COUNTY SURVEYOR

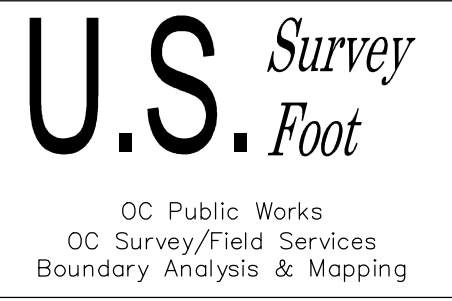

TOPOGRAPHIC MAPPING PROJECT

COUNTY OF ORANGE OC PUBLIC WORKS OC SURVEY/FIELD SERVICES/BOUNDARY ANALYSIS & MAPPING			
KENSINGTON RD ROAD MAINTENANCE			
TITLE SHEET			
PROJECT LIMITS: FROM 11922 KENSINGTON RD TO BOSTONIAN DR			
DATE OF SURVEY: 12/31/2020		BY: T. LOFGREEN & CREW	
MAPPING		BY: L. ISLAS	
OFFICE CHECK		BY: M. KUBISTY, PLS	
FIELD CHECK		BY: T. LOFGREEN	
SCALE: N.T.S.		W.O. #ER19202	FILE #1920PW-0P0026
FILE: KENSINGTON RD_TOPO_2020.DWG			
MARK	DATE	ITEM	SHEET NO.
REVISIONS			1 of 6

MONUMENT NOTES

(MONUMENTS ARE HYPERLINKED IN MONUMENT NOTES AND DRAWING)

- 1
- FOUND SPIKE AND' WASHER STAMPED "O.C.S." PER (R4), FLUSH IN AC. ACCEPTED AS THE CENTERLINE INTERSECTION OF PIEDMONT AVE. AND WEMBLEY RD.
- 2
- FOUND CHISELED "+" NO REFERENCE, FLUSH IN T.C. ACCEPTED AS NW'LY TANGENT OVER TIE TO CENTERLINE E.C OF KENSINGTON DR.
- 3
- FOUND CHISELED "+" NO REFERENCE, FLUSH IN T.C. ACCEPTED AS SE'LY TANGENT OVER TIE TO CENTERLINE E.C OF KENSINGTON DR.
- 4
- FOUND LEAD, TACK AND TAG STAMPED "LS 2383", PER (R1), FLUSH IN T.C. ACCEPTED AS 11.75' OFFSET TO THE NW'LY RIGHT OF WAY AND A CALCULATED 18.25' OFFSET TO THE CENTERLINE OF KENSINGTON RD. PER (R1).
- 5
- FOUND LEAD, TACK AND TAG STAMPED "LS 2383", PER (R1), FLUSH IN T.C. ACCEPTED AS 11.75' OFFSET TO THE SE'LY RIGHT OF WAY AND A CALCULATED 18.25' OFFSET TO THE CENTERLINE OF KENSINGTON RD. PER (R1).
- 6
- FOUND LEAD, TACK AND TAG STAMPED "LS 2383", PER (R1), FLUSH IN T.C. ACCEPTED AS 11.75' OFFSET TO THE NW'LY RIGHT OF WAY AND A CALCULATED 18.25' OFFSET TO THE CENTERLINE OF KENSINGTON RD. PER (R1).
- 7
- FOUND LEAD, TACK AND TAG STAMPED "LS 2383", PER (R1), FLUSH IN T.C. ACCEPTED AS 11.75' OFFSET TO THE NW'LY RIGHT OF WAY AND A CALCULATED 18.25' OFFSET TO THE CENTERLINE OF KENSINGTON RD. PER (R1).
- 8
- FOUND LEAD, TACK AND TAG STAMPED "LS 2383", PER (R1), FLUSH IN T.C. ACCEPTED AS 11.75' OFFSET TO THE NW'LY RIGHT OF WAY AND A CALCULATED 18.25' OFFSET TO THE CENTERLINE OF KENSINGTON RD. PER (R1).
- 9
- FOUND NAIL SHAFT IN LIEU OF LEAD, TACK AND TAG STAMPED "LS 2383", PER (R1), FLUSH IN T.C. N72°20'17"W 0.06' FROM 11.75' OFFSET TO THE SE'LY RIGHT OF WAY OF KENSINGTON RD. PER (R1).
- 10
- FOUND NAIL SHAFT IN LIEU OF LEAD, TACK AND TAG STAMPED "LS 2383", PER (R1), FLUSH IN T.C. S72°20'17"E 0.07' FROM 11.75' OFFSET TO THE SE'LY RIGHT OF WAY OF KENSINGTON RD. PER (R1).
- 11
- FOUND NAIL SHAFT IN LIEU OF LEAD, TACK AND TAG STAMPED "LS 2383", PER (R1), FLUSH IN T.C. N74°19'28"W 0.16' FROM 11.75' OFFSET TO THE SE'LY RIGHT OF WAY OF KENSINGTON RD. PER (R1).
- 12
- FOUND NAIL HOLE IN LEAD IN LIEU OF LEAD, TACK AND TAG STAMPED "LS 2383" PER (R1), FLUSH IN T.C. S76°42'02"E 0.11' FROM 11.75' OFFSET TO THE SE'LY RIGHT OF WAY OF KENSINGTON RD. PER (R1).
- 13
- FOUND LEAD, TACK AND TAG STAMPED "LS 2383", PER (R1), FLUSH IN T.C. ACCEPTED AS 11.75' OFFSET TO THE NW'LY RIGHT OF WAY AND A CALCULATED 18.25' OFFSET TO THE CENTERLINE OF KENSINGTON RD. PER (R1).
- 14
- FOUND LEAD, TACK AND TAG STAMPED "LS 2383", PER (R1), FLUSH IN T.C. ACCEPTED AS THE 11.75' OFFSET TO THE NW'LY RIGHT OF WAY OF KENSINGTON RD. PER (R1).
- 15
- FOUND LEAD, TACK AND TAG STAMPED "LS 2383", PER (R1), FLUSH IN T.C. N79°04'26"W 0.08' FROM 11.75' OFFSET TO THE SE'LY RIGHT OF WAY OF KENSINGTON RD. PER (R1).
- 16
- FOUND LEAD, TACK AND TAG STAMPED "LS 2383", PER (R1), FLUSH IN T.C. ACCEPTED AS 11.75' OFFSET TO THE SE'LY RIGHT OF WAY AND A CALCULATED 18.25' OFFSET TO THE CENTERLINE OF KENSINGTON RD. PER (R1).
- 17
- FOUND LEAD, TACK AND TAG STAMPED "LS 2383", PER (R1), FLUSH IN T.C. ACCEPTED AS 11.75' OFFSET TO THE W'LY RIGHT OF WAY AND A CALCULATED 18.25' OFFSET TO THE CENTERLINE OF KENSINGTON RD. PER (R1).
- 18
- FOUND LEAD, TACK AND TAG STAMPED "LS 2383", PER (R1), FLUSH IN T.C. N83°48'41"W 0.10' FROM 11.75' OFFSET TO THE W'LY RIGHT OF WAY OF KENSINGTON RD. PER (R1).
- 19
- FOUND LEAD, TACK AND TAG STAMPED "LS 2383", PER (R1), FLUSH IN T.C. ACCEPTED AS 11.75' OFFSET TO THE W'LY RIGHT OF WAY AND A CALCULATED 18.25' OFFSET TO THE CENTERLINE OF KENSINGTON RD. PER (R1).
- 20
- FOUND LEAD, TACK AND TAG STAMPED "LS 2383", PER (R1), FLUSH IN T.C. ACCEPTED AS 11.75' OFFSET TO THE E'LY RIGHT OF WAY AND A CALCULATED 18.25' OFFSET TO THE CENTERLINE OF KENSINGTON RD. PER (R1).
- 21
- FOUND LEAD AND TACK, NO REF. FLUSH IN T.C. ACCEPTED AS 11.75' OFFSET TO THE S'LY RIGHT OF WAY AND A CALCULATED 18.25' OFFSET TO THE CENTERLINE OF BOSTONIAN DR.
- 22
- FOUND LEAD, TACK AND TAG STAMPED "LS 4640", NO REF. IN LIEU OF "LS 2383" PER (R6), FLUSH IN T.C. ACCEPTED AS 1.00' OFFSET TO THE S'LY RIGHT OF WAY OF BOSTONIAN DR. PER (R6).
- 23
- FOUND C-NAIL IN LEAD NO REF. FLUSH IN T.C. ACCEPTED AS 11.75' OFFSET TO THE S'LY RIGHT OF WAY AND A CALCULATED 18.25' OFFSET TO THE CENTERLINE OF BOSTONIAN DR.
- 24
- FOUND LEAD, TACK AND TAG NO STAMPING (NO REF.) WITH CHISELED "+" UNDERNEATH PER (R2), FLUSH IN T.C. ACCEPTED AS W'LY PROD OF THE CENTERLINE OF BOSTONIAN DR. PER (R2).
- 25
- FOUND C-NAIL IN LEAD IN LIEU OF TACK AND TAG STAMPED "LS 2383", PER (R1), FLUSH IN T.C. N01°13'17"E 0.09' FROM 11.75' OFFSET TO THE N'LY RIGHT OF WAY OF BOSTONIAN DR. PER (R1).
- 26
- FOUND PK NAIL AS SHOWN BY (R8) IN LIEU OF SPIKE AND WASHER STAMPED "LS 5282" TO BE SET PER (R8), FLUSH IN AC. ACCEPTED AS THE CENTERLINE INTERSECTION OF MARTHA ANN DR. AND WOODSTOCK RD.
- 27
- FOUND CHISELED "+" NO REFERENCE, IN T.C. ACCEPTED AS 11.75' OFFSET TO THE E'LY RIGHT OF WAY AND A CALCULATED 18.25' OFFSET TO THE CENTERLINE OF MARTHA ANN DR. PER (R5).
- 28
- FOUND CHISELED "+" NO REFERENCE, IN T.C. ACCEPTED AS 11.75' OFFSET TO THE E'LY RIGHT OF WAY AND A CALCULATED 18.25' OFFSET TO THE CENTERLINE OF MARTHA ANN DR. PER (R5).
- 29
- FOUND PK NAIL WITH WASHER STAMPED "O.C.S." PER (R2), FLUSH IN AC. ACCEPTED AS THE CENTERLINE INTERSECTION OF ARGYLE DR. AND WOODSTOCK RD.
- 30
- FOUND LEAD, TACK AND TAG STAMPED "O.C.S. TIE" PER (R3), FLUSH IN T.C. ACCEPTED AS TIES FOR THE CENTERLINE INTERSECTION OF MARTHA ANN DR. AND PIEDMONT AVE.
- 31
- FOUND LEAD, TACK AND TAG STAMPED LS 2383" PER (R3), FLUSH IN T.C. ACCEPTED AS TIES FOR THE CENTERLINE INTERSECTION OF MARTHA ANN DR. AND PIEDMONT AVE.

ESTABLISHMENT NOTES

- A
- ESTABLISHED THE CENTERLINE INTERSECTION OF MARTHA ANN DR. AND PIEDMONT AVE. BY TIES PER (R3).
- B
- ESTABLISHED THE CENTERLINE OF PIEDMONT AVE. BY A LINE BETWEEN ESTABLISHMENT [A](#) AND MONUMENT [1](#) PER (R1).
- C
- SEARCHED FOUND NOTHING, ESTABLISHED THE CENTERLINE E.C. OF KENSINGTON RD. HOLDING THE MIDPOINT OF A LINE BETWEEN MONUMENTS [2](#) AND [3](#)
- D
- ESTABLISHED 11.75' OFFSET LINE TO THE NW'LY RIGHT OF WAY OF KENSINGTON DR. PER (R1), HOLDING MONUMENTS [2](#) AND [4](#)
- E
- SEARCHED FOUND NOTHING, ESTABLISHED POINT ON CENTERLINE KENSINGTON RD. HOLDING A CALCULATED RECORD OFFSET DISTANCE OF 18.25' PER (R1), PERPENDICULAR TO LINE ESTABLISHMENT [D](#) AT MONUMENT [4](#)
- F
- ESTABLISHED THE CENTERLINE OF KENSINGTON RD. BY HOLDING A LINE BETWEEN ESTABLISHMENTS [C](#) AND [E](#)
- G
- SEARCHED FOUND NOTHING, ESTABLISHED THE CENTERLINE INTERSECTION OF PIEDMONT AVE. AND KENSINGTON RD. BY THE INTERSECTION OF LINE ESTABLISHMENTS [B](#) AND [F](#)
- H
- ESTABLISHED 11.75' OFFSET LINE PER (R1) HOLDING A LINE BETWEEN MONUMENTS [2](#) AND [3](#)
- I
- ESTABLISHED A POINT ON CENTERLINE OF BOSTONIAN DR. HOLDING A CALCULATED RECORD OFFSET DISTANCE OF 29.00' PER (R6), N'LY OF AND PERPENDICULAR TO THE E'LY PROLONGATION OF LINE ESTABLISHMENT [H](#) AT MONUMENT [22](#)
- J
- ESTABLISHED THE CENTERLINE OF BOSTONIAN DR. BY A LINE BETWEEN ESTABLISHMENT [I](#) AND MONUMENT [24](#) FITS MONUMENTS [21](#) AND [23](#) FOR CALCULATED 18.25' OFFSET NO REF TO CENTERLINE, AND THE SPLIT OF EXISTING CONCRETE CURBS.
- K
- SEARCHED FOUND NOTHING, ESTABLISHED A POINT ON CENTERLINE OF KENSINGTON RD. HOLDING THE MIDPOINT OF A LINE BETWEEN MONUMENTS [19](#) AND [20](#)
- L
- ESTABLISHED THE CENTERLINE OF KENSINGTON RD. BY HOLDING RECORD CURVE DATA PER (R1), AND TANGENT TO LINE ESTABLISHMENT [F](#)
- M
- ESTABLISHED THE CENTERLINE B.C. OF KENSINGTON RD. BY HOLDING RECORD CURVATURE INFORMATION PER (R1), S'LY FROM ESTABLISHMENT [F](#) AND TANGENT TO ESTABLISHMENT [F](#)
- N
- ESTABLISHED THE CENTERLINE OF KENSINGTON RD. BY HOLDING A LINE S'LY FROM ESTABLISHMENT [M](#) THROUGH ESTABLISHMENT [K](#) TO IT'S INTERSECTION WITH LINE ESTABLISHMENT [J](#)
- O
- SEARCHED FOUND NOTHING, ESTABLISHED THE CENTERLINE INTERSECTION OF BOSTONIAN DR. AND KENSINGTON RD. BY INTERSECTING LINE ESTABLISHMENTS [J](#) AND [N](#)
- P
- ESTABLISHED THE W'LY RIGHT OF WAY OF KENSINGTON DR. BY HOLDING RECORD DISTANCE OF 30' PER (R1), W'LY OF, PARALLEL AND CONCENTRIC WITH THE ESTABLISHED CENTERLINE OF KENSINGTON RD.
- Q
- ESTABLISHED THE E'LY RIGHT OF WAY OF KENSINGTON DR. BY HOLDING RECORD DISTANCE OF 30' PER (R1), E'LY OF, PARALLEL AND CONCENTRIC WITH THE ESTABLISHED CENTERLINE OF KENSINGTON RD.
- R
- ESTABLISHED THE N'LY RIGHT OF WAY OF BOSTONIAN DR. BY HOLDING RECORD DISTANCE OF 30' PER (R1), N'LY OF AND PARALLEL WITH ESTABLISHMENT [J](#)
- S
- ESTABLISHED THE NE'LY RIGHT OF WAY OF KENSINGTON AND BOSTONIAN RD. BY HOLDING A RECORD RADIUS OF 13' PER (R1), AND TANGENT TO LINE ESTABLISHMENTS [Q](#) AND [R](#)
- T
- ESTABLISHED THE NW'LY RIGHT OF WAY OF KENSINGTON AND BOSTONIAN RD. BY HOLDING A RECORD RADIUS OF 13' PER (R1), AND TANGENT TO LINE ESTABLISHMENTS [P](#) AND [R](#)
- U
- SEARCHED FOUND NOTHING, ESTABLISHED THE CENTERLINE B.C. OF MARTHA ANN DR. BY HOLDING A LINE W'LY FROM MONUMENT [27](#) AND PERPENDICULAR TO MON [28](#)
- V
- ESTABLISHED THE CENTERLINE OF MARTHA ANN DR. BY HOLDING A LINE BETWEEN MONUMENT [28](#) AND ESTABLISHMENT [U](#)
- W
- ESTABLISHED THE CENTERLINE OF MARTHA ANN DR. BY HOLDING RECORD RADIUS PER (R1), AND TANGENT TO ESTABLISHMENT [U](#)
- X
- SEARCHED FOUND NOTHING, ESTABLISHED THE CENTERLINE E.C. OF MARTHA ANN DR. BY HOLDING A LINE SE'LY FROM MONUMENT [28](#) AND RADIAL TO ESTABLISHMENT [W](#)
- Y
- ESTABLISHED THE CENTERLINE OF MARTHA ANN DR. BY HOLDING A LINE TANGENT TO ESTABLISHMENT [W](#) NE'LY FROM ESTABLISHMENT [X](#)
- Z
- ESTABLISHED THE CENTERLINE INTERSECTION OF MARTHA ANN DR. AND BOSTONIAN DR. BY THE INTERSECTION OF LINE ESTABLISHMENTS [J](#) AND [Y](#)

REFERENCES

(REFERENCED DOCUMENTS ARE HYPERLINKED)

- (R1) = TRACT NO. 3225, M.M. 100/1-5
- (R2) = O.C.S. ALIGNMENT NOTE A/4-11,12 PGS. 1302-1341
- (R3) = CORNER RECORD, C.R. 2020-2857
- (R4) = CORNER RECORD, C.R. 2020-2856
- (R5) = TRACT NO. 3189, M.M. 96/5-12
- (R6) = RECORD OF SURVEY OF TRACT 3189, R.S.B. 39/23-24
- (R7) = CORNER RECORD, C.R. 2020-2825
- (R8) = RECORD OF SURVEY 2009-1076, R.S.B. 286/1-40

SEE SHEET 5

APN 086-392-13
11931 KENSINGTON

CP# 4775
FD LEAD TACK
AND TAG STAMPED LS
2383 FLUSH IN TC
N: 2235653.11'
E: 6003491.15'
EL: 12.36'

APN 086-392-14
11941 KENSINGTON

APN 086-392-15
11961 KENSINGTON

APN 086-391-17
11932 KENSINGTON

APN 086-391-16
11942 KENSINGTON

APN 086-391-15
11962 KENSINGTON

APN 086-402-05
2682 BOSTONIAN DR

APN 086-402-06
2702 BOSTONIAN DR

APN 086-402-07
2712 BOSTONIAN DR

LEGEND

SYMBOL

- △ Control Point
- ⊙ Fire Hydrant
- ⊙ Manhole Sewer
- ⊙ Meter Water
- ⊙ Pilaster
- ⊙ Pipe Inlet/Outlet
- ⊙ Sign Post
- ⊙ Tree
- ⊙ Valve Gas
- ⊙ Valve Water

ABBREVIATION

- BC Beginning of Curve
- CL Centerline
- CLR Clearance
- CONC Concrete
- CP Control Point
- DIA Diameter
- DWY Driveway
- EL Elevation
- ENC Encroachment
- EC End of Curve
- FD Found
- INV Invert
- STA Station
- TC Top of Curb

AREA PATTERN KEY

- Concrete
- Brick
- Dirt
- Grass
- Stone

LINE PATTERN KEY

- Block Wall
- Centerline
- Edge of Concrete
- Edge of Asphalt
- Pavement
- Flowline
- Right of Way

U.S. Survey
Foot

OC Public Works
OC Survey/Field Services
Boundary Analysis & Mapping

COUNTY OF ORANGE
OC PUBLIC WORKS
OC SURVEY/FIELD SERVICES/BOUNDARY ANALYSIS & MAPPING

KENSINGTON RD ROAD MAINTENANCE

TOPOGRAPHIC MAP

PROJECT LIMITS: FROM 11922 KENSINGTON RD TO BOSTONIAN DR

DATE OF SURVEY: 12/31/2020 BY: T. LOFGREEN & CREW

MAPPING BY: I. ISLAS

OFFICE CHECK BY: M. KUBISTY, PLS

FIELD CHECK BY: T. LOFGREEN

SCALE: 1" = 20' W.O. #ER19202 FILE #1920PW-OP0026

FILE: KENSINGTON_RD_TOPO_2020.DWG

SHEET NO.

4

of

6

REVISIONS

0' 5' 10' 20' 30'

SCALE: 1" = 10'
CONTOUR INTERVAL 0.2'

LEGEND

- SYMBOL
- Control Point
 - Fire Hydrant
 - Manhole Sewer
 - Meter Water
 - Pilaster
 - Pipe Inlet/Outlet
 - Sign Post
 - Tree
 - Valve Gas
 - Valve Water

- ABBREVIATION
- BC Beginning of Curve
 - CL Centerline
 - CLR Clearance
 - CONC Concrete
 - CP Control Point
 - DIA Diameter
 - DWY Driveway
 - EL Elevation
 - ENC Encroachment
 - EC End of Curve
 - FD Found
 - INV Invert
 - STA Station
 - TC Top of Curb

- AREA PATTERN KEY
- Concrete
 - Brick
 - Dirt
 - Grass
 - Stone

- LINE PATTERN KEY
- Block Wall
 - Centerline
 - Edge of Concrete
 - Edge of Asphalt Pavement
 - Flowline
 - Right of Way

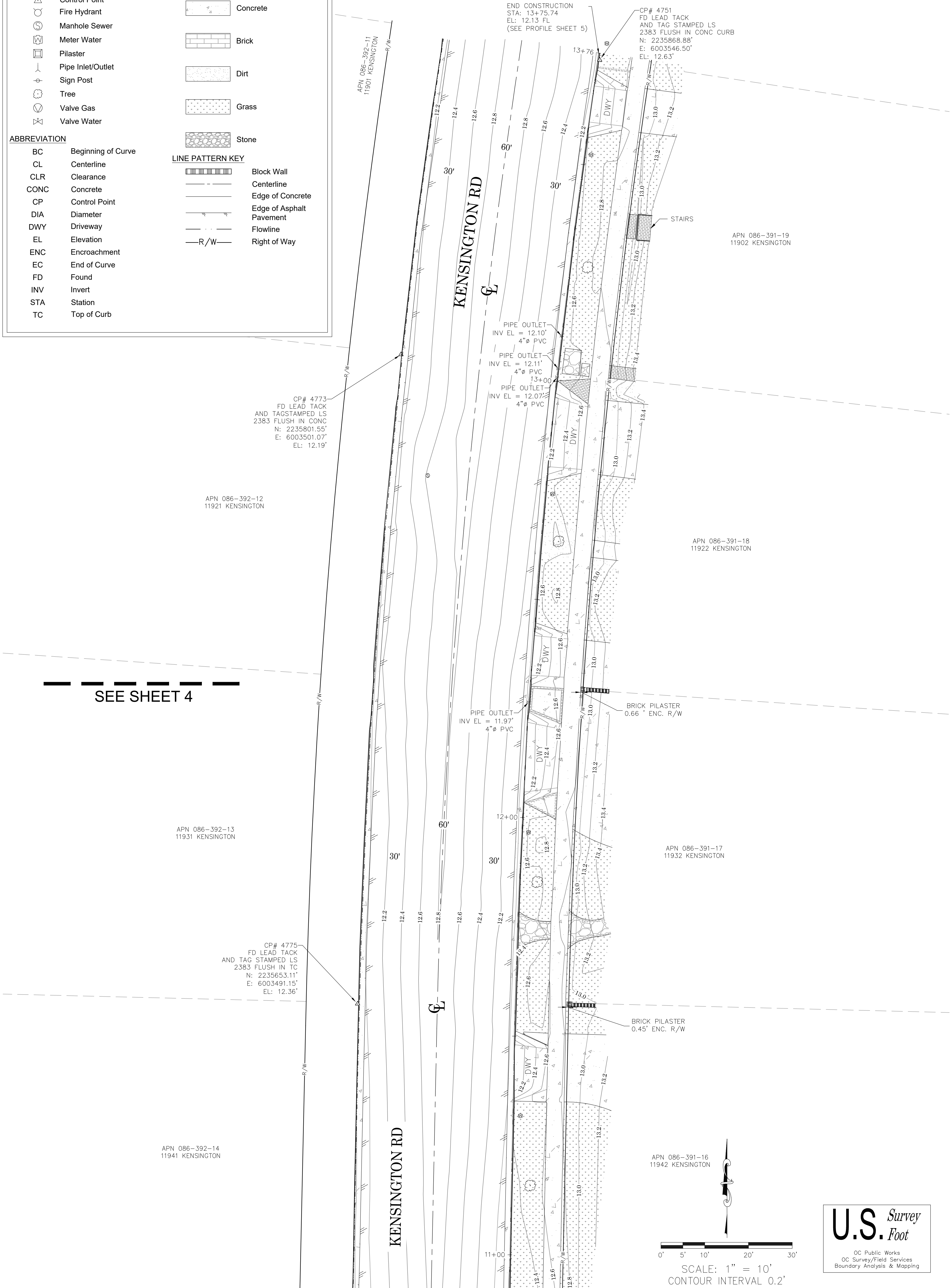

<div>MARK</div> <div>DATE</div> <div>ITEM</div> <div>REVISIONS</div>		COUNTY OF ORANGE OC PUBLIC WORKS OC SURVEY/FIELD SERVICES/BOUNDARY ANALYSIS & MAPPING				
		KENSINGTON RD ROAD MAINTENANCE				
		TOPOGRAPHIC MAP				
		PROJECT LIMITS: FROM 11922 KENSINGTON RD TO BOSTONIAN DR				
		DATE OF SURVEY:12/31/2020		BY:T. LOFGREEN & CREW		SHEET NO. 5 of 6
		MAPPING		BY:I. ISLAS		
		OFFICE CHECK		BY:M. KUBISTY, PLS		
		FIELD CHECK		BY:T. LOFGREEN		
		SCALE:1"=20'		W.O. #ER19202		
		FILE:KENSINGTON RD_TOPO_2020.DWG				

PROFILE OF THE EXISTING E'LY CONCRETE FLOWLINE OF
KENSINGTON RD

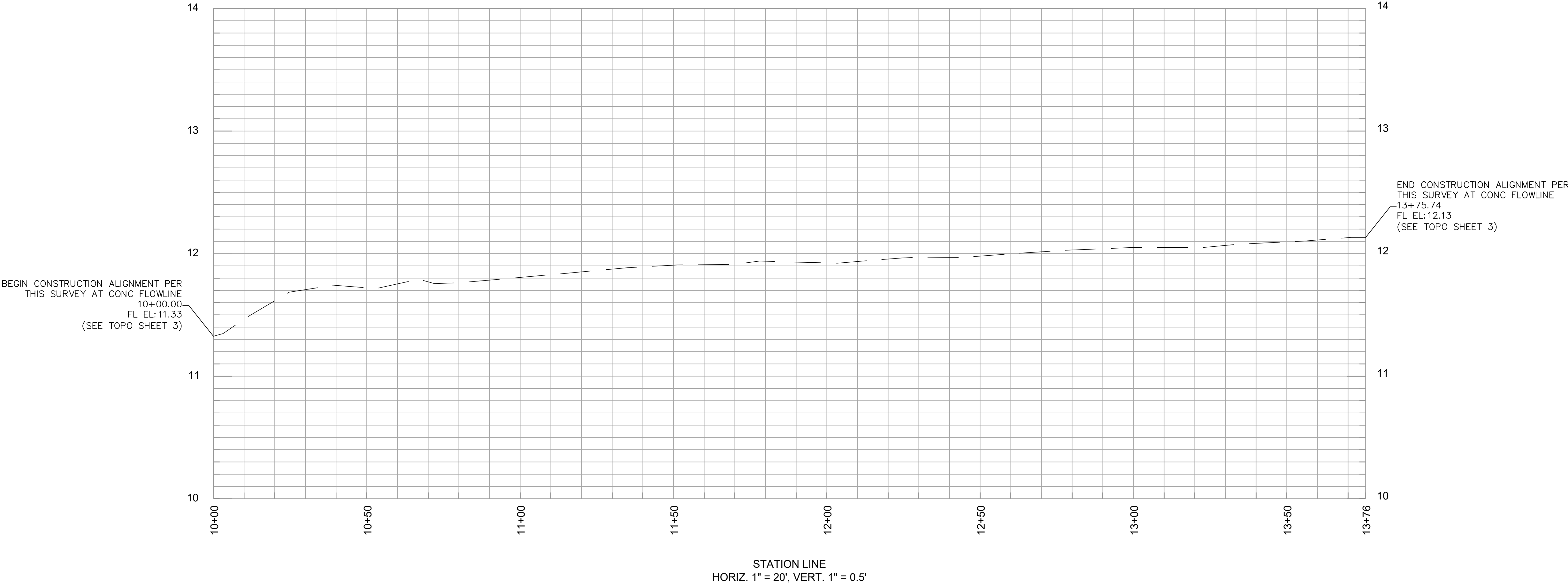

NOTE: THE ALIGNMENT FOR THIS PROFILE WAS DEVELOPED HOLDING A STATION OF 10+00 AT THE S'LY END OF THE EXISTING CONCRETE FLOWLINE ON THE E'LY SIDE OF KENSINGTON RD AND INCREASING NE'LY AS SHOWN ON SHEETS 3,4

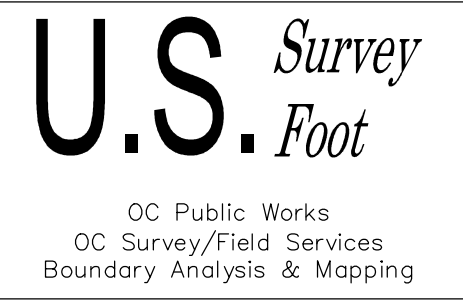

				COUNTY OF ORANGE OC PUBLIC WORKS OC SURVEY/FIELD SERVICES/BOUNDARY ANALYSIS & MAPPING		
		KENSINGTON RD ROAD MAINTENANCE				
		TOPOGRAPHIC MAP				
		PROJECT LIMITS: FROM 11922 KESINGTON RD TO BOSTONIAN DR				
		DATE OF SURVEY: 12/31/2020		BY: T. LOFGREEN & CREW		SHEET NO. 6 of 6
		MAPPING		BY: I. ISLAS		
		OFFICE CHECK		BY: M. KUBISTY, PLS		
FIELD CHECK		BY: T. LOFGREEN				
SCALE: 1"=20'		W.O. # ER19202				
FILE: KENSINGTON RD_TOPO_2020.DWG		FILE # 1920PW-0P0026				
MARK	DATE	ITEM		REVISIONS		