

ROOM C.A.1.1000B CONCESSION STORAGE TOTAL STORAGE AREA IS 795 SQUARE FEET

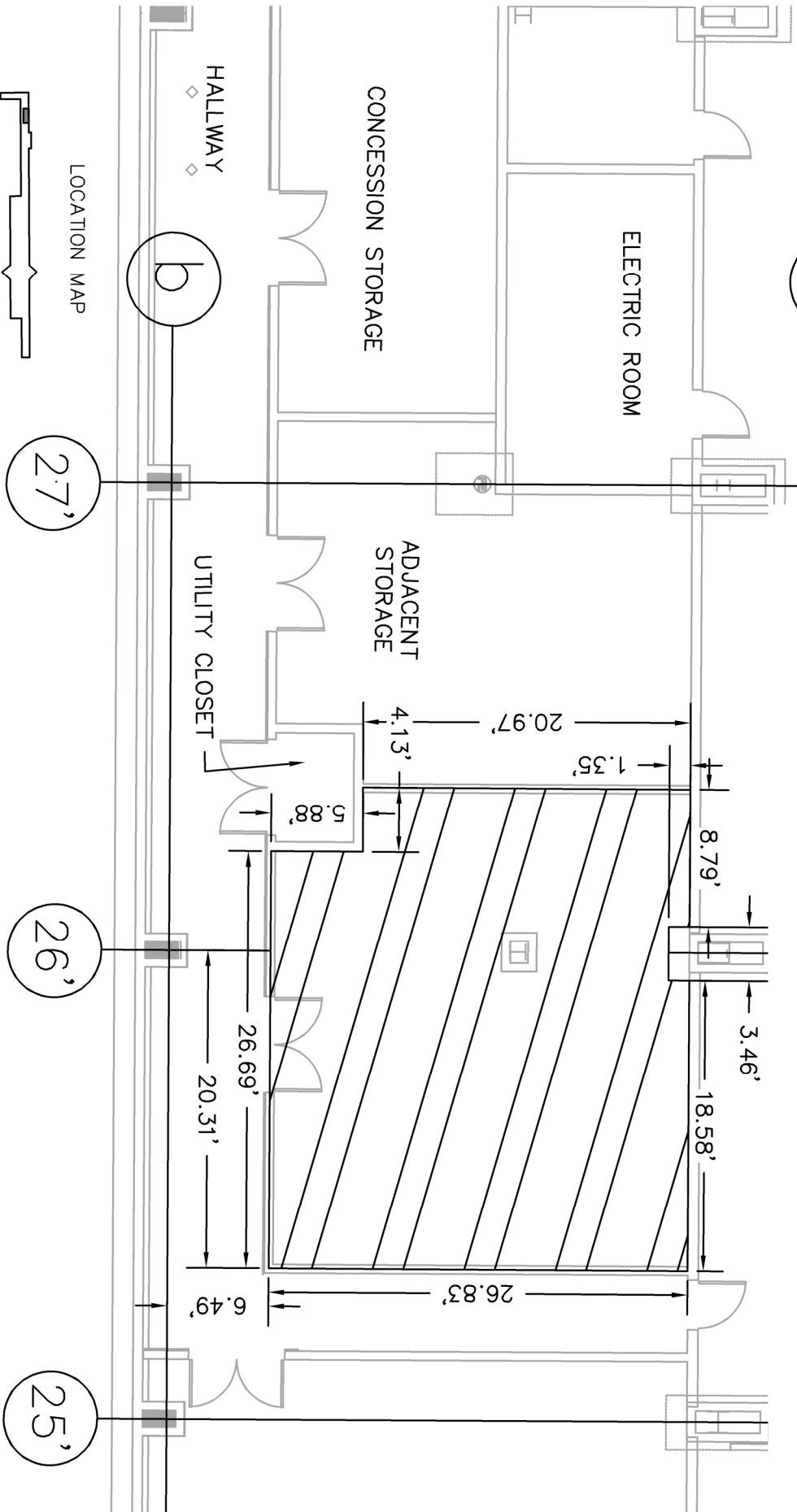

EXHIBIT A		COUNTY OF ORANGE	
PURPOSE: A GRAPHIC REPRESENTATION OF THE SQUARE FOOTAGE OF THE STORAGE AREA. USING THE INSIDE FACE OF THE EXTERIOR WALLS, HALF WIDTH OF INTERIOR WALLS.		OC PUBLIC WORKS/OC SURVEY/FIELD SERVICES	
JWA CONCESSION STORAGE		DATE: 9/22/22	
DRAWN BY: JKUHL		NAME	
CHECKED BY: E. MEDINA		NAME	
W.O. #		FILE NO. 2223JWA-0004	
		SHEET 1 OF 1	

SCALE: 1"=10'

