

Designation: 3W-48-77

Date Destroyed:

Date Revised:

GPS #:

OCS Index Map: Q14-10

Page/Grid: 863/B-7

City / Location: Trabuco Canyon

Line #/SSN: 370/0070

Established By: OCS 1977

Monument Type: Orange County Surveyor's 3 3/4"
Aluminum Disk

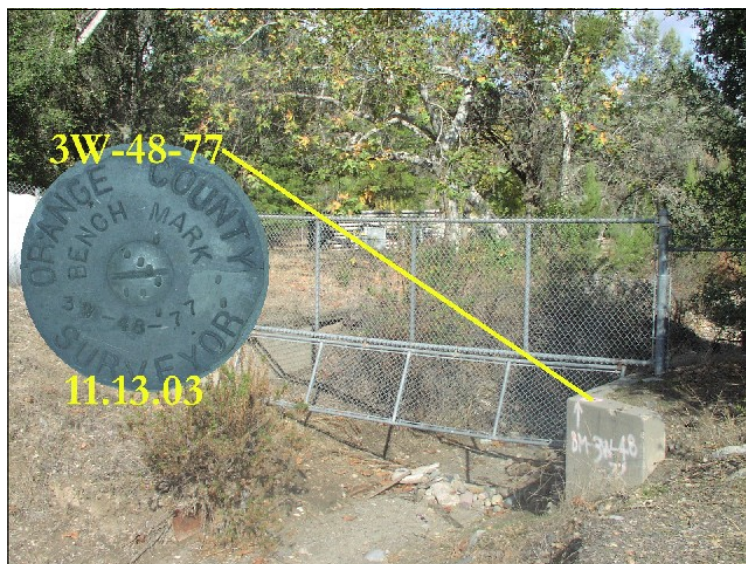

NAVD88 (ft)	NGVD29 (ft)	Year Leveled
969.598	967.244	1990

For Reconnaissance Only!	
Latitude (30' +/-)	Longitude (30' +/-)
33 39 25.7	117 35 30.7

Description:

DESCRIBED BY OCS 2003 - FOUND 3 3/4" OCS ALUMINUM BENCHMARK DISK STAMPED "3W-48-77", SET IN THE TOP OF A CONCRETE HEADWALL. MONUMENT IS LOCATED INSIDE ONEILL REGIONAL PARK, FROM THE TRABUCO CANYON ROAD ENTRANCE TO ONEILL PARK PROCEED .60 MILES NORTHEASTERLY ALONG ASPHALT ROAD TO THE TURN-OFF FOR EAST CAMPGROUND GROUP, THEN PROCEED .15 MILES ALONG ROAD TO WHERE THE ROAD CROSSES THE CREEK AND THERE ARE 16 WHITE POLES ALONG THE EDGE OF THE ROAD, 100 FT. WESTERLY OF THE CENTERLINE OF THE ROAD AND 200 +/- NORTHERLY FROM THE NORTHERLY END OF THE LINE OF POLES. MONUMENT IS SET LEVEL WITH THE TOP OF THE WALL.

