

## Designation: 3PP-28-89

Date Destroyed:

Date Revised:

GPS #:

OCS Index Map: Q14-14

Page/Grid: 893/D-2

City / Location: Santa Margarita

Line #/SSN: 381/0140

Established By: OCS 1989

Monument Type: Orange County Surveyor's 3 3/4"  
Aluminum Disk

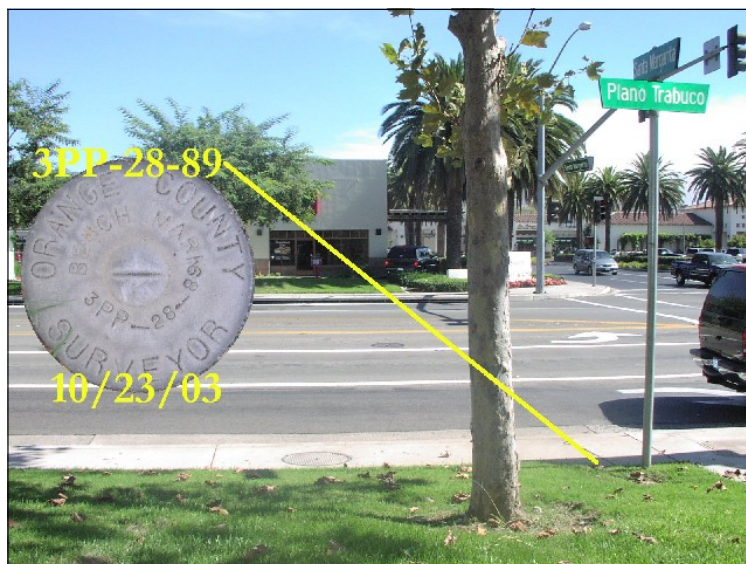

NAVD88 (ft)	NGVD29 (ft)	Year Leveled
1155.201	1152.850	1989

For Reconnaissance Only!	
Latitude (30' +/-)	Longitude (30' +/-)
33 38 54.90	117 34 39.26

### Description:

DESCRIBED BY OCS 2003 - FOUND 3 3/4" OCS ALUMINUM BENCHMARK DISK STAMPED "3PP-28-89", SET IN THE SOUTHWESTERLY CORNER OF A 3 FT. BY 30 FT. DOUBLE CONCRETE CATCH BASIN. MONUMENT IS LOCATED IN THE NORTHWESTERLY CORNER OF THE INTERSECTION OF SANTA MARGARITA PARKWAY AND PLANO TRABUCO, 45 FT. WESTERLY OF THE CENTERLINE OF PLANO TRABUCO AND 75 FT. NORTHERLY OF THE CENTERLINE OF SANTA MARGARITA. MONUMENT IS SET LEVEL WITH THE SIDEWALK.

