

## Designation: 3LL-8-91

Date Destroyed:

Date Revised:

GPS #:

OCS Index Map: Q20-03

Page/Grid: 972/A-2

City / Location: San Juan Capistrano

Line #/SSN: 345/0040

Established By: OCS 1991

Monument Type: Orange County Surveyor's 3 3/4"  
Aluminum Disk

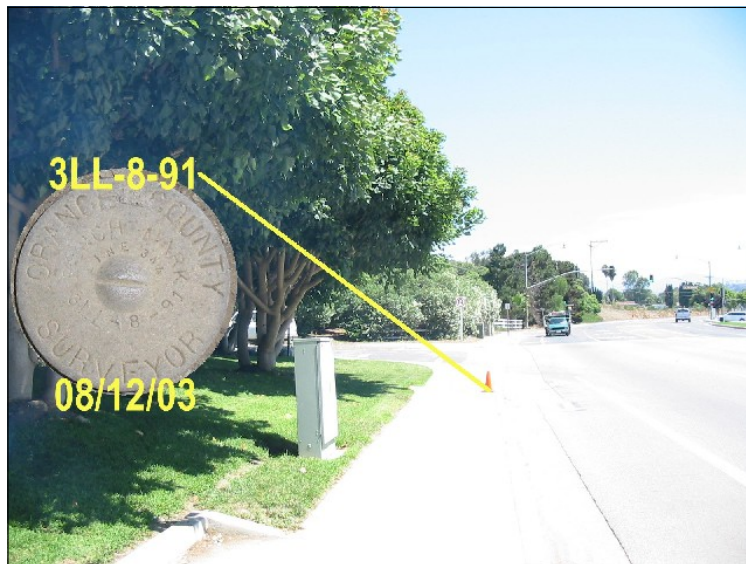

NAVD88 (ft)	NGVD29 (ft)	Year Levelled
108.774	106.470	1990

For Reconnaissance Only!	
Latitude (30' +/-)	Longitude (30' +/-)
33 29 31.00	117 40 46.24

### Description:

DESCRIBED BY OCS 2003 - FOUND 3 3/4" OCS ALUMINUM BENCHMARK DISK STAMPED "3LL-8-91", SET IN THE SOUTHEASTERLY CORNER OF A 4 FT. BY 5 FT. CONCRETE CATCH BASIN. MONUMENT IS LOCATED IN THE SOUTHWESTERLY CORNER OF THE INTERSECTION OF DEL OBISPO STREET AND PASEO DE LA PAZ, 36 FT. WESTERLY OF THE CENTERLINE OF DEL OBISPO AND 61 FT. SOUTHERLY OF THE CENTERLINE OF PASEO DE LA PAZ. MONUMENT IS SET LEVEL WITH THE SIDEWALK.

