

## Designation: 3D-154-91

Date Destroyed:

Date Revised:

GPS #:

OCS Index Map: Q07-12

Page/Grid: 800/H-3

City / Location: Orange

Line #/SSN: 354/0410

Established By: OCS 1991

Monument Type: Orange County Surveyor's 3 3/4"  
Aluminum Disk

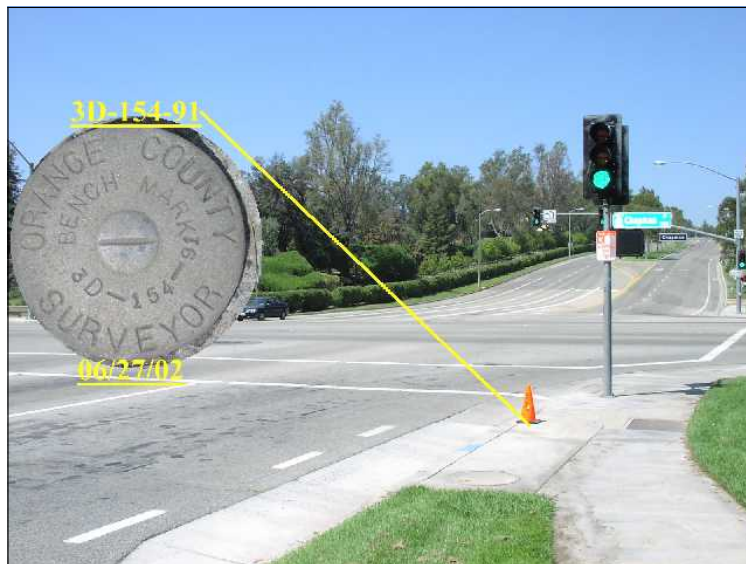

NAVD88 (ft)	NGVD29 (ft)	Year Leveled
510.935	508.513	1991

For Reconnaissance Only!	
Latitude (30' +/-)	Longitude (30' +/-)
33 47 41.34	117 46 17.46

### Description:

DESCRIBED BY OCS 2002 - FOUND 3 3/4" OCS ALUMINUM BENCHMARK DISK STAMPED "3D-154-91", SET IN THE NORTHWESTERLY CORNER OF A 4 FT. BY 15 FT. CONCRETE CATCH BASIN. MONUMENT IS LOCATED IN THE SOUTHEASTERLY CORNER OF THE INTERSECTION OF CHAPMAN AVENUE AND NEWPORT AVENUE, 90 FT. SOUTHERLY OF THE CENTERLINE OF CHAPMAN AND 41 FT. EASTERLY OF THE CENTERLINE OF NEWPORT. MONUMENT IS SET LEVEL WITH THE SIDEWALK.

