

Designation: 3D-150-80

Date Destroyed:

Date Revised:

GPS #:

OCS Index Map: Q14-09

Page/Grid: 862/G-5

City / Location: Live Oak Canyon

Line #/SSN: 354/0130

Established By: OCS 1980

Monument Type: Orange County Surveyor's 3 3/4"
Aluminum Disk

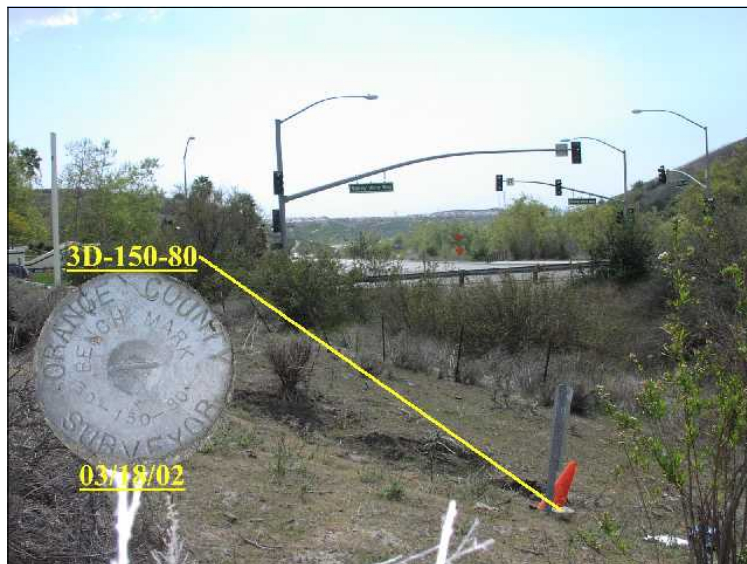

NAVD88 (ft)	NGVD29 (ft)	Year Leveled
1024.707	1022.342	2004
1024.707	1022.342	1990

For Reconnaissance Only!	
Latitude (30' +/-)	Longitude (30' +/-)
33 40 31.00	117 37 21.80

Description:

DESCRIBED BY OCS 2002 - FOUND 3 3/4" OCS ALUMINUM BENCHMARK DISK STAMPED "3D-150-80", SET IN THE TOP OF A 6 IN. BY 6 IN. CONCRETE POST. MONUMENT IS LOCATED IN THE NORTHEAST CORNER OF THE INTERSECTION OF EL TORO ROAD AND VALLEY VISTA WAY, 20 FT. EASTERLY OF A 4 FT. HIGH BARBED WIRE FENCE ALONG THE EASTERLY SIDE OF EL TORO ROAD, 175 FT. NORTHERLY OF THE CENTERLINE OF VALLEY VISTA WAY AND 0.7 FT. WESTERLY OF A PADDLE POST. MONUMENT IS SET LEVEL WITH THE GROUND.

