

## Designation: 2L-21-70

Date Destroyed:

Date Revised:

GPS #: 1521

OCS Index Map: Q03-11

Page/Grid: 710/E-4

City / Location: Brea

Line #/SSN: 261/0110

Established By: OCS 1970

Monument Type: Orange County Surveyor's 3 3/4"  
Aluminum Disk

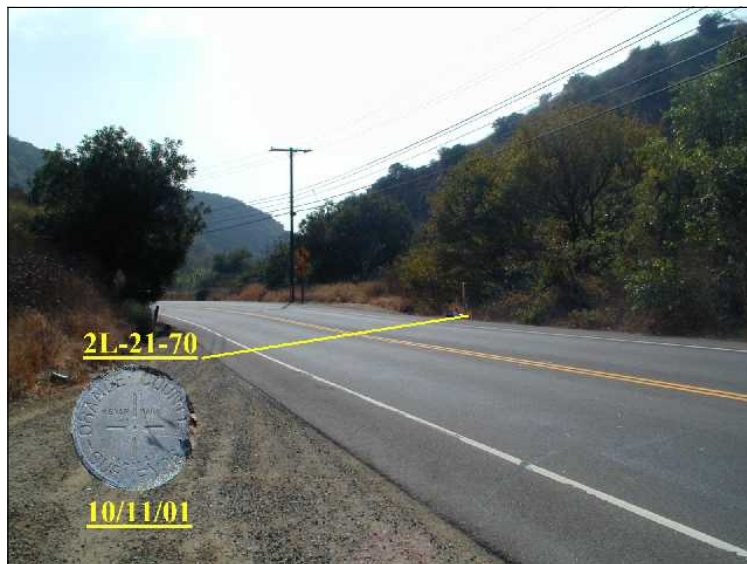

NAVD88 (ft)	NGVD29 (ft)	Year Leveled
720.214	717.804	1986

For Reconnaissance Only!	
Latitude (30' +/-)	Longitude (30' +/-)
33 56 12.58896	117 47 31.62395

### Description:

DESCRIBED BY OCS 2001 - FOUND 3 3/4" OCS ALUMINUM BENCHMARK DISK STAMPED "2L-21-70", SET IN THE TOP OF A CONCRETE POST. MONUMENT IS LOCATED ALONG THE WESTERLY SIDE OF CARBON CANYON ROAD NEAR CONSTRUCTION MARKER "142 ORA 5-47", 147.8 FT. SOUTHWESTERLY OF TELEPHONE POLE #625056, 14 FT. NORTHEASTERLY OF THE CENTER OF A METAL PIPE CULVERT, 7.6 FT. NORTHEASTERLY OF THE CONSTRUCTION STATION MARKER, 21 FT. NORTHWESTERLY OF THE CENTERLINE OF THE ROAD AND 2 FT. WESTERLY OF AN OCS STEEL WITNESS POST. MONUMENT IS SET 1 FT. HIGHER THAN THE ROAD.

