

Designation: SA-329-92

Date Destroyed:

Date Revised:

GPS #:

OCS Index Map: Q06-16

Page/Grid: 829/C-2

City / Location: Santa Ana

Line #/SSN: 725/0030

Established By: OCS 1992

Monument Type: Orange County Surveyor's 3 3/4"
Aluminum Disk

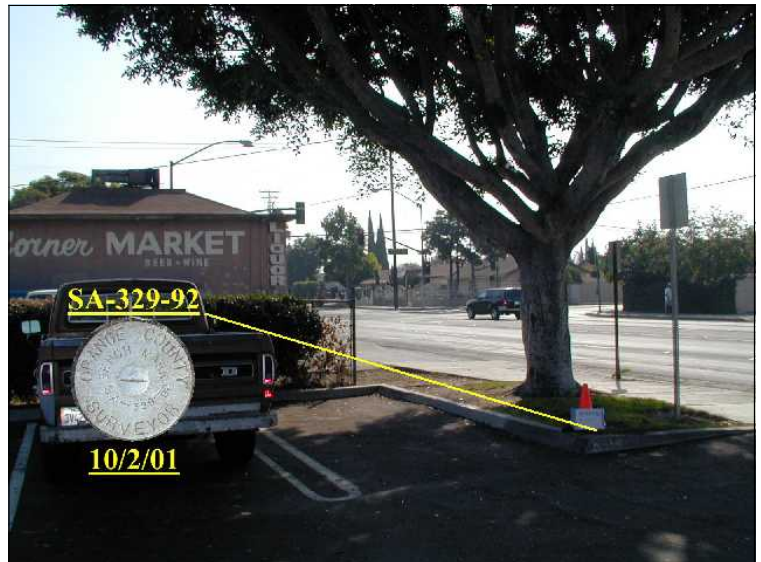

NAVD88 (ft)	NGVD29 (ft)	Year Leveled
89.779	87.364	2010
89.914	87.472	1992

For Reconnaissance Only!	
Latitude (30' +/-)	Longitude (30' +/-)
33 45 05.76	117 53 36.91

Description:

DESCRIBED BY OCS 2001 - FOUND 3 3/4" OCS ALUMINUM BENCHMARK DISK STAMPED "SA-329-92" SET IN THE TOP OF A CONCRETE POST. MONUMENT IS LOCATED IN THE NORTHWEST CORNER OF THE INTERSECTION OF CIVIC CENTER DRIVE AND RAITT STREET, 145 FT. WESTERLY OF THE CENTERLINE OF RAITT STREET AND 47 FT. NORTHERLY OF THE CENTERLINE OF CIVIC CENTER DRIVE, 7 FT. NORTHERLY OF THE BACK OF SIDEWALK, IN THE NORTHWEST CORNER OF A 7 FT. BY 30 FT. PLANTER. MONUMENT IS DOWN 0.1 FT. FROM THE TOP OF CURB.

