

Designation: S-424-R65

Date Destroyed:

Date Revised:

GPS #:

OCS Index Map: Q02-12

Page/Grid: 709/B-6

City / Location: Brea

Line #/SSN: 253/0200

Established By: USC & GS 1965

Monument Type: Bronze / Brass Disk

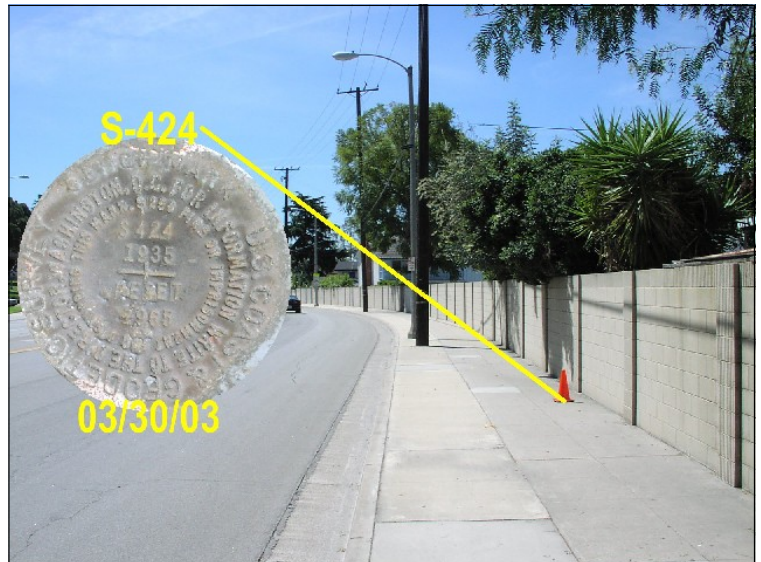

NAVD88 (ft)	NGVD29 (ft)	Year Levelled
374.571	372.154	2005
374.696	372.281	1990

For Reconnaissance Only!	
Latitude (30' +/-)	Longitude (30' +/-)
33 55 41.42	117 53 44.09

Description:

DESCRIBED BY OCS 2003 - FOUND 3 3/4" US COAST AND GEODETIC SURVEY BRONZED DISK STAMPED "S-424-R65", SET IN THE TOP OF A CONCRETE SIDEWALK. MONUMENT IS LOCATED IN THE SOUTHWESTERLY CORNER OF THE INTERSECTION OF CLOVE DRIVE PROLONGED TO THE EAST AND BREA BOULEVARD, 47 FT. WESTERLY OF THE CENTERLINE OF BREA AND 106 FT. SOUTHERLY OF THE CENTERLINE OF CLOVE PROJECTED TO THE EAST. MONUMENT IS SET LEVEL WITH THE SIDEWALK.

