

Designation: D-352-R65

Date Destroyed:

Date Revised:

GPS #:

OCS Index Map: Q02-12

Page/Grid: 709/B-6

City / Location: Brea

Line #/SSN: 253/0210

Established By: USC & GS 1965

Monument Type: Bronze / Brass Disk

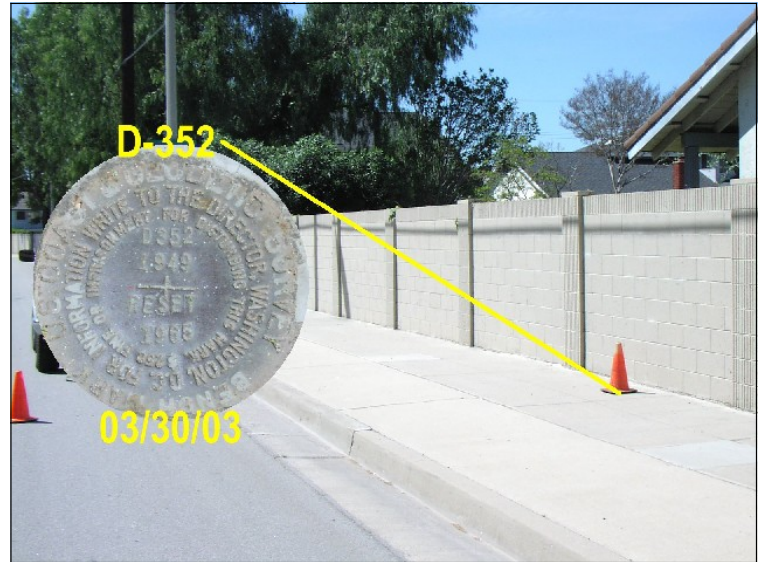

NAVD88 (ft)	NGVD29 (ft)	Year Leveled
375.015	372.598	2005
375.107	372.692	1990

For Reconnaissance Only!	
Latitude (30' +/-)	Longitude (30' +/-)
33 55 42.27	117 53 43.79

Description:

DESCRIBED BY OCS 2003 - FOUND 3 3/4" US COAST AND GEODETIC BRONZED DISK STAMPED "D-352-R65", SET IN THE TOP OF A CONCRETE SIDEWALK. MONUMENT IS LOCATED IN THE NORTHWESTERLY CORNER OF THE INTERSECTION OF BREA BOULEVARD AND CLOVE PLACE PROLONGED TO THE EAST, 80 FT. NORTHERLY OF THE PROLONGATION OF CLOVE CENTERLINE TO THE EAST AND 45 FT. WESTERLY OF THE CENTERLINE OF BREA. MONUMENT IS SET LEVEL WITH THE SIDEWALK.

