

## Designation: 3X-53-91

Date Destroyed:

Date Revised:

GPS #:

OCS Index Map: Q12-12

Page/Grid: 861/A-7

City / Location: Irvine

Line #/SSN: 371/0020

Established By: OCS 1991

Monument Type: Orange County Surveyor's 3 3/4"  
Aluminum Disk

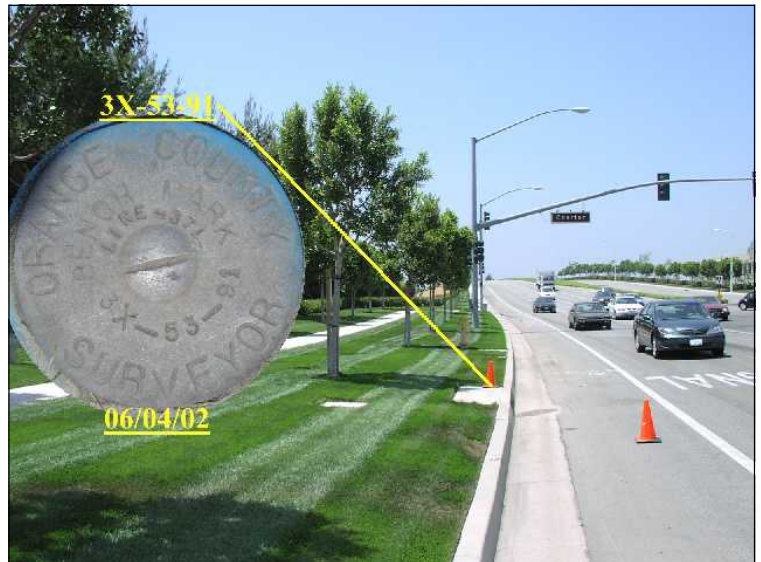

NAVD88 (ft)	NGVD29 (ft)	Year Leveled
203.244	200.867	2004
203.244	200.867	1991

For Reconnaissance Only!	
Latitude (30' +/-)	Longitude (30' +/-)
33 39 37.86	117 45 05.86

### Description:

DESCRIBED BY OCS 2002 - FOUND 3 3/4" OCS ALUMINUM BENCHMARK DISK STAMPED "3X-53-91", SET IN THE NORTHWESTERLY CORNER OF A 3 FT. BY 8 FT. CONCRETE CATCH BASIN. MONUMENT IS LOCATED IN THE SOUTHEASTERLY CORNER OF THE "T" INTERSECTION OF IRVINE CENTER DRIVE AND CHARTER STREET, 63 FT. SOUTHERLY OF THE CENTERLINE OF IRVINE CENTER DRIVE AND 127 FT. EASTERLY OF THE CENTERLINE OF CHARTER. MONUMENT IS SET LEVEL WITH THE SIDEWALK.

