

Designation: 3PP-26-89

Date Destroyed:

Date Revised:

GPS #:

OCS Index Map: Q14-14

Page/Grid: 893/B-2

City / Location: Santa Margarita

Line #/SSN: 381/0120

Established By: OCS 1989

Monument Type: Orange County Surveyor's 3 3/4"
Aluminum Disk

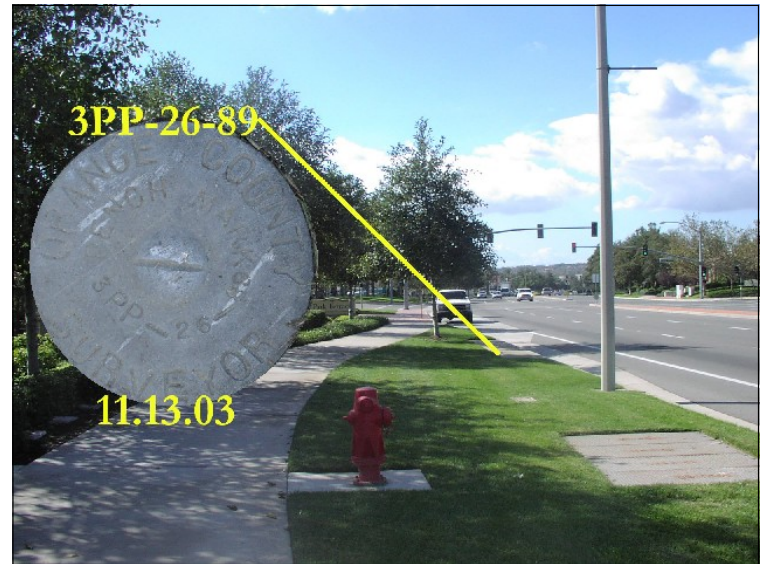

NAVD88 (ft)	NGVD29 (ft)	Year Leveled
1039.070	1036.719	1989

For Reconnaissance Only!	
Latitude (30' +/-)	Longitude (30' +/-)
33 38 39.96	117 35 32.50

Description:

DESCRIBED BY OCS 2003 - FOUND 3 3/4" OCS ALUMINUM BENCHMARK DISK STAMPED "3PP-26-89", SET IN THE SOUTHEASTERLY CORNER OF A 3.5 FT. BY 30 FT. CONCRETE CATCH BASIN. MONUMENT IS LOCATED IN THE SOUTHEASTERLY CORNER OF THE INTERSECTION OF SANTA MARGARITA AND BUENA SUERTE, 52.2 FT. SOUTHERLY OF THE CENTERLINE OF SANTA MARGARITA AND 240 FT. +/- FROM THE CENTERLINE OF BUENA SUERTE. MONUMENT IS SET LEVEL WITH THE SIDEWALK.

