

Designation: 3JJ-21-90

Date Destroyed:

Date Revised: 7/29/2013

GPS #: 1493

OCS Index Map: Q13-12

Page/Grid: 862/C-5

City / Location: Lake Forest

Line #/SSN: 346/0130

Established By: OCS 1990

Monument Type: Orange County Surveyor's 3 3/4"
Aluminum Disk

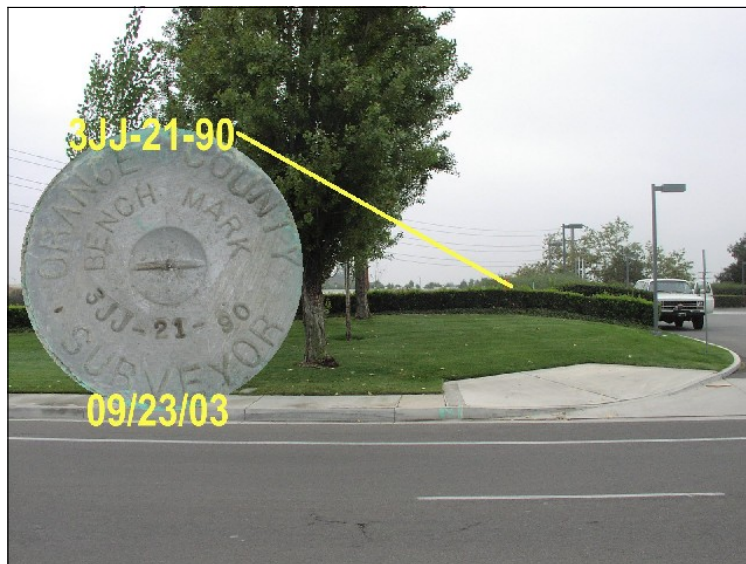

| NAVD88 (ft) | NGVD29 (ft) | Year Leveled |
|-------------|-------------|--------------|
| 818.650 | 816.287 | 2004 |
| 818.683 | 816.319 | 1990 |
| | | |
| | | |
| | | |

| For Reconnaissance Only! | |
|--------------------------|---------------------|
| Latitude (30' +/-) | Longitude (30' +/-) |
| 33 40 21.93049 | 117 39 17.80207 |

Description:

DESCRIBED BY OCS 2013 - FOUND 3 3/4" OCS ALUMINUM BENCHMARK DISK STAMPED "3JJ-21-90", SET IN THE TOP OF AN 8 IN. BY 8 IN. CONCRETE POST. MONUMENT IS LOCATED ALONG THE SOUTHWESTERLY SIDE OF PORTOLA PARKWAY, 280 FT. SOUTHEASTERLY FROM TOWN CENTRE DRIVE, JUST SOUTH FROM ENTRANCE TO GAS STATION, BEHIND HEDGES, 17 FT. SOUTHEASTERLY FROM TOP OF CURB OF ENTRANCE. MONUMENT HAS TWO STEEL WITNESS POSTS 3 FT. EASTERLY AND WESTERLY AND IS SET UP 0.2 FT. ABOVE THE GRADE.

