

Designation: 3D-106-71

Date Destroyed:

Date Revised: 8/14/2017

GPS #:

OCS Index Map: Q13-04

Page/Grid: 832/C-4

City / Location: Unin., Orange Co.

Line #/SSN: 354/0240

Established By: OCS 1971

Monument Type: Orange County Surveyor's 3 3/4"
Aluminum Disk

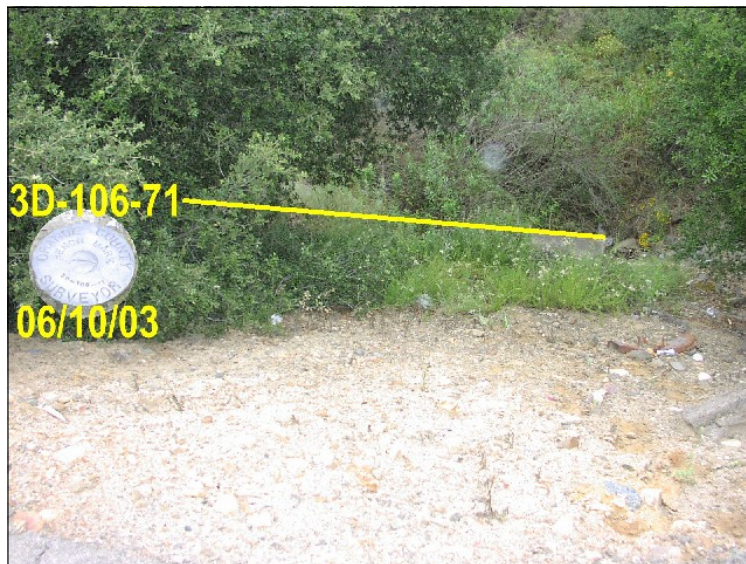

NAVD88 (ft)	NGVD29 (ft)	Year Leveled
1104.800	1102.417	2017
1104.800	1102.417	1991

For Reconnaissance Only!	
Latitude (30' +/-)	Longitude (30' +/-)
33 44 02.58	117 39 11.77

Description:

DESCRIBED BY OCS 2003 - FOUND 3 3/4" OCS ALUMINUM BENCHMARK DISK STAMPED "3D-106-71", SET IN THE SOUTHEASTERLY CORNER OF A CONCRETE BOX CULVERT. MONUMENT IS LOCATED ALONG THE NORTHEASTERLY SIDE OF SANTIAGO CANYON ROAD, 1.15 MILES NORTHEASTERLY OF THE CENTERLINE OF MODJESKA CANYON ROAD AND 61 FT. EASTERLY OF THE CENTERLINE OF SANTIAGO CANYON ROAD. MONUMENT IS SET 20 FT. BELOW THE SURFACE OF SANTIAGO CANYON ROAD AT THE BOTTOM OF A STEEP SLOPE.

