

Designation: 3A-84-71

Date Destroyed:

Date Revised: 7/10/2007

GPS #:

OCS Index Map: Q07-15

Page/Grid: 830/D-2

City / Location: East Tustin

Line #/SSN: 351/0110

Established By: OCS 1971

Monument Type: Orange County Surveyor's 3 3/4"
Aluminum Disk

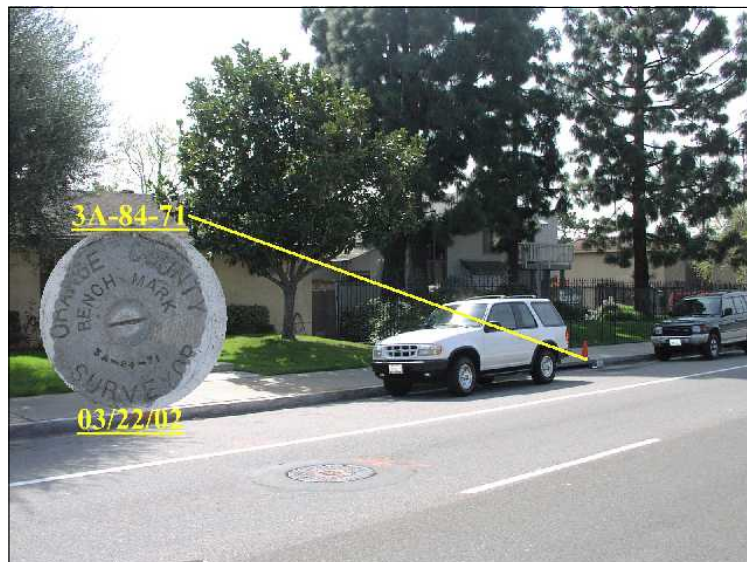

NAVD88 (ft)	NGVD29 (ft)	Year Levelled
164.036	161.606	2010
164.010	161.581	2003
164.060	161.628	1991

For Reconnaissance Only!	
Latitude (30' +/-)	Longitude (30' +/-)
33 45 08.27783	117 48 28.17512

Description:

DESCRIBED BY OCS 2002 - FOUND 3 3/4" OCS ALUMINUM BENCHMARK DISK STAMPED "3A-84-71", SET IN THE SOUTHWESTERLY CORNER OF A 6 FT. BY 9 FT. CONCRETE CATCH BASIN. MONUMENT IS LOCATED IN THE SOUTHEASTERLY CORNER OF THE INTERSECTION OF NEWPORT AVENUE AND WARREN AVENUE, 43 FT. SOUTHEASTERLY OF THE CENTERLINE OF NEWPORT AVENUE AND ACROSS NEWPORT AVENUE FROM ADDRESS #12711 NEWPORT AVENUE. MONUMENT IS SET LEVEL WITH THE SIDEWALK.

