

CONDUCTOR AND CONDUIT SCHEDULE												
AWG	CIRCUIT	1	2	3	4	5	6	7	8	9	10	11
12 COND. CABLE	POLE ①	-	-	-	-	-	-	-	-	-	1/1	1/1
	POLE ②	-	-	-	-	-	-	-	-	-	1/1	1/1
	POLE ③	-	-	-	-	-	-	-	-	-	1/0	1/0
	POLE ④	-	-	-	-	-	-	-	-	-	1/1	1/1
3 COND. CABLE	POLE ⑤	1/1	1/1	1/1	1/1	-	-	-	-	-	1/1	1/1
	POLE ⑥	-	-	-	-	-	-	-	-	-	1/0	1/0
	POLE ⑦	-	-	-	-	-	-	-	-	-	1/1	1/1
	POLE ⑧	-	-	-	-	-	-	-	-	-	1/1	1/1
TOTAL		1/1	2/1	3/2	4/3	1/1	2/1	3/2	8/6	8/6		
#12	L.I.S.N.S.	2	2	2	2	2	2	2	4	-		
#10	LUMINAIRE	2	2	2	2	2	2	2	4	-		
TYPE B DLC	#1	-	-	-	-	-	-	-	-	-	1	1
	#2	-	-	-	-	-	-	-	-	-	5	5
	#4	-	-	-	-	-	-	-	-	-	1	1
	#5	-	-	-	-	-	-	-	-	-	1	1
TOTAL	#6	-	-	-	-	-	-	-	-	-	5	5
	#8	-	-	-	-	-	-	-	-	-	2	2
	#10	-	-	-	-	-	-	-	-	-	2	2
	#12	-	-	-	-	-	-	-	-	-	2	2
TOTAL		0	2	2	8	6	6	7	15	15		
3-#20 E.V.P. CABLE		1	1	2	2	-	-	-	1	1	4	4
CONDUIT SIZE		3"	3"	4"	4"	3"	4"	4"	4"	4"		
PERCENT FILL		9%	17%	14%	22%	14%	12%	17%	21%	20%		

ALL CONDUCTORS AND CONDUITS SHALL BE NEW.

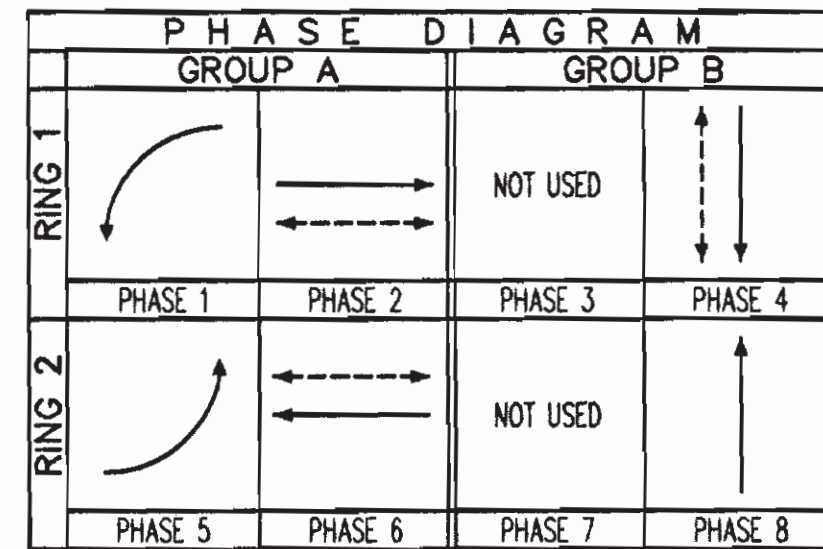

POLE SCHEDULE												
STANDARD	HT.	SIG.	LUM.	H.P.S.V.	TYPE	PHASE	QUAD	SIGNAL MOUNTING	VEHICLE	PED.	MESSAGE	PLACEMENT
29-5-100	30'	45'	15'	250 W	B	4	E	MAS, MAS, MAS, SV-1-T	SP-1-T	-	Garza Ave	4' 3"
1-A	10'	-	-	-	B	6	S	TV-1-T	SP-1-T	-	-	5' 3"
17-2-100	30'	15'	12'	250 W	B	6	S	MAS, SV-1-T	SP-1-T	-	Katella Ave	5' 3"
1-A	10'	-	-	-	B	6	S	TV-1-T	SP-1-T	-	-	5' 3"
29-5-100	30'	45'	15'	250 W	-	-	-	MAS, MAS, MAS, SV-1-T	SP-1-T	-	Garza Ave	8' 7" 3"
1-A	10'	-	-	-	B	2	N	TV-1-T	SP-1-T	-	-	6' 4" 3"
19-3-100	30'	25'	12'	250 W	B	2	N	MAS, SV-1-T	SP-1-T	-	Katella Ave	5' 3"
1-A	10'	-	-	-	B	4	E	TV-1-T	SP-1-T	-	-	8' 8" 3' 4"

ALL POLES AND EQUIPMENT SHALL BE NEW.

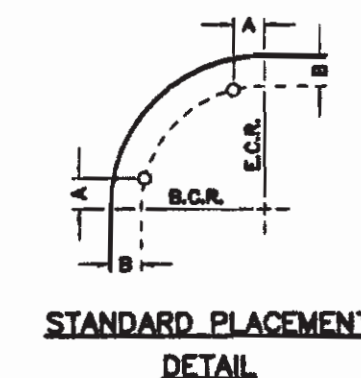

AS BUILT

CORRECTION BY: JAVIER SOTO

CONTRACT NO.: ER08972

DATE: 03/13/2013

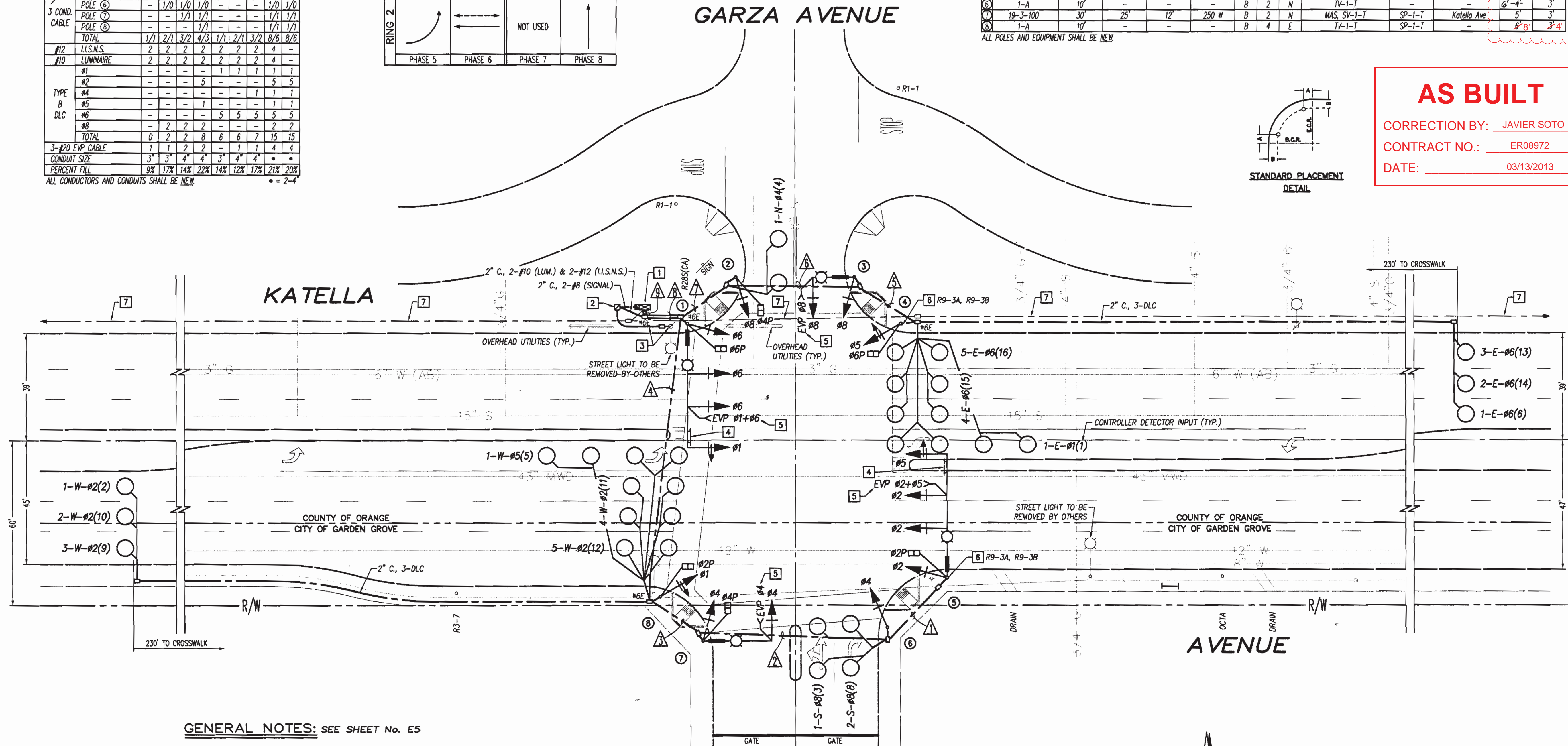

GENERAL NOTES: SEE SHEET No. E5

CONSTRUCTION NOTES THIS SHEET:

- SUPPLY AND INSTALL NEW SYSTEM CONTROLLER (ECONOLITE ASC/3-2100), ONE-454 E.V.P. DISCRIMINATORS UNIT AND APPURTENANCES IN UNPAINTED ALUMINUM TS2 TYPE 2 CABINET. PLACE CABINET WITH DOOR ON CURB SIDE. SET TOP OF FOUNDATION AT 18" ABOVE GRADE. INSTALL BATTERY BACK-UP SYSTEM IN SEPARATE CABINET MOUNTED ON THE WEST SIDE OF CONTROLLER CABINET. SEE SPECIAL PROVISIONS.
- INSTALL 120/240 VOLT TYPE III SERVICE WITH 120V/50 AMP METERED SIGNAL CIRCUIT, 120V/15 AMP METERED I.I.S.N.S. CIRCUIT, 120V/30 AMP UNMETERED LIGHTING CIRCUIT AND TWO TYPE V.P.E. CONTROLS FOR LIGHTING AND I.I.S.N.S.
- INSTALL 3" CONDUIT AND PULL ROPE WITH A MINIMUM OF 3 FEET OF COVER. SWEEP TO HAVE A MINIMUM RADIUS OF 3 FEET. PROVIDE 6 INCH RISER ON POWER POLE 3 INCHES AWAY FROM POLE. ALL WORK TO BE COMPLETED UNDER THE SUPERVISION OF SOUTHERN CALIFORNIA EDISON.
- INSTALL R73-2(CA) AND R10-7 SIGNS PER STANDARD PLAN ES-7N, DETAIL 'U'.
- SUPPLY AND INSTALL MODEL 711 EMERGENCY VEHICLE DETECTOR PER STANDARD PLAN ES-4E. MAKE ALL CONNECTIONS AS DIRECTED BY THE SUPPLIER.
- INSTALL R9-3A & R9-3B SIGNS ON TRAFFIC SIGNAL POLE.
- PROPOSED 3" CONDUIT AND SIC. SEE INTERCONNECT PLAN, SHEET No. E7.

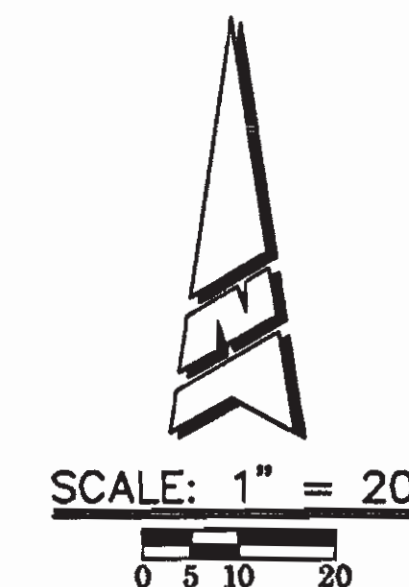

CITY OF GARDEN GROVE	COUNTY OF ORANGE
APPROVED BY: <i>[Signature]</i> 3/26/09 DATE	APPROVED BY: <i>[Signature]</i> 3/2/09 DATE
	COUNTY TRAFFIC ENGINEER



REVISION	DATE	DESCRIPTION	MARK

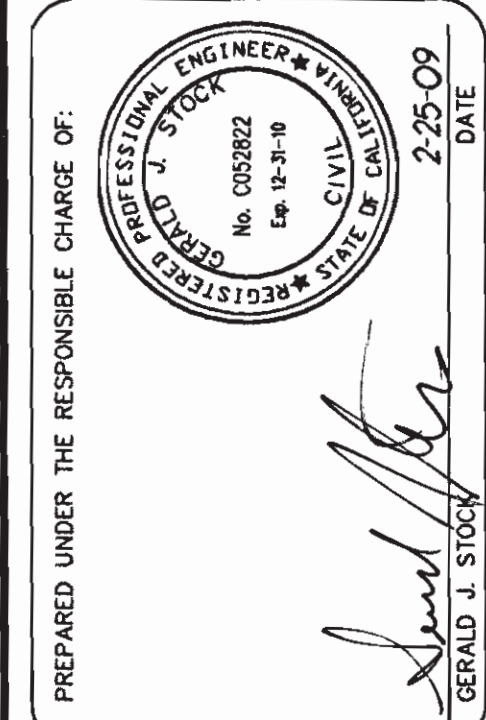

DESIGNED BY: D.J.M.	CHECKED BY: T.G.H.
DRAWN BY: D.J.M.	DRAWING CODE:
FILE NAME: KATELAGARZA SIGNALING	SCALE: AS SHOWN
PLAT DATE: 2-25-09	

KATELAGARZA AVENUE
SMART STREET PROJECT
Traffic Signal & Lighting Plan
Katella Avenue
and
Garza Avenue