

SHEET 1 OF 2

GENERAL NOTES

1. ALL METHODS, WORKS, MATERIALS, AND EQUIPMENT SHALL CONFORM TO THE REQUIREMENTS OF THE STATE OF CALIFORNIA, DEPARTMENT OF TRANSPORTATION, STANDARD PLANS AND SPECIFICATIONS JULY, 2002 EDITION. NEW EQUIPMENT, METHODS, AND MATERIALS, PLANS AND BASE MEASUREMENTS WILL REMAIN IN ENGLISH UNITS.
2. UTILITIES SHOWN ON THESE PLANS ARE CORRECT AND ACCURATE TO THE EXTENT OF AVAILABLE RECORDS AND KNOWLEDGE. THE CONTRACTOR, HOWEVER, IS REQUIRED TO TAKE STEPS TO ASCERTAIN THE EXACT LOCATION OF UNDERGROUND FACILITIES PRIOR TO DOING WORK THAT MAY INTERFERE WITH SUCH FACILITIES. CONTACT USA DIG ALERT AT 1-800-422-4133 48 HOURS IN ADVANCE.
3. EACH CONDUCTOR IN EACH PULL BOX SHALL BE IDENTIFIED AS DETAILED IN THE CONDUCTOR SCHEDULE WITH A PERMANENT IDENTIFICATION BAND IN PULL BOXES AND NEAR THE END OF EACH CONDUCTOR WHERE CONDUCTORS ARE TERMINATED. PERMANENT IDENTIFICATION BANDS SHALL BE EMBOSSED ALUMINUM FOIL TYPE WITH PRESSURE SENSITIVE OIL RESISTANT BACKING.
4. ALL NEW CONDUITS SHALL BE RIGID GALVANIZED METAL AND SHALL BE 2" IN SIZE UNLESS NOTED OTHERWISE ON PLANS.
5. CORE, SAW-CUT AND POLE FOUNDATION LOCATIONS SHALL BE VERIFIED IN THE FIELD BY THE ENGINEER PRIOR TO EXCAVATING. DIRT AND DEBRIS ON THE STREET SURFACE DUE TO SAWCUTTING AND CORING ACTIVITIES SHALL BE VACUUMED IMMEDIATELY AFTER SAWCUTTING. POLE PLACEMENT MAY BE ADJUSTED BY THE ENGINEER, NO ADDITIONAL COMPENSATION FOR THE NEW LOCATION SHALL BE GRANTED TO THE CONTRACTOR.
6. ALL PULL BOXES SHALL BE WITH FIBERLYTE NON-CONCRETE LID LABEL "TRAFFIC SIGNAL" UNLESS NOTED OTHERWISE ON PLANS.
7. ALL CONDUITS SHALL BE INSTALLED AT A MINIMUM DEPTH OF 30".
8. TRENCHING IN STREET PAVEMENT SHALL NOT BE ALLOWED FOR THIS PROJECT. HOWEVER, IN SIDEWALK AREAS, CONTRACTOR MAY TRENCH OR BORE SUCH THAT SIDEWALK IS REPLACED IN KIND, SCORE MARK TO SCORE MARK.
9. MAINTAIN 3.0m (10ft) CLEARANCE FROM EXISTING OVERHEAD FACILITIES IN THE AREA AT ALL TIMES.
10. REPAINT EXISTING STRIPING DISTURBED BY THE INSTALLATION OF IN-PAVEMENT DEVICES, SAW-CUTTING, SANDBLASTING, AND/OR OTHER WORK TO THE SATISFACTION OF THE ENGINEER.
11. ALL EXISTING CROSSWALKS AND LEGENDS ARE YELLOW UNLESS OTHERWISE NOTED.
12. ALL EXISTING LIMIT LINES ARE WHITE UNLESS OTHERWISE NOTED.
13. PROTECT IN-PLACE EXISTING SIGNS UNLESS NOTED OTHERWISE.
14. CONTRACTOR SHALL FURNISH ALL MATERIAL AND EQUIPMENT REQUIRED.

CONSTRUCTION NOTES:

1. FURNISH & INSTALL AN "IN-ROAD FLASHING CROSSWALK LIGHT SYSTEM" WITH CONTROLLER ASSEMBLY IN THE CUSTOMER SECTION OF THE TYPE III ELECTRICAL SERVICE CABINET PER THIS PLAN AND SPECIFICATIONS.
2. FURNISH & INSTALL A TYPE III ELECTRICAL SERVICE FOUNDATION.
3. FURNISH & INSTALL AN ALUMINUM TYPE III-B ELECTRICAL SERVICE CABINET & FOUNDATION. FACE CABINET DOOR TOWARDS BOLSA AVENUE.
4. FURNISH & INSTALL 3" CONDUIT, AND 3#10 CONDUCTORS AND PULLROPE TO ELECTRICAL SERVICE CONNECTION.
5. FURNISH & INSTALL 2" CONDUIT, #3 1/2 PULL BOXES AND CONDUCTORS.
6. FURNISH & INSTALL STREET LIGHT POLE ASSEMBLY, PEDESTRIAN PUSH BUTTON AND R62E (CA) SIGN.
7. FURNISH & INSTALL "IN-ROAD FLASHING CROSSWALK LIGHT SYSTEM" PER PRODUCT SPECIFICATIONS.
8. SAWCUT AND INSTALL CONDUCTORS AND SEAL ALL SLOTS PER PRODUCT SPECIFICATIONS.
9. REPAINT EXISTING YELLOW CROSSWALK PER STD. PLAN #1416.
10. REMOVE EXISTING SIGN AND POST. PATCH HOLE IN CONCRETE SIDEWALK.
11. PROTECT IN PLACE.
12. STENCIL.
13. PROVIDE AND INSTALL NEW FLORESCENT-YELLOW GREEN S1-1 AND W16-7 SIGNS (ASSEMBLY B OR ASSEMBLY A) AS INDICATED.
14. REMOVE EXISTING RPM'S ALONG CROSSWALK.
15. PAINT 12" SOLID WHITE LIMIT LINE.
16. SANDBLAST.
17. PROVIDE AND INSTALL A 3 INCH SCHEDULE 80 PVC CONDUIT TO A HEIGHT OF 30 ft FOR ELECTRICAL SERVICE AND AS DIRECTED BY SERVICING UTILITY.

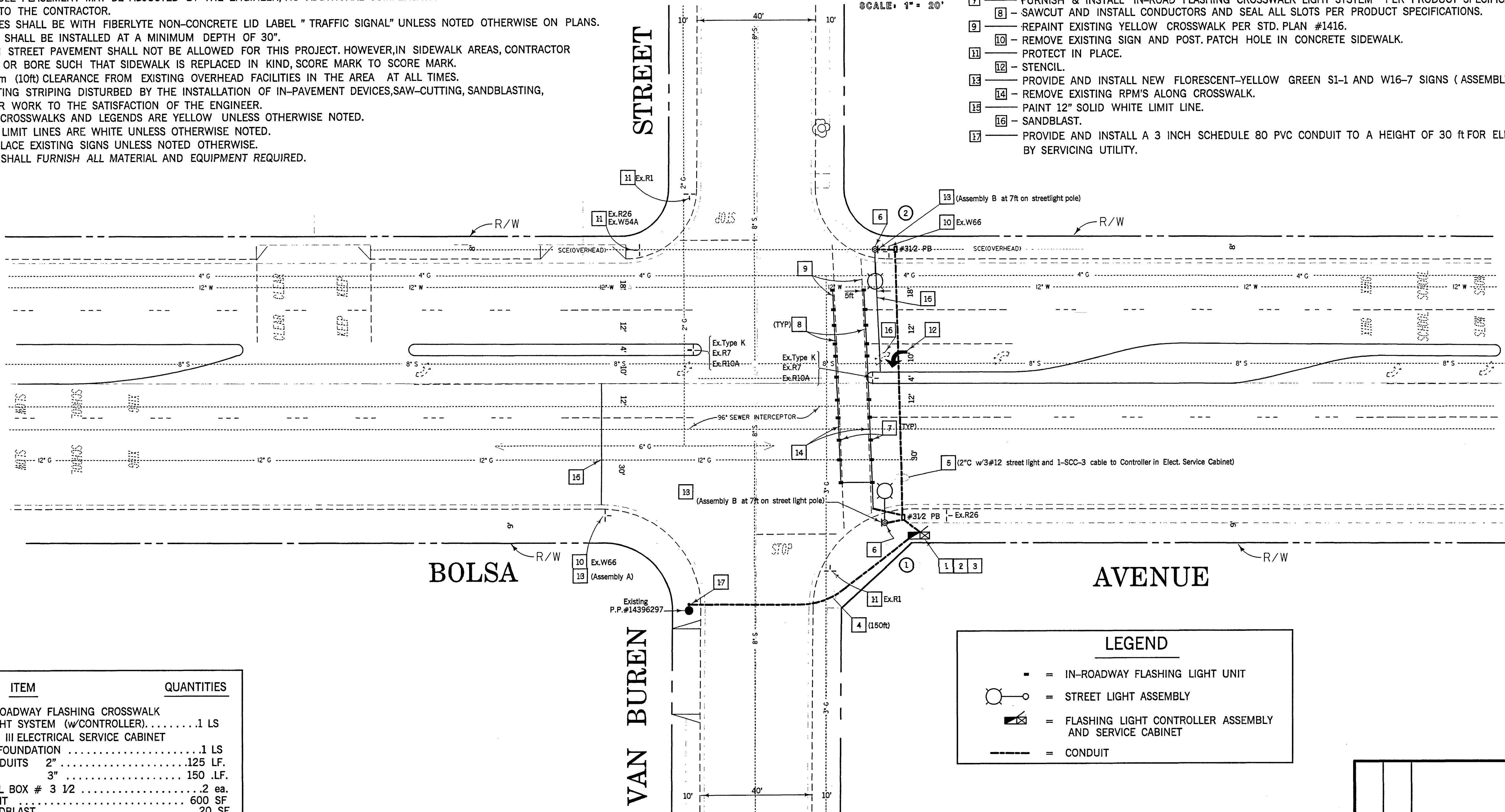

ITEM	QUANTITIES
1. IN-ROADWAY FLASHING CROSSWALK LIGHT SYSTEM (w/CONTROLLER).....	1 LS
2. TYPE III ELECTRICAL SERVICE CABINET & FOUNDATION	1 LS
3. CONDUITS 2"	125 LF.
3"	150 LF.
4. PULL BOX # 3 1/2	2 ea.
5. PAINT	600 SF
6. SANDBLAST	20 SF.
7. REMOVE SIGNS	2 ea.
8. INSTALL SIGNS	5 ea.
9. CONDUCTORS	1 LS.
10. STREET LIGHT ASSEMBLY & FOUNDATION...	2 ea.

LEGEND	
	= IN-ROADWAY FLASHING LIGHT UNIT
	= STREET LIGHT ASSEMBLY
	= FLASHING LIGHT CONTROLLER ASSEMBLY AND SERVICE CABINET
	= CONDUIT

POLE SCHEDULE			
NO.	TYPE	LUMINAIRE ARM	LUMINAIRE
1	15	15ft	250w
2	15	15ft	250w

			ORANGE COUNTY RESOURCES & DEVELOPMENT MANAGEMENT DEPARTMENT	
			BOLSA AVENUE AND VAN BUREN STREET INSTALLATION OF AN IN-ROADWAY FLASHING CROSSWALK LIGHT SYSTEM	
MARK			DATE	
DESCRIPTION			REVISIONS	
DESIGNED T.LE			SUPERVISION OF L.BAD	
DRAWN T.LE			CHECKED LABAD	
SCALE 1"=20'			DATE FEB 06	
W.D. NO. ER09044			SHEET 2 OF 2	