

| CONDUCTOR SCHEDULE  |               |     |     |    |     |      |
|---------------------|---------------|-----|-----|----|-----|------|
| AWG                 | CIRCUIT       | ▲   | ▲   | ▲  | ▲   | ▲    |
| #14                 | #2            | 3   | 3   | -  | -   | 3    |
|                     | #4            | 3   | 3   | -  | -   | 3    |
|                     | #5            | 3   | 3   | 3  | -   | 6    |
|                     | #6            | -   | 3   | -  | -   | 3    |
|                     | #4P           | -   | 2   | -  | -   | 2    |
|                     | #6P           | -   | -   | 2  | -   | 2    |
|                     | #4 PPB        | -   | 1   | -  | -   | 1    |
|                     | #6 PPB        | -   | -   | 1  | 1   | 1    |
|                     | PPB COMMON    | 1   | 1   | 1  | 1   | 2    |
|                     | SPARES        | 3   | 3   | 3  | 3   | 6    |
|                     | TOTAL         | 13  | 19  | 10 | 10  | 31   |
| #10                 | SIGNAL COMMON | 1   | 1   | 1  | 1   | 2    |
|                     | IISNS         | 2   | 2   | 2  | -   | -    |
|                     | LUMINAIRE     | 2   | 2   | 2  | -   | -    |
|                     | TOTAL         | 5   | 5   | 5  | 1   | 2    |
| TYPE "B"<br>DLC     | #2 DETECTOR   | -   | 3   | -  | -   | 3    |
|                     | #4 DETECTOR   | -   | -   | -  | -   | 2    |
|                     | #5 DETECTOR   | -   | 1   | -  | -   | 1    |
|                     | #6 DETECTOR   | -   | -   | 3  | -   | 3    |
|                     | TOTAL         | -   | 4   | 3  | 2   | 9    |
| OPTICOM             |               | -   | -   | -  | 1   | 3    |
| PERCENTAGE FILL (%) |               | 10% | 10% | 7% | 13% | 10%  |
| CONDUIT SIZE        |               | 2"  | 3"  | 3" | 2"  | 2-3" |

ALL CONDUCTORS AND CONDUITS ARE EXISTING.  
PPB = PED PUSH BUTTON

| SENSOR TABLE ■ |         |          |            |
|----------------|---------|----------|------------|
| SENSOR UNIT    | CHANNEL | DETECTOR | ASSIGNMENT |
| 1              | ▲ 1     | 1-#2-E   | EXTENSION  |
|                | ▲ 2     | 2-#2-E   | EXTENSION  |
| 2              | 1       | 3-#2-E   | NORMAL     |
|                | 2       | 3-#6-W   | NORMAL     |
| 3              | ▲ 1     | 1-#6-W   | EXTENSION  |
|                | ▲ 2     | 2-#6-W   | EXTENSION  |
| 4              | 1       | 1-#4-S   | NORMAL     |
|                | 2       | 2-#4-S   | DELAY      |
| 5              | 1       | 1-#5-E   | NORMAL     |
|                | 2       | -        | -          |

■ ALL EQUIPMENT EXISTING UNLESS NOTED OTHERWISE  
▲ INTEGRAL CALL HOLD CAPABILITY (0-5 SECONDS, MINIMUM)  
♦ INTEGRAL CALL DELAY CAPABILITY (0-30 SECONDS, MINIMUM)

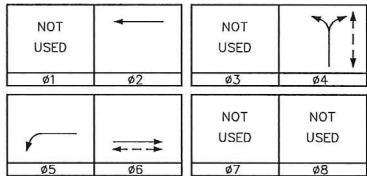
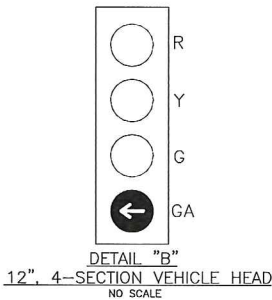

\*NOTE : #3 AND #4 TO OPERATE AS SPLIT-PHASE

| POLE SCHEDULE |                 |          |      |                            |           |             |            |                         |      |      |               |          |              |
|---------------|-----------------|----------|------|----------------------------|-----------|-------------|------------|-------------------------|------|------|---------------|----------|--------------|
| POLE LOCATION | SIGNAL STANDARD |          |      | H.P.S. LUMINAIRE SIZE/TYPE | MOUNTINGS |             |            | PEDESTRIAN* PUSH BUTTON |      |      | POLE LOCATION |          | I.I.S.N.S.   |
|               | TYPE            | MAST ARM |      |                            | VEHICLE   |             | PEDESTRIAN | PHASE                   | TYPE | QUAD | A             | B        |              |
|               |                 | SIG.     | LUM. |                            | POLE      | MAST ARM    |            |                         |      |      |               |          |              |
| (A)           | 24-4-70         | 35'      | 15'  | 200W                       | SV-2-TA   | 2-MAS F=17' | -          | -                       | -    | -    | EXISTING      | EXISTING | Blue Lantern |
| (B)           | 19A-4-70        | 30'      | 15'  | 200W                       | SV-2-TA   | MAS-4B      | *SP-1-T    | Ø4                      | B    | W    | EXISTING      | EXISTING | Stonehill Dr |
| (C)           | 17-2-70         | 20'      | 15'  | 200W                       | SV-1-T    | MAS         | *SP-1-T    | Ø4                      | B    | W    | EXISTING      | EXISTING | Blue Lantern |
| (D)           | 1-A             | -        | -    | -                          | TV-1-T    | -           | *SP-1-T    | Ø6                      | B    | N    | EXISTING      | EXISTING | -            |
| (E)           | 15              | -        | 15'  | 200W                       | SV-1-T    | -           | *SP-1-T    | Ø6                      | B    | S    | EXISTING      | EXISTING | -            |

ALL EQUIPMENT IS EXISTING.

\* = PEDESTRIAN INDICATION HEADS SHALL BE DIALITE COUNTDOWN HEADS, MUTCD COMPLIANT.  
(B) = BULL DOG PUSH BUTTON.

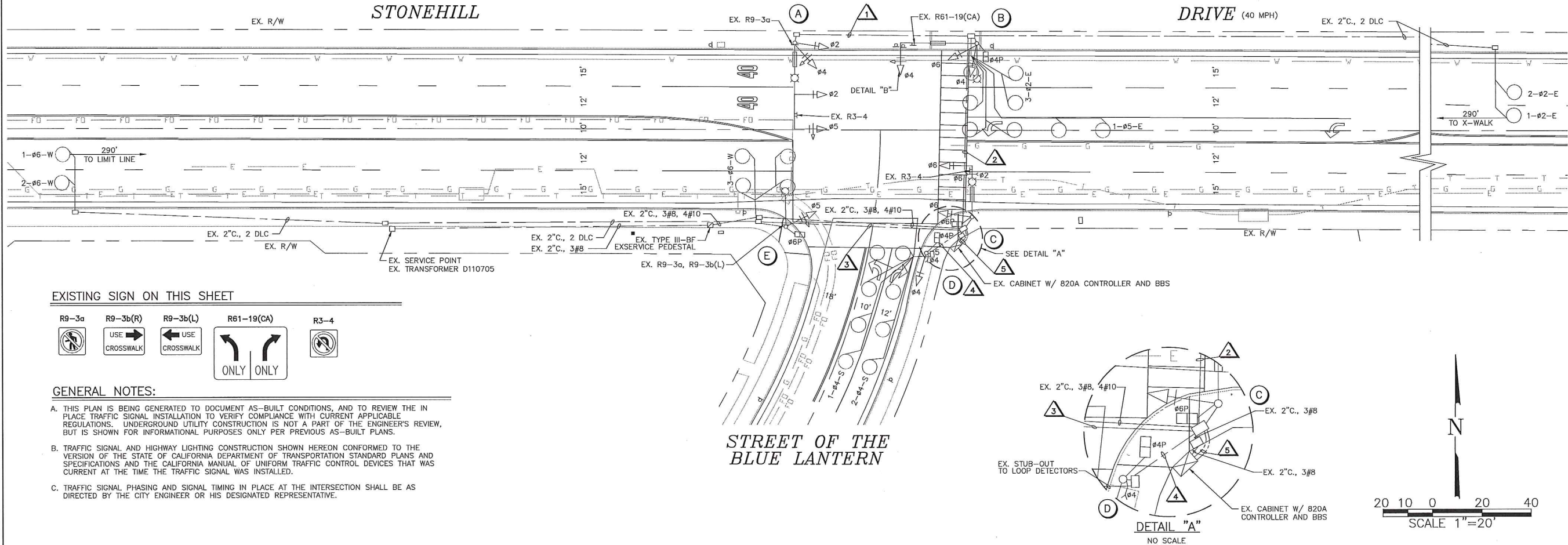
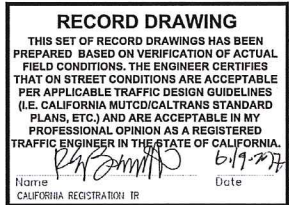

#### EXISTING SIGN ON THIS SHEET

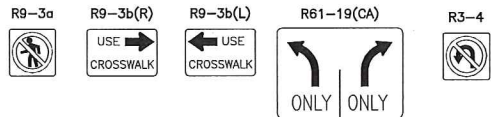

#### GENERAL NOTES:

- THIS PLAN IS BEING GENERATED TO DOCUMENT AS-BUILT CONDITIONS, AND TO REVIEW THE IN PLACE TRAFFIC SIGNAL INSTALLATION TO VERIFY COMPLIANCE WITH CURRENT APPLICABLE REGULATIONS. UNDERGROUND UTILITY CONSTRUCTION IS NOT A PART OF THE ENGINEER'S REVIEW, BUT IS SHOWN FOR INFORMATIONAL PURPOSES ONLY PER PREVIOUS AS-BUILT PLANS.
- TRAFFIC SIGNAL AND HIGHWAY LIGHTING CONSTRUCTION SHOWN HEREON CONFORMED TO THE VERSION OF THE STATE OF CALIFORNIA DEPARTMENT OF TRANSPORTATION STANDARD PLANS AND SPECIFICATIONS AND THE CALIFORNIA MANUAL OF UNIFORM TRAFFIC CONTROL DEVICES THAT WAS CURRENT AT THE TIME THE TRAFFIC SIGNAL WAS INSTALLED.
- TRAFFIC SIGNAL PHASING AND SIGNAL TIMING IN PLACE AT THE INTERSECTION SHALL BE AS DIRECTED BY THE CITY ENGINEER OR HIS DESIGNATED REPRESENTATIVE.

| NO. | DATE | REVISIONS | APP. | DATE |
|-----|------|-----------|------|------|
|     |      |           |      |      |
|     |      |           |      |      |
|     |      |           |      |      |

#### PLAN PREPARED BY:

LINSCOTT, LAW & GREENSPAN, ENGINEERS  
TRANSPORTATION PLANNING - TRAFFIC ENGINEERING - PARKING  
600 South Lake Avenue, Suite 500, Pasadena, Ca 91106 (626) 796-2322  
2 Executive Circle, Suite 250, Irvine, Ca 92614 (949) 825-8175  
4542 Bufler Street, Suite 100, San Diego, Ca 92111 (619) 305-8800



PLANS REVIEWED BY:  
CITY OF DANA POINT, PUBLIC WORKS & ENGINEERING SERVICES  
33282 GOLDEN LANTERN  
DANA POINT, CA 92629

MATTHEW V. SINACORI, CITY ENGINEER  
RCE #59239 EXP. 06/30/17  
DATE 6/26/17  
THIS PLAN IS SIGNED BY THE CITY ENGINEER FOR SCOPE AND ADHERENCE TO CITY STANDARDS AND REQUIREMENTS, CITY CODES, AND OTHER GENERAL ENGINEERING AND REGULATORY REQUIREMENTS ONLY. THE CITY ENGINEER IS NOT RESPONSIBLE FOR DESIGN, ASSUMPTIONS, OR ACCURACY.



TRAFFIC SIGNAL PLAN  
STONEHILL DRIVE AT  
ST. OF THE BLUE LANTERN  
THE CITY OF DANA POINT  
Public Works Department

PROJECT NO.  
2-16-3741  
SHEET 1  
OF 1

n:\2020\2113225-1 - city of dana point on-call services 2011 fye 2012, dana point\2017 traffic signal record drawings\stonehill at blue lantern\stonehill at blue lantern to record drawing 2017.dwg LDP 162436 06-06-2017 preep