

CONDUCTOR SCHEDULE																				
AWG SIZE OR CABLE TYPE		P O L E	PHASE	CONDUIT SIZE AND RUN																
				1	2	3	4	5	6	7	8	9	10							
NO.14 CABLES  12  3	CONDUCTOR ROUNDCONDUCTOR	(A)	Ø2,Ø5,OLB,Ø2P /Ø3PPB	—	—	—	2	1	—	—	—	—	2							
		(B)	Ø3,Ø4,OLA,Ø3P /Ø2PPB	—	—	—	—	2	1	—	—	—	2							
		(C)	Ø4,Ø4P /Ø2PPB	—	—	—	—	—	—	—	—	—	1							
		(D)	Ø1,Ø2,OLB,Ø2P /Ø4PPB	—	—	—	—	—	—	—	—	2	1							
		(E)	Ø1,Ø6,Ø6P /Ø4PPB	—	—	—	—	—	—	1	1	1	1							
		(F)	Ø3,Ø4,Ø4P /Ø6PPB	—	—	—	—	—	—	1	1	1	1							
		(G)	Ø3,OLA,Ø3P /Ø6PPB	2	1	2	1	2	1	—	—	—	2							
		(H)	Ø5,Ø6,Ø6P /Ø3PPB	—	1	1	1	1	1	—	—	—	1							
TOTAL CABLES		— 12 CON / 3 CON		2	1	3	2	3	5	3	7	4	1	2	2	2	4	3	12	8
#10	LUMINAIRES			2	2	2	2	2	—	2	2	2	—							
	SIGNAL COMMON			1	1	1	1	1	1	1	1	1	1	2						
	TOTAL			3	3	3	3	3	1	3	3	3	3	2						
#12	IISNS			2	2	2	2	2	—	2	2	2	—							
#6	SERVICE			—	—	—	—	—	—	2	2	2	2	2						
TYPE "B" DLC	Ø1			—	—	2	2	2	—	—	—	—	2							
	Ø2			—	—	—	—	—	—	—	—	3	3							
	Ø3			—	—	—	—	4	—	—	—	—	4							
	Ø4			—	—	—	—	—	1	1	1	1	1							
	Ø5			—	—	—	—	—	—	—	—	1	1							
	Ø6			—	2	2	2	2	—	—	—	—	2							
TOTAL				—	2	4	4	8	1	1	1	5	13							
SIC				—	—	—	—	—	—	—	—	—	1							
3M MODEL 138 EVP				—	—	—	1	1	—	1	1	1	4							
CCTV				—	—	—	1	1	—	—	—	—	1							
CONDUIT SIZES (INCHES)				3"	3"	3"	3"	3"	3"	3"	3"	3"	3"	2-3"						

ALL CONDUCTORS AND CONDUITS ARE EXISTING.  
PPB = PED PUSH BUTTON

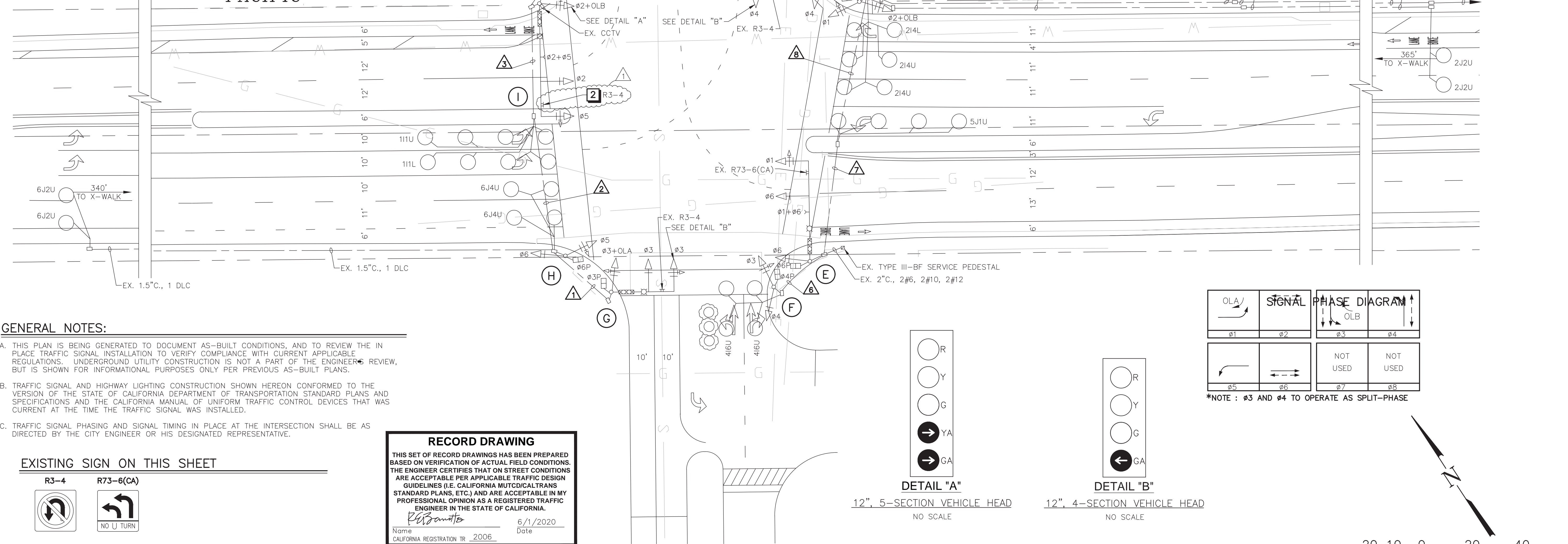

- GENERAL NOTES:**
- A. THIS PLAN IS BEING GENERATED TO DOCUMENT AS-BUILT CONDITIONS, AND TO REVIEW THE IN PLACE TRAFFIC SIGNAL INSTALLATION TO VERIFY COMPLIANCE WITH CURRENT APPLICABLE REGULATIONS. UNDERGROUND UTILITY CONSTRUCTION IS NOT A PART OF THE ENGINEER'S REVIEW, BUT IS SHOWN FOR INFORMATIONAL PURPOSES ONLY PER PREVIOUS AS-BUILT PLANS.
  - B. TRAFFIC SIGNAL AND HIGHWAY LIGHTING CONSTRUCTION SHOWN HEREON CONFORMED TO THE VERSION OF THE STATE OF CALIFORNIA DEPARTMENT OF TRANSPORTATION STANDARD PLANS AND SPECIFICATIONS AND THE CALIFORNIA MANUAL OF UNIFORM TRAFFIC CONTROL DEVICES THAT WAS CURRENT AT THE TIME THE TRAFFIC SIGNAL WAS INSTALLED.
  - C. TRAFFIC SIGNAL PHASING AND SIGNAL TIMING IN PLACE AT THE INTERSECTION SHALL BE AS DIRECTED BY THE CITY ENGINEER OR HIS DESIGNATED REPRESENTATIVE.

**EXISTING SIGN ON THIS SHEET**

R3-4

R73-6(CA)

**TRAFFIC SIGNAL CONSTRUCTION NOTES**

2 REMOVE SIGN FROM SIGNAL MAST ARM AS SHOWN.

**RECORD DRAWING**

THIS SET OF RECORD DRAWINGS HAS BEEN PREPARED BASED ON VERIFICATION OF ACTUAL FIELD CONDITIONS. THE ENGINEER CERTIFIES THAT ON STREET CONDITIONS ARE ACCEPTABLE PER APPLICABLE TRAFFIC DESIGN GUIDELINES (I.E. CALIFORNIA MUTCD/CALTRANS STANDARD PLANS, ETC.) AND ARE ACCEPTABLE IN MY PROFESSIONAL OPINION AS A REGISTERED TRAFFIC ENGINEER IN THE STATE OF CALIFORNIA.

*R. Barretto* 6/1/2020  
Name Date  
CALIFORNIA REGISTRATION TR 2006

5/29/2020	REMOVE R3-4 SIGN				
NO.	DATE	REVISIONS	APP.	DATE	

PLAN PREPARED BY:

LINSCOTT, LAW & GREENSPAN, ENGINEERS

TRANSPORTATION PLANNING TRAFFIC ENGINEERING PARKING

234 East Colorado Boulevard, Suite 400, Pasadena, CA 91101 (626) 796-2322  
1580 Corporate Drive, Suite 122, Costa Mesa, CA 92626 (714) 641-1587  
4542 Ruffner Street, Suite 100, San Diego, CA 92111 (608) 300-8800

*R. Barretto* 6/1/2020  
Name Date  
RICHARD E. BARRETTO R.T.E. #2006



PLANS REVIEWED BY:

CITY OF DANA POINT, PUBLIC WORKS & ENGINEERING SERVICES

33282 GOLDEN LANTERN  
DANA POINT, CA 92629

*Matthew V. Sinacori* 06/01/2020  
Signature Date

MATTHEW V. SINACORI  
DIRECTOR OF PUBLIC WORKS/CITY ENGINEER  
RCE #59239 EXP. 06/30/21

THIS PLAN IS SIGNED BY THE CITY ENGINEER FOR SCOPE AND ADHERENCE TO CITY STANDARDS AND REQUIREMENTS, CITY CODES, AND OTHER GENERAL ENGINEERING AND REGULATORY REQUIREMENTS ONLY. THE CITY ENGINEER IS NOT RESPONSIBLE FOR DESIGN, ASSUMPTIONS, OR ACCURACY.



TRAFFIC SIGNAL PLAN

CROWN VALLEY PARKWAY AT  
PACIFIC COAST HIGHWAY

**THE CITY OF DANA POINT**  
Public Works Department

PROJECT NO. ####

SHEET 1 OF 1

n:\3200\2113225-1 - city of dana point on-call services 2011 fye 2012 dana point\crown valley - pch to plan\crown valley - pch to plan\crown valley\3225ts pch-crown record drawing 2020.dwg LDP 16:13:29 06-01-2020 agular