

EQUIPMENT SCHEDULE												
LOCATION	SIGNAL STANDARD		H.P.S. LUMINAIRE SIZE/TYPE	MOUNTINGS			PEDESTRIAN PUSH BUTTON			POLE LOCATION		I.I.S.N.S.
	POLE TYPE	MAST ARM SIG. LUM.		VEHICLE POLE	MAST ARM	PEDESTRIAN	PHASE	TYPE	QUAD	A	B	
(A)	26-4-70	35' 15'	250W	SV-1-T	2-MAS F=12'	SP-1-T	Ø6	B	W	EXISTING	EXISTING	Niguel Rd
(B)	1-A	-	-	TV-1-T	-	SP-1-T	Ø8	A	N	EXISTING	EXISTING	-
(C)	26-4-70	45' 15'	250W	SV-1-T	2-MAS F=16'	SP-1-T	Ø8	A	N	EXISTING	EXISTING	Stonehill Dr
(D)	1-A	-	-	TV-2-T	-	SP-1-T	Ø2	A	E	EXISTING	EXISTING	-
(E)	19-4-70	25' 15'	200W	SV-1-T	2-MAS F=12'	-	Ø2	A	E	EXISTING	EXISTING	Niguel Rd
(F)	1-A	-	-	TV-2-T	-	SP-1-T	-	-	-	EXISTING	EXISTING	-
(G)	29-5-70	50' 15'	250W	SV-1-T	2-MAS F=19'	SP-1-T	-	-	-	EXISTING	EXISTING	Stonehill Dr
(H)	1-A	-	-	TV-2-T	-	-	Ø6	A	W	EXISTING	EXISTING	-

ALL EQUIPMENT IS EXISTING. (A) = ANODE PUSH BUTTON, (B) = BULL DOG PUSH BUTTON.

SENSOR TABLE			
SENSOR UNIT	CHANNEL	DETECTOR	ASSIGNMENT
1	1	1-Ø1	NORMAL
2	2	1-Ø6	EXTENSION
3	1	2-Ø6	NORMAL
4	2	3-Ø6	NORMAL
5	1	1-Ø5	NORMAL
6	2	1-Ø2	EXTENSION
7	1	2-Ø2	EXTENSION
8	2	3-Ø2	EXTENSION
9	1	4-Ø2	NORMAL
	2	5-Ø2	NORMAL
	1	1-Ø7	NORMAL
	2	1-Ø4	EXTENSION
	1	2-Ø4	EXTENSION
	2	3-Ø4	NORMAL
	1	4-Ø4	DELAY
	2	1-Ø3	NORMAL
	1	1-Ø8	NORMAL
	2	SPARE	NORMAL

■ ALL EQUIPMENT EXISTING.  
▲ INTEGRAL CALL HOLD CAPABILITY (0-5 SECOND, MINIMUM)  
♦ INTEGRAL CALL DELAY CAPABILITY (0-30 SECONDS, MINIMUM)

#### EXISTING SIGN ON THIS SHEET

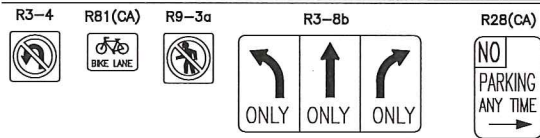

#### GENERAL NOTES:

- THIS PLAN IS BEING GENERATED TO DOCUMENT AS-BUILT CONDITIONS, AND TO REVIEW THE IN PLACE TRAFFIC SIGNAL INSTALLATION TO VERIFY COMPLIANCE WITH CURRENT APPLICABLE REGULATIONS. UNDERGROUND UTILITY CONSTRUCTION IS NOT A PART OF THE ENGINEER'S REVIEW, BUT IS SHOWN FOR INFORMATIONAL PURPOSES ONLY PER PREVIOUS AS-BUILT PLANS.
- TRAFFIC SIGNAL AND HIGHWAY LIGHTING CONSTRUCTION SHOWN HEREON CONFORMED TO THE VERSION OF THE STATE OF CALIFORNIA DEPARTMENT OF TRANSPORTATION STANDARD PLANS AND SPECIFICATIONS AND THE CALIFORNIA MANUAL OF UNIFORM TRAFFIC CONTROL DEVICES THAT WAS CURRENT AT THE TIME THE TRAFFIC SIGNAL WAS INSTALLED.
- TRAFFIC SIGNAL PHASING AND SIGNAL TIMING IN PLACE AT THE INTERSECTION SHALL BE AS DIRECTED BY THE CITY ENGINEER OR HIS DESIGNATED REPRESENTATIVE.

#### SIGNAL PHASE DIAGRAM

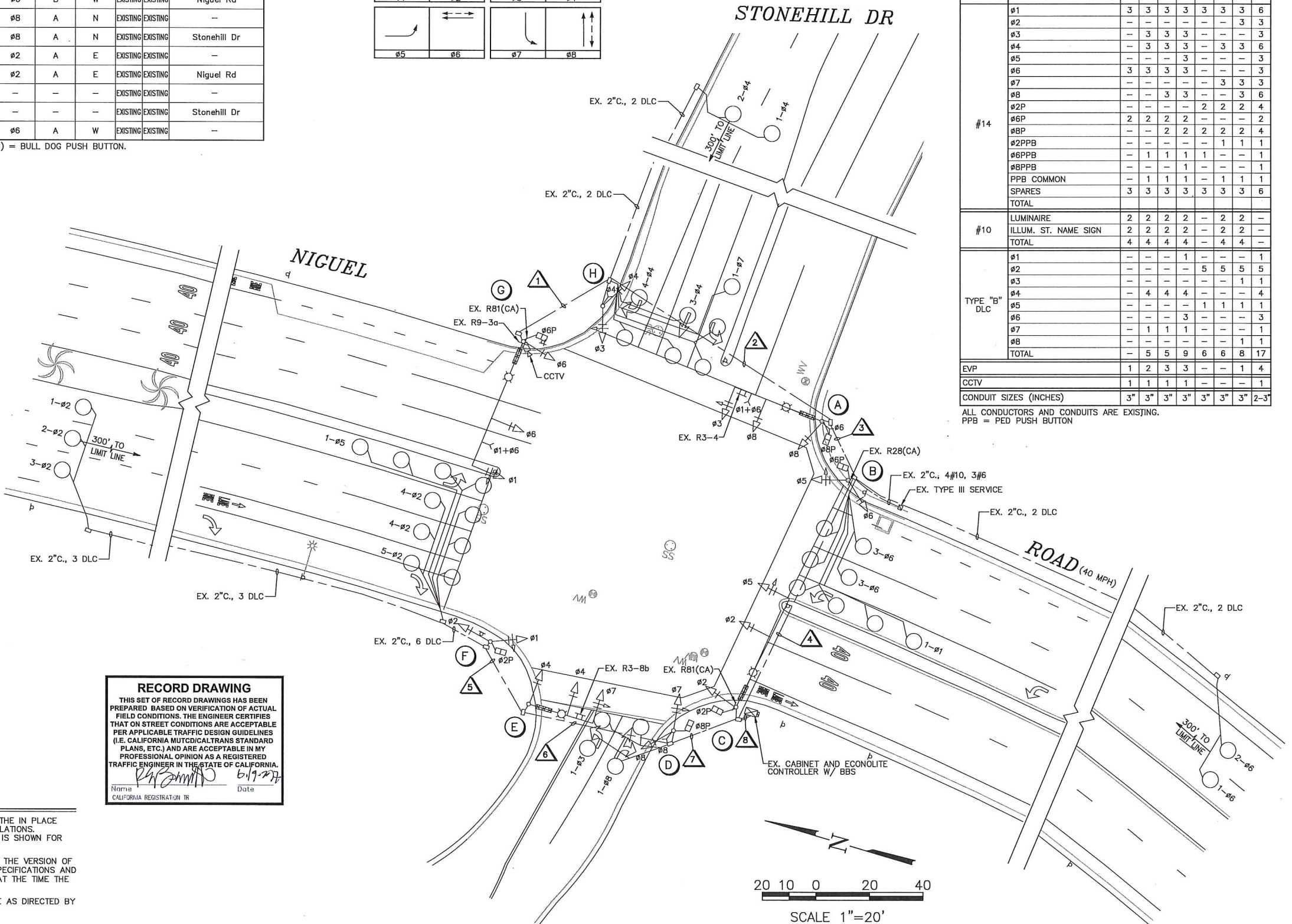
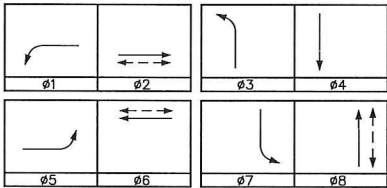

#### CONDUCTOR SCHEDULE

AWG	CIRCUIT	1	2	3	4	5	6	7	8
#14	Ø1	3	3	3	3	3	3	3	6
	Ø2	-	-	-	-	-	-	3	3
	Ø3	-	3	3	3	-	-	-	3
	Ø4	-	3	3	3	-	3	3	6
	Ø5	-	-	-	3	-	-	-	3
	Ø6	3	3	3	3	-	-	-	3
	Ø7	-	-	-	-	-	3	3	3
	Ø8	-	-	3	3	-	-	3	6
	Ø2P	-	-	-	2	2	2	2	4
	Ø6P	2	2	2	2	-	-	-	2
	Ø8P	-	-	2	2	2	2	2	4
	Ø2PPB	-	-	-	-	1	1	1	1
	Ø6PPB	-	1	1	1	1	-	-	1
	Ø8PPB	-	-	1	-	-	-	-	1
#10	PPB COMMON	-	1	1	1	-	1	1	1
	SPARES	3	3	3	3	3	3	3	6
TOTAL									
TYPE "B" DLC	LUMINAIRE	2	2	2	2	-	2	2	-
	ILLUM. ST. NAME SIGN	2	2	2	2	-	2	2	-
	TOTAL	4	4	4	4	-	4	4	-
EVP	Ø1	-	-	-	1	-	-	-	1
	Ø2	-	-	-	-	5	5	5	5
	Ø3	-	-	-	-	-	1	1	1
	Ø4	-	4	4	4	-	-	-	4
	Ø5	-	-	-	-	1	1	1	1
	Ø6	-	-	-	3	-	-	-	3
	Ø7	-	1	1	1	-	-	-	1
	Ø8	-	-	-	-	-	-	-	1
TOTAL		-	5	5	9	6	6	8	17
CCTV		1	2	3	3	-	-	-	1
		1	1	1	1	-	-	-	1
CONDUIT SIZES (INCHES)		3"	3"	3"	3"	3"	3"	3"	2-3"

ALL CONDUCTORS AND CONDUITS ARE EXISTING.  
PPB = PED PUSH BUTTON

**RECORD DRAWING**  
THIS SET OF RECORD DRAWINGS HAS BEEN PREPARED BASED ON VERIFICATION OF ACTUAL FIELD CONDITIONS. THE ENGINEER CERTIFIES THAT ON STREET CONDITIONS ARE ACCEPTABLE PER APPLICABLE TRAFFIC DESIGN GUIDELINES (I.E. CALIFORNIA MUTCD/CALTRANS STANDARD PLANS, ETC.) AND ARE ACCEPTABLE IN MY PROFESSIONAL OPINION AS A REGISTERED TRAFFIC ENGINEER IN THE STATE OF CALIFORNIA.  
Name: *[Signature]* Date: 6/19/17  
CALIFORNIA REGISTRATION NO. 118



PLANS REVIEWED BY:  
CITY OF DANA POINT, PUBLIC WORKS & ENGINEERING SERVICES  
33282 GOLDEN LANTERN  
DANA POINT, CA 92629

*[Signature]* 6/20/17  
MATTHEW V. SINACORI, CITY ENGINEER  
RCE #59239 EXP. 06/30/17

THIS PLAN IS SIGNED BY THE CITY ENGINEER FOR SCOPE AND ADHERENCE TO CITY STANDARDS AND REQUIREMENTS, CITY CODES, AND OTHER GENERAL ENGINEERING AND REGULATORY REQUIREMENTS ONLY. THE CITY ENGINEER IS NOT RESPONSIBLE FOR DESIGN, ASSUMPTIONS, OR ACCURACY.



TRAFFIC SIGNAL PLAN  
STREET OF THE STONEHILL DR AT  
NIGUEL ROAD

THE CITY OF DANA POINT  
Public Works Department

PROJECT NO.  
2-16-3741

SHEET 1  
OF 1

NO.	DATE	REVISIONS	APP.	DATE