

TYPE	36"	BACKHOE BUCKET	ELEVATION	794.5 feet	BORING	TP- 1						
		BAG 1	5	ML	FILL: Brown SANDY SILT with fine to coarse GRAVEL, approximately 5 percent COBBLES <1", water line at 1'							
				ML	NATIVE: Dark brown SANDY SILT Light brown fine to coarse SILTY SAND, with 30-40 percent GRAVEL and 15 percent COBBLES 3-10", three 15" boulders							
				SM CM								
					BEDROCK: Pale gray fine to medium SANDSTONE							
		BAG 3 BULK 1	10		NOTES: 1. Bedrock refusal at 12.5'. 2. No groundwater encountered. 3. Trench had little or no caving during digging, after 3 hours about 1'-2" had caved. 4. Backfilled and compacted 6/23/80.							
EXTINGUISHING DISP.	RELATIVE COMPACTION	DENSITY (GMS/CM ³)	MOISTURE (%)	BLOWS/FOOT	SAMPLE SIZE (INCHES)	SAMPLE NO.	DEPTH IN FEET	MATERIAL EXTENDED IN BOIL CLASS.	THIS BORING LOG SUMMARY APPLIES ONLY AT THE TIME AND LOCATION INDICATED. SUBSURFACE CONDITIONS MAY DIFFER AT OTHER LOCATIONS AND TIMES.			
									LOGGED BY	JBS	DATE	6-23-89

TYPE	36"	BACKHOE BUCKET		ELEVATION	794.5 feet	BORING TP - 2
SINK DOWN					ML:	FILL: Light brown SANDY SILT with approximately 20-30 percent GRAVEL.
IMMEDIATE COMPACTION						Rip rap boulders 10"-30" diameter with approximately 15 percent fine to coarse GRAVELLY SAND and 30 percent 3-10" COBBLES. <u>RIP RAP UP TO 40' across GeoFabric at 8'-9'</u>
TWO DAY CURETY (CLBS/COLFT)		BAG 1	10		SC NATIVE:	Light brown fine to medium CLAYEY SAND
MOISTURE (%)		BULK 2			BEDROCK:	Weathered gray fine to medium SANDSTONE
BLOWS/FOOT		BULK 3	15			... much harder digging at 15'
SAMPLE SIZE (INCHES)					NOTES:	1. Bedrock refusal at 17'. 2. No ground-water encountered. 3. Trench had very heavy caving in the rip rap from 2-7' and trench was 1'-2" wider on the sides. No further caving after 2 1/2 hours. 4. Backfilled 6/23/89.
SAMPLE NO.						
DEPTH IN FEET						
MATERIAL DIAPHRAM CUTTER SOIL CLASS.						
THIS BORING LOG SUMMARY APPLIES ONLY AT THE TIME AND LOCATION INDICATED. SUBSURFACE CONDITIONS MAY DIFFER AT OTHER LOCATIONS AND TIMES.						
LOGGED BY JBS	DATE	6-23-89				

TYPE	36"	BACKHOE BUCKET	ELEVATION	795.5 feet	BORING	TP-3
STRIKE DIP					FILL: Brown fine to medium SILTY SAND with scattered fine GRAVEL. Rip rap boulders 10-25" most approximately 24" with 25 percent fine to coarse GRAVEL. ... Geofabric at 8'	
RELATIVE CORROSION					NATIVE: Dark brown fine to coarse GRAVELLY SAND, 30-40 percent GRAVEL <3" diameter, some 6"-10" COBBLES, moist, some SILT ... increasing COBBLES 5"-10" approximately 20-30 percent ... water seepage at 15'	
DRY DENSITY (LBS/CU.FT.)					BEDROCK: Gray fine to medium SANDSTONE	
MOISTURE (%)					NOTES:	
BLDG./FOOT					1. Bedrock refusal at 19'.	
SAMPLE SIZE (INCHES)					2. After 1 hour water level rose to 17' depth.	
SAMPLE No.					3. Very heavy caving 2-8' and some caving 6-10', approximately 1' wider on sides.	
DEPTH IN FEET					4. Backfilled and compacted 8/28/80.	
PHYSICAL UNIFIED DESCRIPTIONS					THIS BORING LOG SUMMARY APPLIES ONLY AT THE TIME AND LOCATION INDICATED. SUBSURFACE CONDITIONS MAY DIFFER AT OTHER LOCATIONS AND TIMES.	
					LOGGED BY JBS	DATE 6-23-89

TYPE	36"	BACKHOE BUCKET	ELEVATION	795.0 feet	BORING	TP - 4							
					5M	FILL: Brown fine to coarse GRAVELLY SAND with SILT, approximately 20-30 percent GRAVEL, 10-25 percent COBBLES 3-10", one 24" boulder ... scattered rip rap up to 36" diameter from 3-6'							
		BAG 1	5		SW	NATIVE: Brown fine to coarse GRAVELLY SAND with scattered COBBLES 3-12" approximately 20-40 percent GRAVEL and 10-30 percent COBBLES							
		BAG 2	15		GW								
						BEDROCK: Gray fine to medium SANDSTONE							
						NOTES: 1. Bedrock refusal at 17.5'. 2. After 1/2 hour water level rose to 17" depth. 3. Caving throughout depth of trench, approximately 1' wider on sides. 4. Backfilled and compacted 6/23/80.							
STRIKE DIP	RELATIVE CORRELATION	DRY DENSITY (LBS/CU.FT)	MOISTURE (%)	BLOWS/FOOT	SAMPLE SIZE (INCHES)	SAMPLE No.	DEPTH IN FEET	MATERIAL TYPE US SOIL CLASS.	THIS BORING LOG SUMMARY APPLIES ONLY AT THE TIME AND LOCATION INDICATED. SUBSURFACE CONDITIONS MAY DIFFER AT OTHER LOCATIONS AND TIMES.	LOGGED BY	JBS	DATE	6-23-89

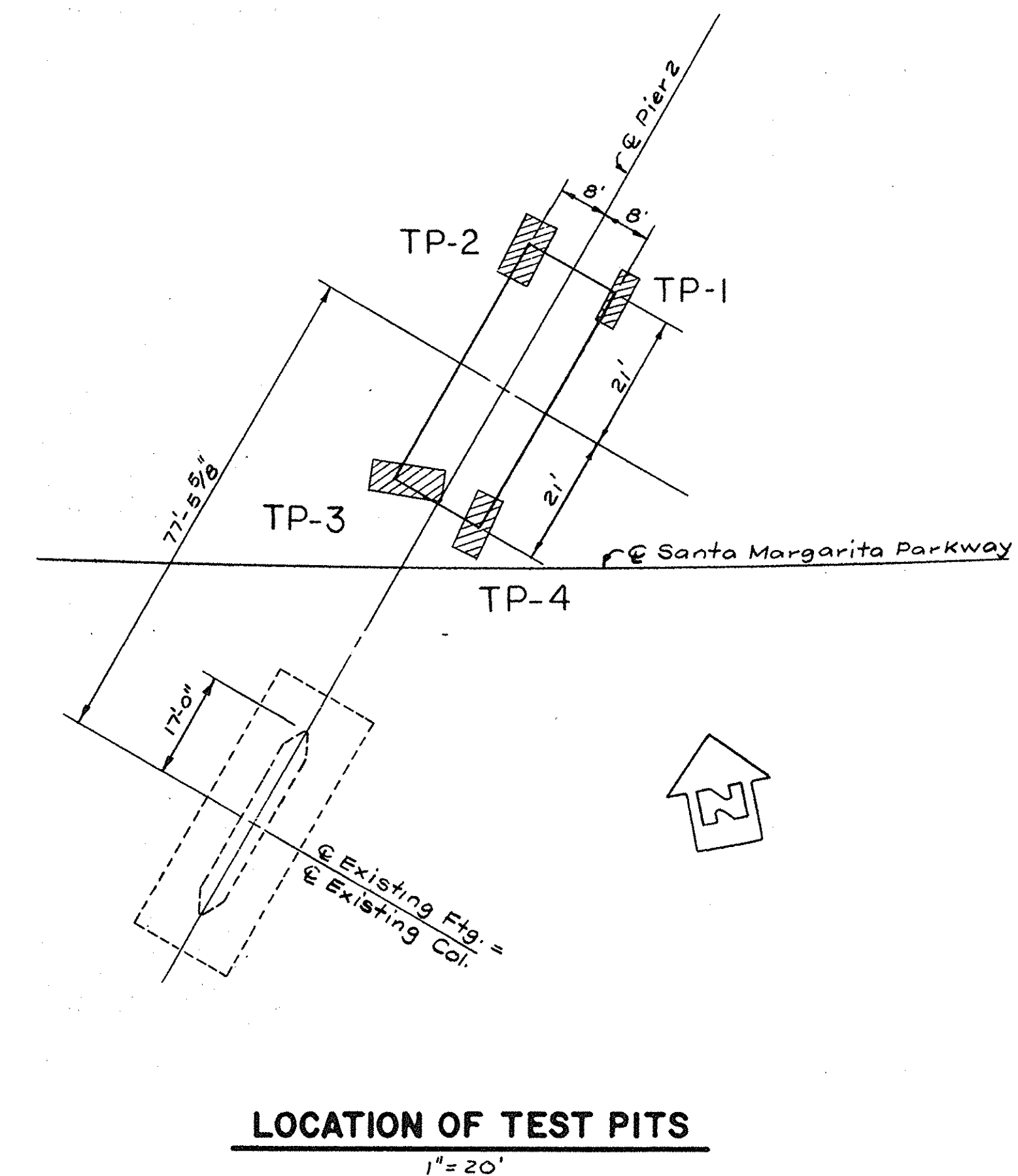

GEOTECHNICAL INVESTIGATION PERFORMED BY :

MOORE & TABER
GEOTECHNICAL ENGINEERS & GEOLOGISTS
4530 East La Palma Avenue
Anaheim, California 92807
Telephone (714) 779-2591

GEOTECHNICAL ENGINEERS & GEOLOGISTS
4530 East La Palma Avenue
Anaheim, California 92807
Telephone (714) 779-2591

4530 East La Palma Avenue
Anaheim, California 92807
Telephone (714) 779-2591

Anaheim, California 92807

Telephone (714) 779-2591

 **McDANIEL ENGINEERING COMPANY, INC.**
3690 OLD TOWN AVE., SUITE 307B, SAN DIEGO, CA 92110 (619)592-1920

APPROVED BY	R.C.E.	EXPIRES	DATE
<i>W. Mark [Signature]</i>	C 34299*	9-30-91	6-28-88

DESIGNED BY WMA DRAWN BY RLA CHECKED BY CCC FIELD BOOK	DESIGNED BY
	WMA
	DRAWN BY
	RLA

RLA

CHECKED BY
CCC

FIELD BOOK

**SANTA MARGARITA PARKWAY BRIDGE
OVER ARROYO TRABUCO - WIDENING**

LOG OF TEST BORINGS - 3 .

AS BUILT 3.93 SLH

SHEET
45
OF
57
SHEETS

9.

DR. 19-15799