

**PROFILE**  
HORIZ. 1m : 500m  
VERT. 1m : 200m

- NOTES:**
1. THE JARDINES INTERSECTION SHALL BE CONSTRUCTED BY A SEPARATE CITY OF MISSION VIEJO CONTRACT. THE EASTERLY CURB RETURNS ON JARDINES ARE SHOWN IN THEIR PROPOSED LOCATION.
  2. UTILITIES TO BE INSTALLED BY UTILITY COMPANIES ARE NOT SHOWN. SEE OTHER PLAN SHEETS AND SPECIAL PROVISIONS.

UTILITIES	OWNER
A GAS LINE	THE GAS COMPANY
B WATER LINE	SANTA MARGARITA WATER DISTRICT
C ELECTRICAL LINE	SDG&E
D SEWER LINE	ORANGE COUNTY SANITATION DISTRICT
E FUEL LINE	SANTA FE PACIFIC
F TELEPHONE LINE	PACIFIC BELL
G CABLE LINE	COX

- CONSTRUCTION NOTES**
1. CONSTRUCT 315 mm AC OVER NATIVE SOIL
  2. CONSTRUCT PCC CURB & GUTTER TYPE A2-200(8) PER PFRD STD PLAN 120-1-OC OVER 200 mm AGGREGATE BASE
  3. CONSTRUCT PCC SIDEWALK PER PFRD STD PLAN 1205
  4. CONSTRUCT PCC CURB TYPE C1-200(8) PER PFRD STD PLAN 120-1-OC
  5. CONSTRUCT INLET TYPE II PER PFRD STD PLAN 1302
  6. CONSTRUCT LOCAL DEPRESSION PER PFRD STD PLAN 1308 AND DETAIL A ON SHEET 6
  7. CONSTRUCT CURB & GUTTER TRANSITION FROM A2-200(8) TO A2-200(8) W/O GUTTER
  8. INSTALL 7.62 m OF METAL BEAM GUARD RAIL (TYPE 1A LAYOUT, CONNECT TO BARRIER/WALL) PER CALTRANS STD PLAN RSP A77D
  9. INSTALL TERMINAL SYSTEM (TYPE SRT) PER CALTRANS STD PLAN NSPA77L
  10. CONSTRUCT 100 mm STAMPED CONCRETE
  11. COLD PLANE 38 mm AC PAVEMENT
  12. CONSTRUCT 38 mm RUBBERIZED AC
  15. CONSTRUCT 200 mm MINOR CONCRETE

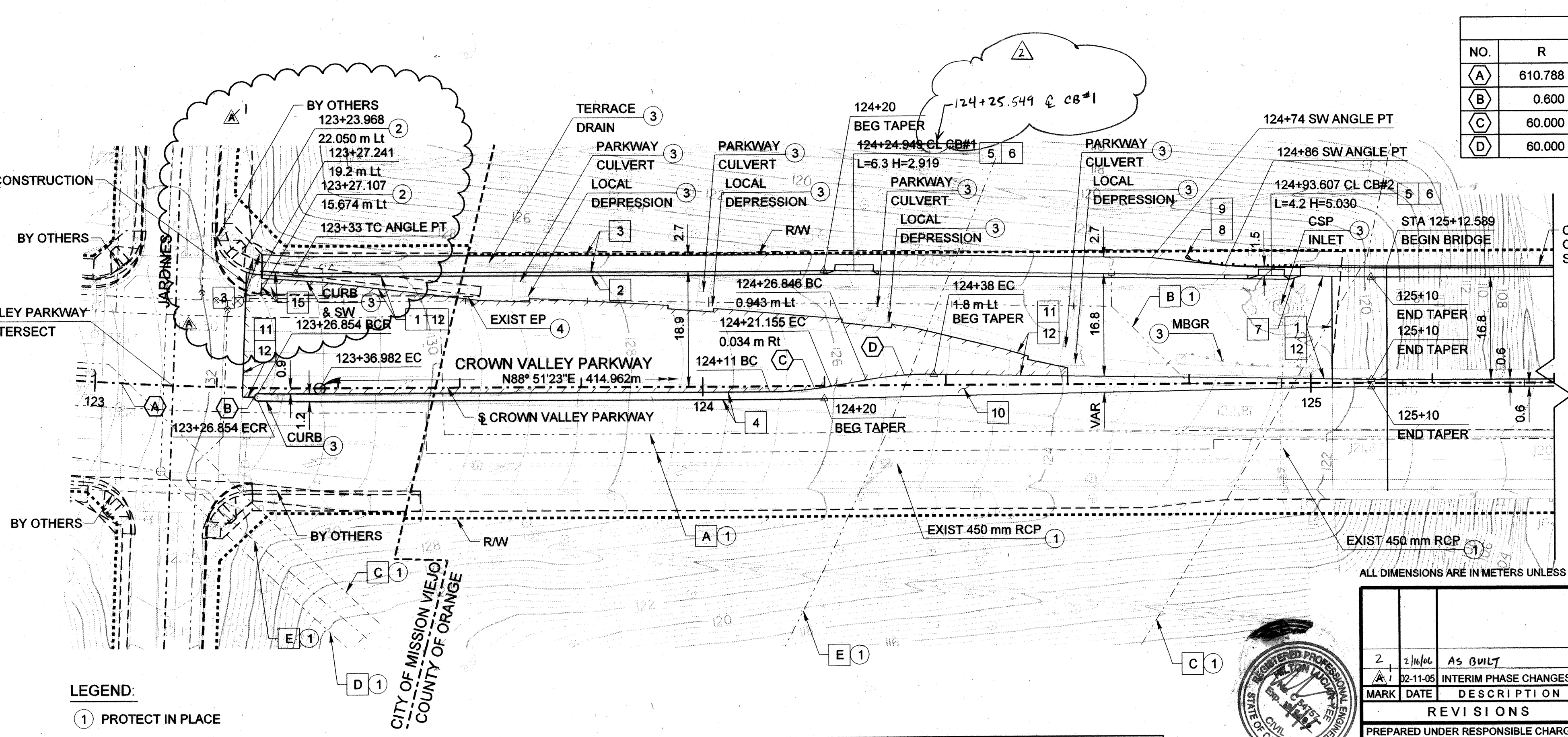

CURVE DATA				
NO.	R	Δ	T	L
(A)	610.788	17°35'58"	94.552	187.615
(B)	0.600	180°00'00"	-	1.885
(C)	60.000	9°44'39"	5.114	10.204
(D)	60.000	10°41'54"	5.618	11.203

**PLAN**  
1m : 500m

- LEGEND:**
- ① PROTECT IN PLACE
  - ② JOIN
  - ③ REMOVE
  - ④ SAWCUT

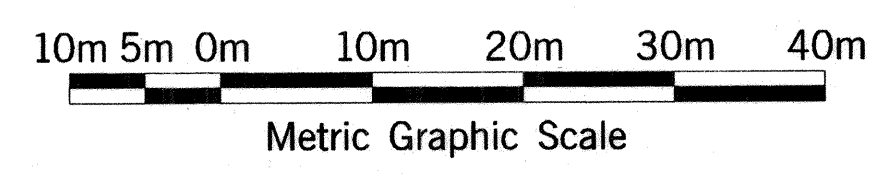

County of Orange  
PFRD/ROAD DIVISION-TRAFFIC ENGINEERING

Approved By: \_\_\_\_\_ Date: \_\_\_\_\_

I.G. OCHOA, County Traffic Engineer

THIS PLAN IS SIGNED BY PFRD/T.E. FOR CONCEPT AND ADHERENCE TO COUNTY TRAFFIC SIGNALS, SIGNING AND STRIPING STANDARDS AND REQUIREMENTS ONLY. PFRD/T.E. IS NOT RESPONSIBLE FOR DESIGN ASSUMPTIONS OR ACCURACY.

**Washington**  
Washington Infrastructure Services, Inc.  
17300 Redhill Avenue, Suite 150  
Irvine, CA 92614

REVISIONS	
MARK	DESCRIPTION
2	2/16/04 AS BUILT
1	12-11-05 INTERIM PHASE CHANGES
PREPARED UNDER RESPONSIBLE CHARGE OF:	
GONZALO R. PEÑA	
No. 44133	
Exp. 6/30/05	
CIVIL	

ORANGE COUNTY  
PUBLIC FACILITIES AND RESOURCES DEPARTMENT

**CROWN VALLEY PARKWAY**  
STA 123+19 TO STA 125+12.589

**PLAN AND PROFILE**

DESIGNED: K. NGUYEN  
DRAWN: K. NGUYEN  
CHECKED: G. R. PEÑA

SCALE: AS SHOWN  
DATE: MAY 01, 2003  
DRAWING NO. \_\_\_\_\_

SHEET  
**R4**  
OF 55