

BENTS 2, 3 & 4 PLAN

#7 STIRRUPS
SPACING EXCEPT AS
NOTED, PLACE
PARALLEL
TO GIRDERS

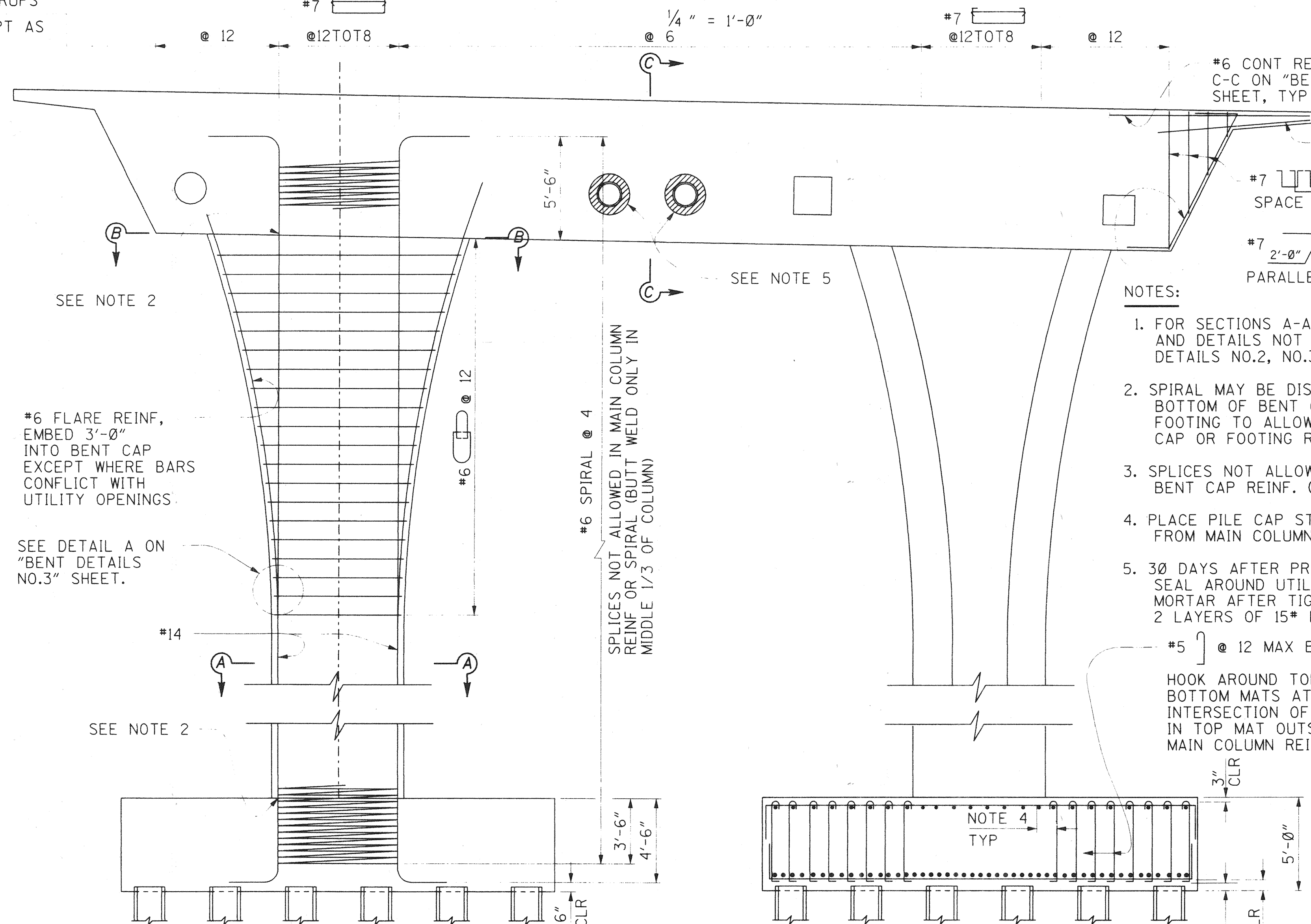

BENTS 2, 3 & 4 ELEVATION

5" EMBEDMENT
TYP

NOTES:

1. FOR SECTIONS A-A, B-B, C-C, AND DETAILS NOT SHOWN SEE "BENT DETAILS NO.2, NO.3 AND NO.4" SHEETS.
2. SPIRAL MAY BE DISCONTINUOUS AT BOTTOM OF BENT CAP OR TOP OF FOOTING TO ALLOW FOR PLACING CAP OR FOOTING REINFORCEMENT.
3. SPLICES NOT ALLOWED IN MAIN BENT CAP REINF. (BUTT WELD ONLY)
4. PLACE PILE CAP STIRRUPS 6" MAX FROM MAIN COLUMN REINFORCEMENT.
5. 30 DAYS AFTER PRESTRESSING IS COMPLETE, SEAL AROUND UTILITY WITH CONCRETE OR MORTAR AFTER TIGHTLY WRAPPING WITH 2 LAYERS OF 15# BUILDING PAPER.

#5 @ 12 MAX BOTHWAYS,
HOOK AROUND TOP AND
BOTTOM MATS AT EACH
INTERSECTION OF BARS
IN TOP MAT OUTSIDE
MAIN COLUMN REINF.

#6 CONT REINF, SEE SECTION
C-C ON "BENT DETAILS NO.3"
SHEET, TYP

#6 X 8'-0" @ 12 TOT 10
WITHIN BENT CAP, TYP
#7 TOT 4
SPACE TO CLEAR P/S DUCTS, TYP

#7 2'-0" @ 12 TOT 10, PLACE
PARALLEL TO BENT, TYP

BENTS 2, 3 & 4 FOOTING REINFORCEMENT

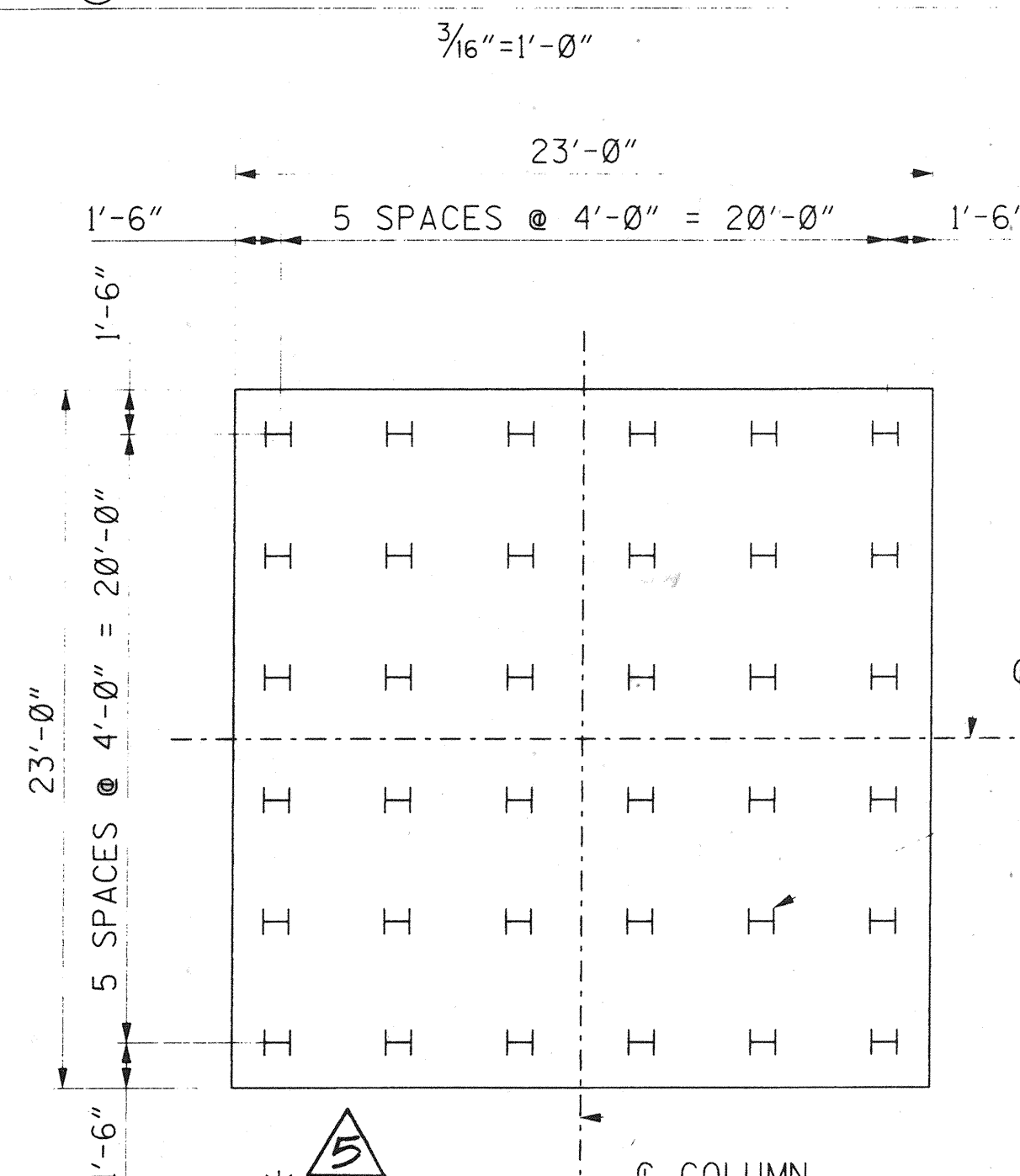

BENTS 2, 3 & 4 PILE LAYOUT

HP 14X89 DRIVEN
PILE, FOR ANCHOR
DETAILS SEE "INDEX TO
PLANS" SHEET, TYP

* SEE BENT 2 FOOTING REINFORCEMENT &
PILE LAYOUT ON "BENT DETAILS NO. 4"
SHEET.

PLAN PREPARED BY:

HNTB

36 EXECUTIVE PARK
SUITE 200
IRVINE, CALIFORNIA 92614

ORANGE COUNTY ENVIRONMENTAL MANAGEMENT AGENCY		ANTONIO PARKWAY BRIDGE OVER SAN JUAN CREEK	
BENT DETAILS NO.1		J DR-3 (16158) Sheet 60 of 126	
DESIGNED	Steve A. Whitaker	CHECKED	R. Hart
DRAWN	L. West	DATE	12/27
SCALE	AS SHOWN	DRAWING NO.	60
OF 126		OF 126	

DR-3 16158