

**GIRDER LAYOUT**  
1" = 10'-0"  
CONCRETE BARRIER AND MEDIAN NOT SHOWN FOR CLARITY

- LEGEND**
- DENOTES EXIST STRUCTURE
  - DENOTES NEW STRUCTURE
  - CLOSURE POUR
  - SOFFIT ACCESS OPENING
  - EXIST DECK ACCESS OPENING
  - EXIST SOFFIT ACCESS OPENING

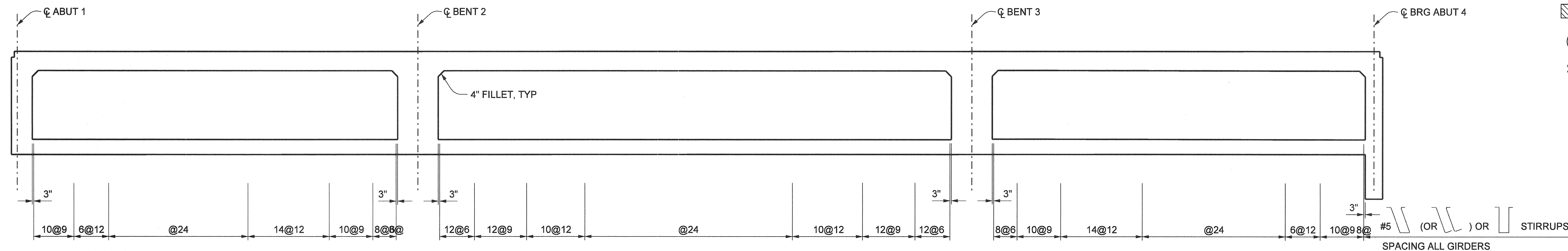

**LONGITUDINAL SECTION**  
NO SCALE

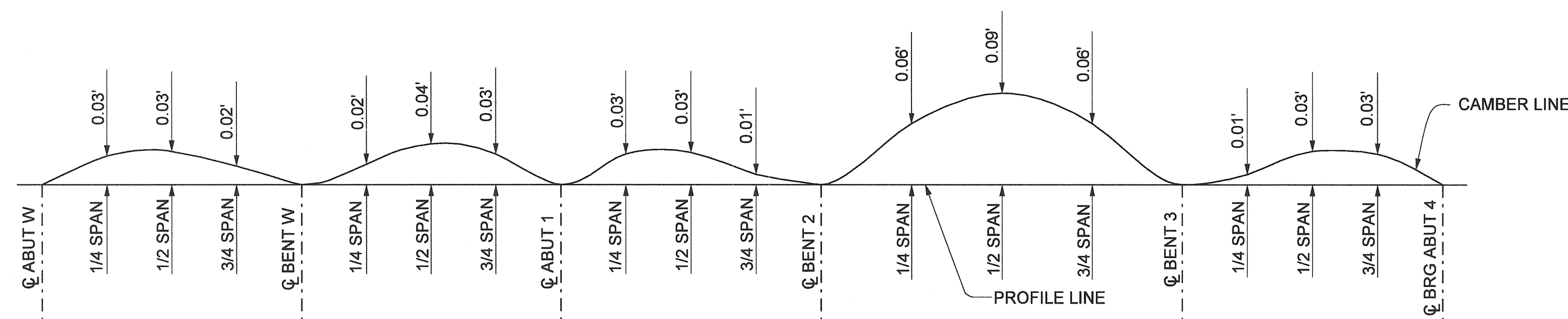

**CAMBER DIAGRAM**  
NO SCALE  
CAMBER DOES NOT INCLUDE ALLOWANCE FOR FALSEWORK SETTLEMENT.

**NOTE:**  
THE CONTRACTOR SHALL VERIFY ALL CONTROLLING FIELD DIMENSIONS BEFORE ORDERING OR FABRICATION ANY MATERIAL.  
BEND BOTTOM REINFORCEMENT FOR SOFFIT ACCESS OPENINGS

**AS BUILT**  
CORRECTION BY:       MN        
CONTRACT NO.:       ER28121        
DATE:       12/30/2009      

PLANS PREPARED BY:  
**HNTB**  
HNTB Corporation  
200 E. SANDPOINTE AVENUE, SUITE 200  
SANTA ANA, CALIFORNIA 92707  
TEL (714) 460-1600 FAX (714) 460-1610

ORANGE COUNTY RESOURCES & DEVELOPMENT MANAGEMENT DEPT		ANTONIO PARKWAY WILDLIFE UNDERCROSSING (WIDEN)		SHEET <b>59</b> OF 72	
GIRDER LAYOUT					
DESIGNED	J. WANG		CHECKED	F. JEANG	
DRAWN	L. ZHANG		SCALE	DATE	
Yung-Nien Wang RCE C 43559 (EXP. 6-30-06)		Yung-Nien Wang RCE C 43559 (EXP. 6-30-06)		DATE 12/31/06	