

### CONSTRUCTION NOTES

- 71 ALL WORK AND MATERIAL SHALL CONFORM TO THE STATE STANDARD PLANS AND SPECIFICATIONS DATED JULY 2002 AND THE CURRENT TRAFFIC MANUAL.
- 72 PAINT 6" WHITE BIKE LANE LINE PER DETAIL 39.
- 73 PAINT 4" WHITE LANE LINE PER DETAIL 9.
- 74 INSTALL LEFT EDGE LINE PER DETAIL 26.
- 75 PAINT 50' SOLID 4" WHITE WITH TYPE G RPM AT END POINTS.
- 76 PAINT 8" WHITE PER DETAIL 38.
- 77 PAINT 4" WHITE PER DETAIL 27B.
- 78 PAINT 6" WHITE BIKE LANE LINE PER DETAIL 39A.
- 80 REMOVE CONFLICTING STRIPING BY SANDBALSTING.
- 81 INSTALL MEDIAN NOSE TREATMENT PER DETAIL HEREON.
- 82 INSTALL TYPE IV ARROW MARKING.

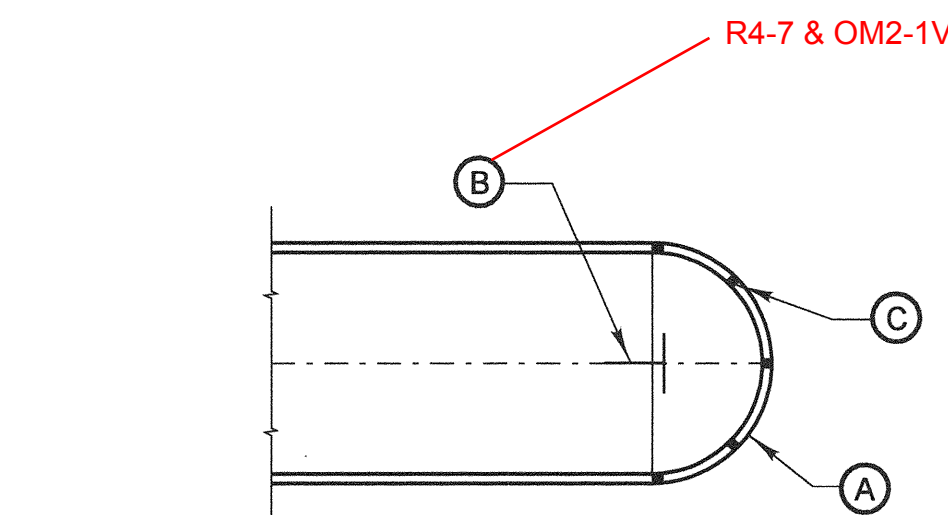

**MEDIAN NOSE TREATMENT**

### NOTES:

- (A) PAINT MEDIAN NOSE WITH HIGHLY REFLECTIVE PREMIXED WHITE TRAFFIC PAINT WITH GLASS BEADS.
- (B) INSTALL FLEXIBLE VERTICAL TYPE K-MARKER, R7, R10 OR TYPE N-1 ON TESLAR POST AS INDICATED ON THE PLAN.
- (C) INSTALL YELLOW REFLECTIVE PAVEMENT MARKERS ON TOP SURFACE OF MEDIAN CURB NOSE AT 2' C.C. SPACING (MIN. 5 MARKERS) PLACE REFLECTIVE SURFACE OF MARKERS PERPENDICULAR TO CL OF ROADWAY.

INSTALL FLEXIBLE VERTICAL TYPE OM2-1V, R4-7, R6-1 OR TYPE N-1 ON TESLAR POST AS INDICATED ON THE PLAN

**AS BUILT**

CORRECTION BY:           MN            
 CONTRACT NO.:           ER28121            
 DATE:           12/30/2009          

PLANS PREPARED BY: **HNTB** Corporation  
 200 E. SANDPOINTE AVENUE, SUITE 200  
 SANTA ANA, CALIFORNIA 92707  
 TEL (714) 460-1600 FAX (714) 460-1610

PLAN 1" = 40'		ORANGE COUNTY RESOURCES & DEVELOPMENT MANAGEMENT DEPT	
		ANTONIO PARKWAY WILDLIFE IMPROVEMENT PLANS	
		<b>STRIPING AND SIGNING PLAN S-2</b>	
DESIGNED <u>R. NIERE</u>		SHEET <b>37</b> OF 72	
DRAWN <u>N. BUNIA</u>		CHECKED <u>S. STROH</u>	
SCALE AS SHOWN		DATE 11/08/05	
DRAWING NO. xxx			