

13S2 - LINE C & F PROFILES

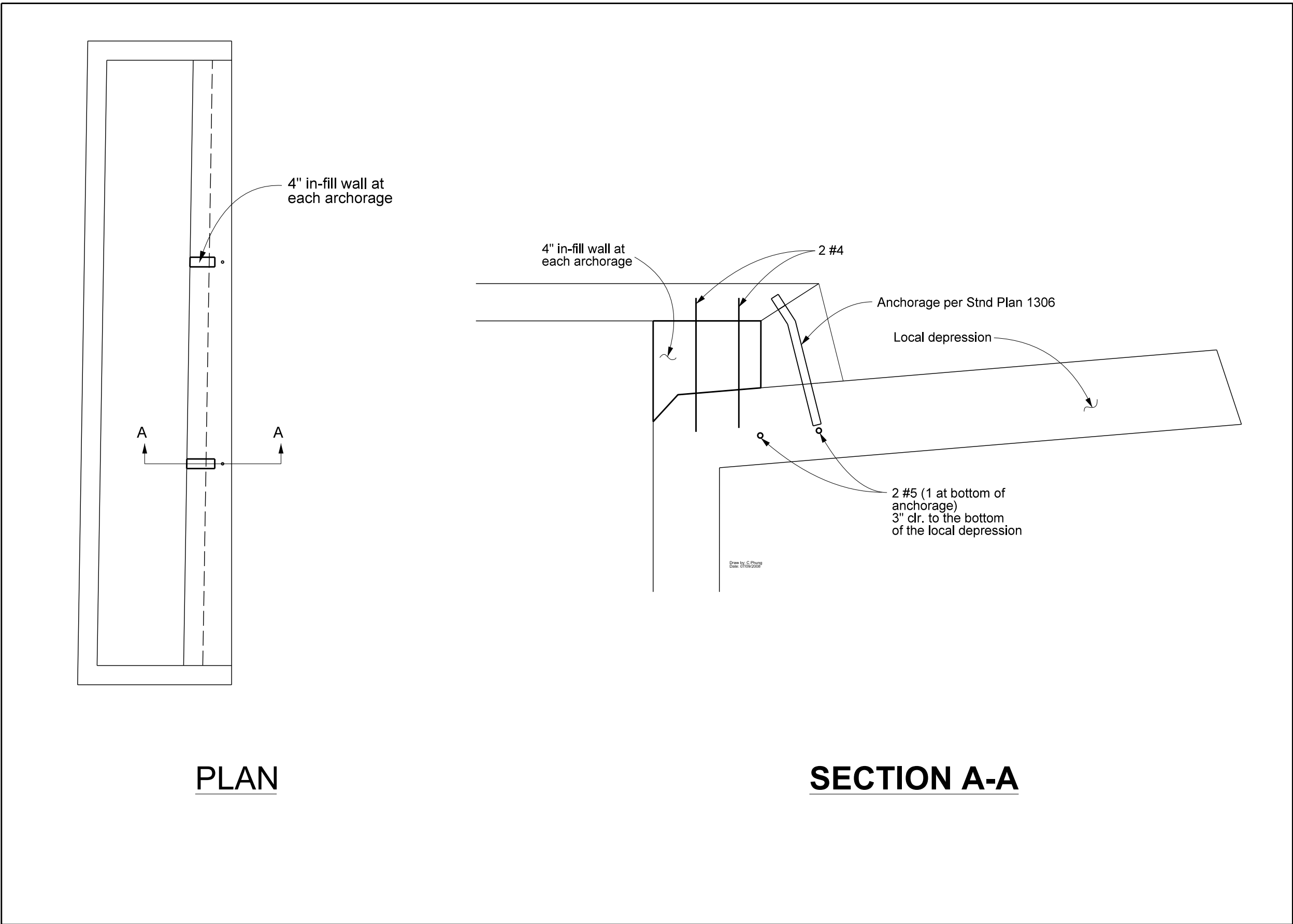

13S3 - INLET IN-FILL WALL

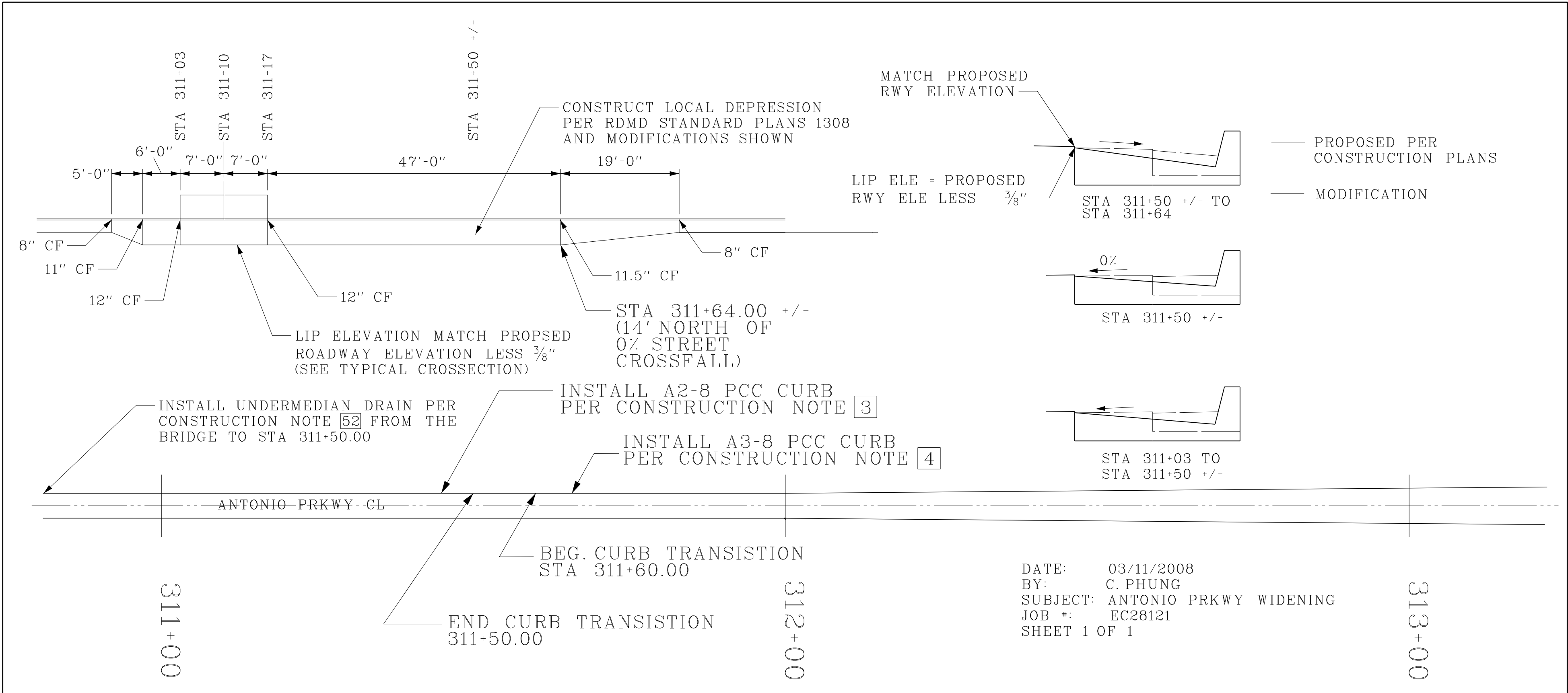

13S1 - MODIFIED DRAIN INLET & UNDERMEDIAN DRAIN ADDITION

AS BUILT

CORRECTION BY: MN

CONTRACT NO.: ER28121

DATE: 12/30/2009

PLAN 1" =		ORANGE COUNTY PUBLIC FACILITIES AND RESOURCES DEPARTMENT	
		ANTONIO PARKWAY WILDLIFE UNDERCROSSING (WIDEN)	
		STA 307+10 TO 316+50 DRAINAGE PLAN D-3	
MARK	DATE	DESCRIPTION	
REVISIONS			
PREPARED UNDER RESPONSIBLE CHARGE OF:			
DESIGNED	DRAWN		CHECKED
SCALE AS SHOWN	DATE	DRAWING NO.	
			SHEET 13S OF 72

Date Plotted:

File Name: