

PROFILE  
HORIZ. 1" = 40'  
VERT. 1" = 8'

**NOTE**

THE PROPOSED VERTICAL ALIGNMENT AND SUPERELEVATION OF ANTONIO PARKWAY IS BASED ON THE EXISTING ROADWAY. THE PROFILE AND SUPERELEVATION DIAGRAM OF THE EXISTING ROADWAY WAS CONSTRUCTED FROM THAT OF THE "ANTONIO PARKWAY PHASE III" PROJECT, WHICH IS INCLUDED AS A REFERENCE IN APPENDIX 7 OF THE PROJECT SPECIFICATIONS

**AS BUILT**

CORRECTION BY:         MN          
CONTRACT NO.:         EC28121          
DATE:         12/30/2009        

**CONSTRUCTION NOTES**

- 1 CONSTRUCT P.C.C. CURB & GUTTER TYPE A2-8 PER RDMD STD. PLAN 120-0-0C.
- 4 CONSTRUCT PCC CURB & GUTTER TYPE A3-8, W=12", PER RDMD STD PLAN 120-0-0C.
- 5 CONSTRUCT 14" A.C.
- 6 CONSTRUCT PCC SIDEWALK PER RDMD STD. PLAN 1205
- 7 REMOVE EXISTING CURB AND GUTTER STA 323+10 TO 325+48
- 9 COLD PLANE 2" AND RESURFACE A.C. PAVEMENT 2" MINIMUM.
- 12 CONSTRUCT PATTERN-STAMPED MEDIAN PAVING PER RDMD STD PLAN 1807. STA 305+00 TO 325+48
- 13 REMOVE EXISTING AC DIKE.
- 14 CONSTRUCT MEDIAN TAPER PER RDMD STD. 140-1-0C
- 16 REMOVE ASPHALT CONCRETE SURFACING.
- 20 REMOVE EXISTING PILASTER.
- 23 REMOVE TREE
- 25 REMOVE EXISTING A.C. SHOULDER AND CONSTRUCT 14" A.C.

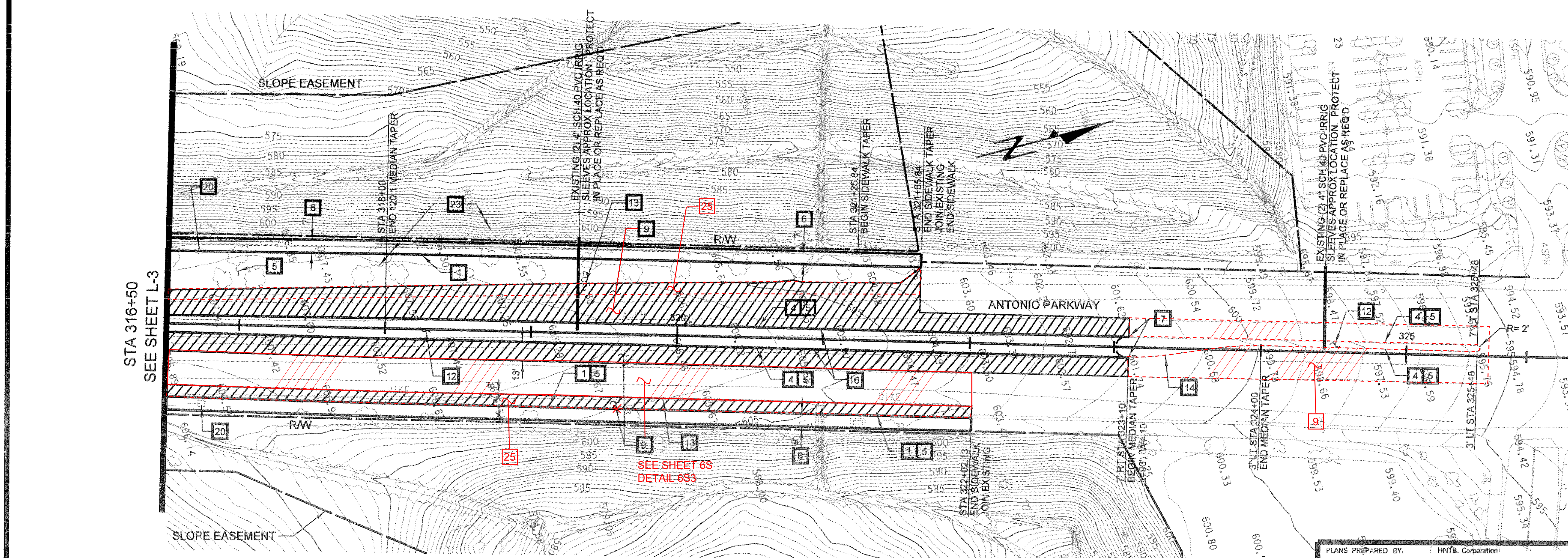

PLAN  
1" = 40'

ORANGE COUNTY  
RESOURCES & DEVELOPMENT MANAGEMENT DEPT

ANTONIO PARKWAY  
WILDLIFE  
IMPROVEMENT PLANS

STA 316+50 TO 325+00  
PLAN & PROFILE  
L-4

DESIGNED:         B. NISSE          
DRAWN:         N. BUNIA          
SCALE:         AS SHOWN        

DATE:         1/1/2005          
FILE NAME:         SDGN-FILE-NAMES

REVISIONS

MARK	DATE	DESCRIPTION
1		CONSTRUCT P.C.C. CURB & GUTTER TYPE A2-8 PER RDMD STD. PLAN 120-0-0C.
4		CONSTRUCT PCC CURB & GUTTER TYPE A3-8, W=12", PER RDMD STD PLAN 120-0-0C.
5		CONSTRUCT 14" A.C.
6		CONSTRUCT PCC SIDEWALK PER RDMD STD. PLAN 1205
7		REMOVE EXISTING CURB AND GUTTER STA 323+10 TO 325+48
9		COLD PLANE 2" AND RESURFACE A.C. PAVEMENT 2" MINIMUM.
12		CONSTRUCT PATTERN-STAMPED MEDIAN PAVING PER RDMD STD PLAN 1807. STA 305+00 TO 325+48
13		REMOVE EXISTING AC DIKE.
14		CONSTRUCT MEDIAN TAPER PER RDMD STD. 140-1-0C
16		REMOVE ASPHALT CONCRETE SURFACING.
20		REMOVE EXISTING PILASTER.
23		REMOVE TREE
25		REMOVE EXISTING A.C. SHOULDER AND CONSTRUCT 14" A.C.

PROFESIONAL ENGINEER  
STEVEN B. STRON  
NO.         C 55687          
EXP.         12-31-07          
CIVIL  
STATE OF CALIFORNIA

PLANS PREPARED BY:  
**HNTB**

HNTB Corporation  
200 E. SANDPOINT AVENUE, SUITE 200  
SANTA ANA, CALIFORNIA 92707  
TEL (714) 460-1600 FAX (714) 460-1610

DATE PLOTTED: dd-mm-yyyy hh:mm

FILE NAME: SDGN-FILE-NAMES