

BENT 2 & 3 PLAN

1/4" = 1'-0"

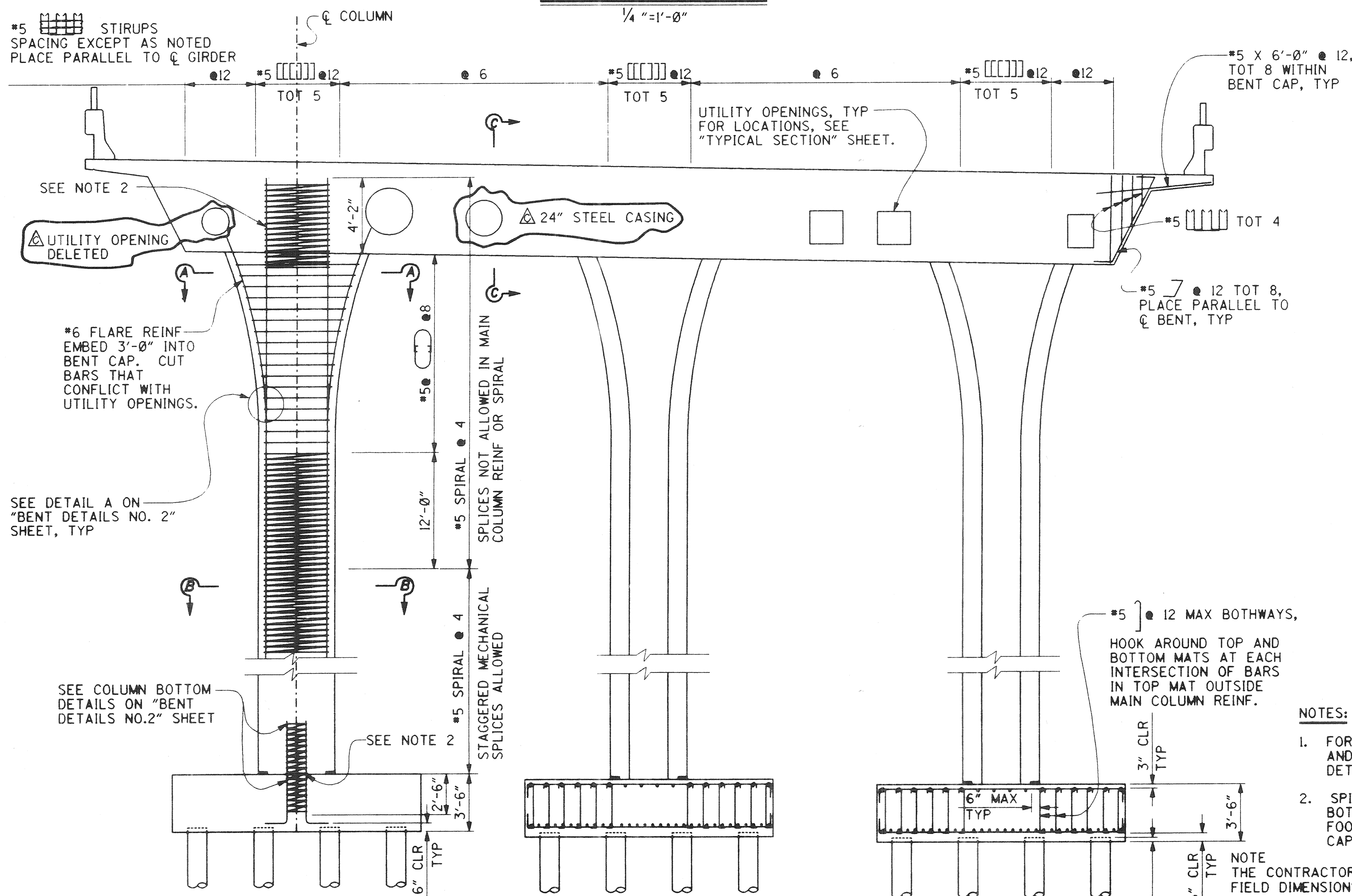

BENT 2 & 3 ELEVATION

1/4" = 1'-0"

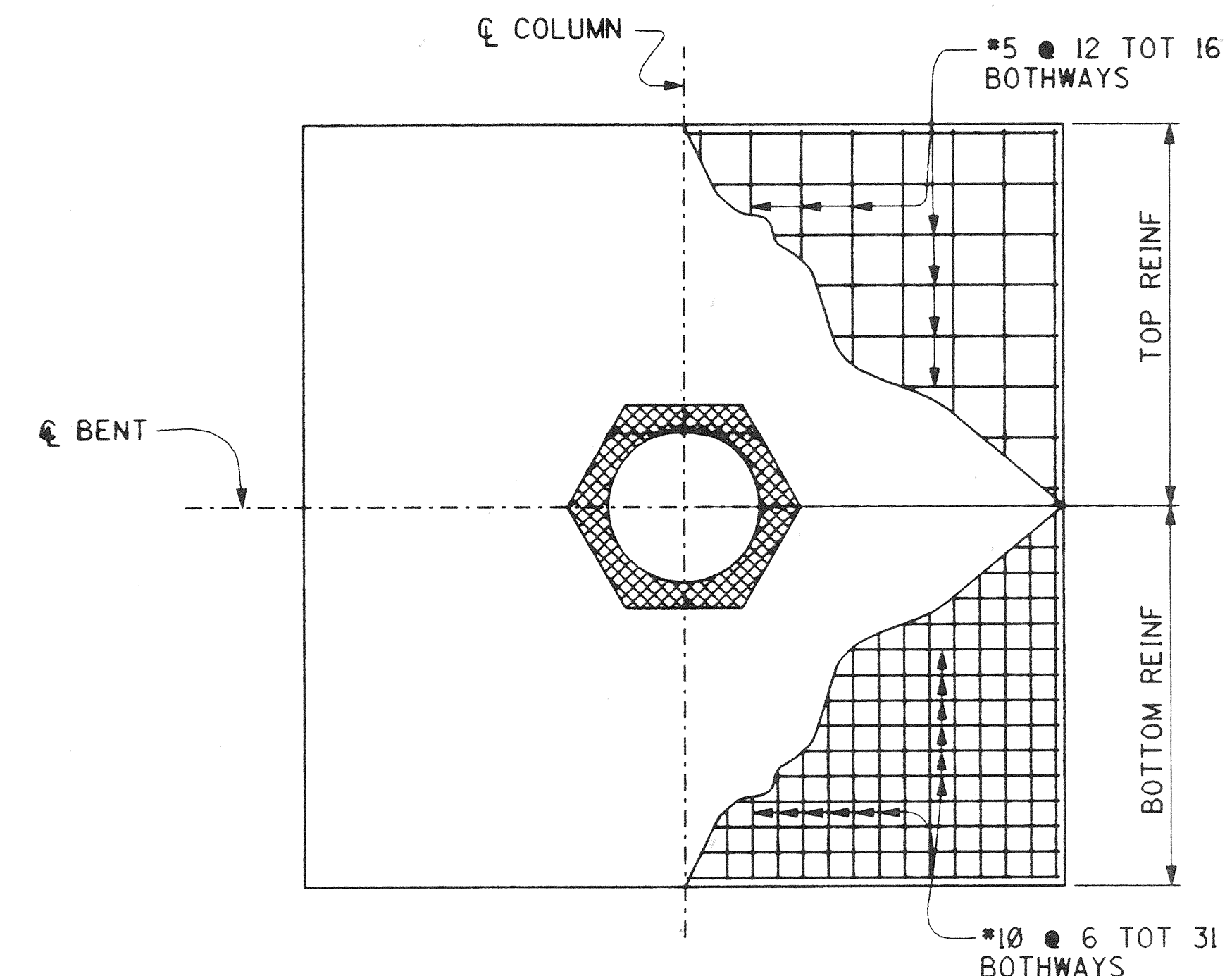

BENT 2 & 3 FOOTING REINFORCEMENT

3/8" = 1'-0"

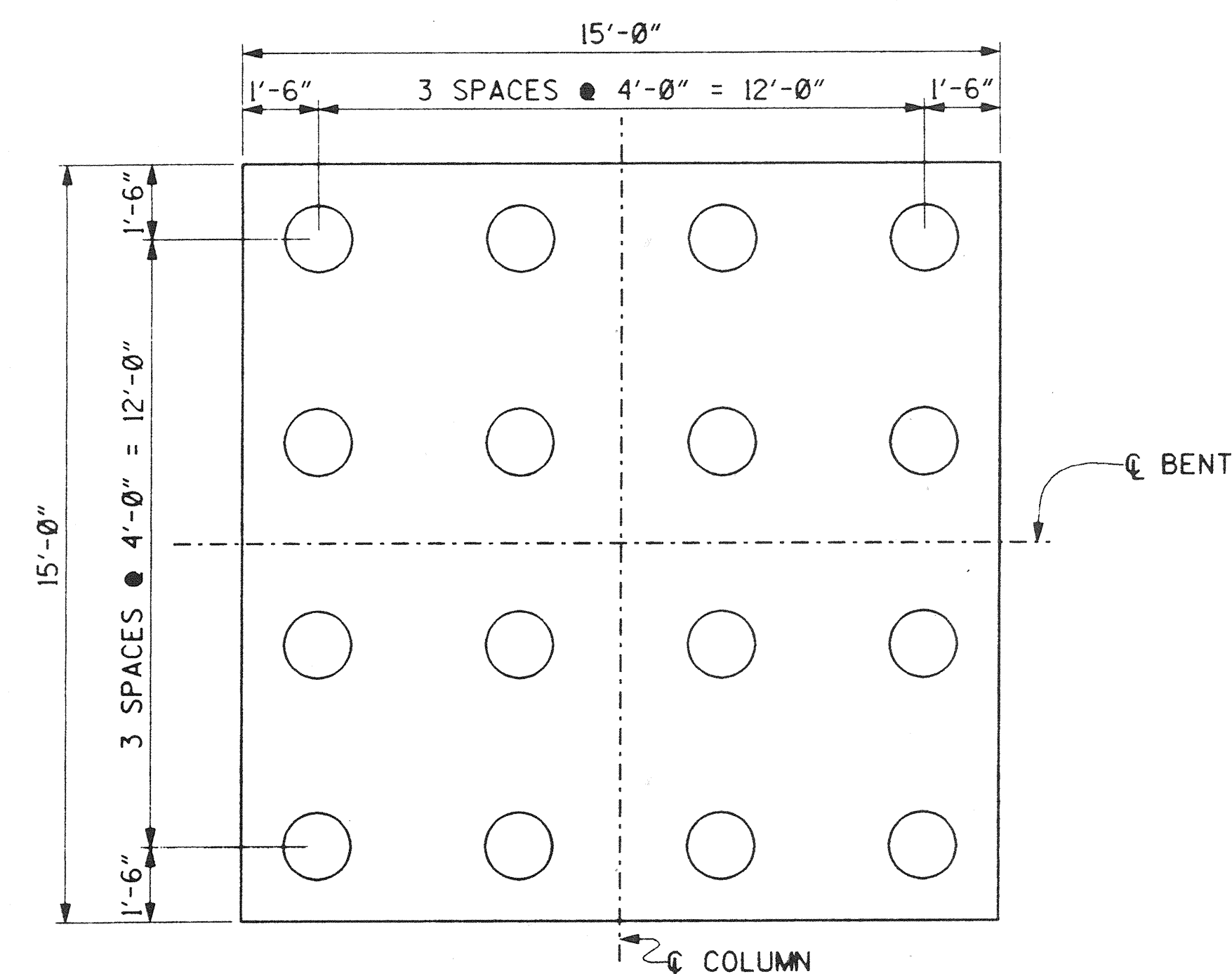

BENT 2 & 3 PILE LAYOUT

3/8" = 1'-0"

DR. 5 (16160)
Sheet 42 OF 64

NOTES:

1. FOR SECTIONS A-A, B-B, C-C, AND DETAILS NOT SHOWN SEE "BENT DETAILS NO.2 SHEET."
2. SPIRAL MAY BE DISCONTINUOUS AT BOTTOM OF BENT CAP OR TOP OF FOOTING TO ALLOW FOR PLACING CAP OR FOOTING REINFORCEMENT.

NOTE THE CONTRACTOR SHALL VERIFY ALL CONTROLLING FIELD DIMENSIONS BEFORE ORDERING OR FABRICATING ANY MATERIAL.

PLANS PREPARED BY:

HNTB

26 EXECUTIVE PARK
SUITE 200
IRVINE, CALIFORNIA 92614

RECORD DRAWING

DATE	DESCRIPTION
7/97	SMWD FACILITY MODIFIED

REVISIONS

NO.	DATE	BY	CHKD.	APP'D.
1				

3 inches on original drawing

ORANGE COUNTY
PUBLIC FACILITIES AND RESOURCES DEPT.
**ANTONIO PARKWAY
WILDLIFE
UNDERCROSSING**

BENT DETAILS NO. 1

DATE	8/29
SCALE	AS SHOWN
DATE	
DATE	

8/29

42

OF 64

DR 5 (16160)